

Venetian Blinds Product Manual

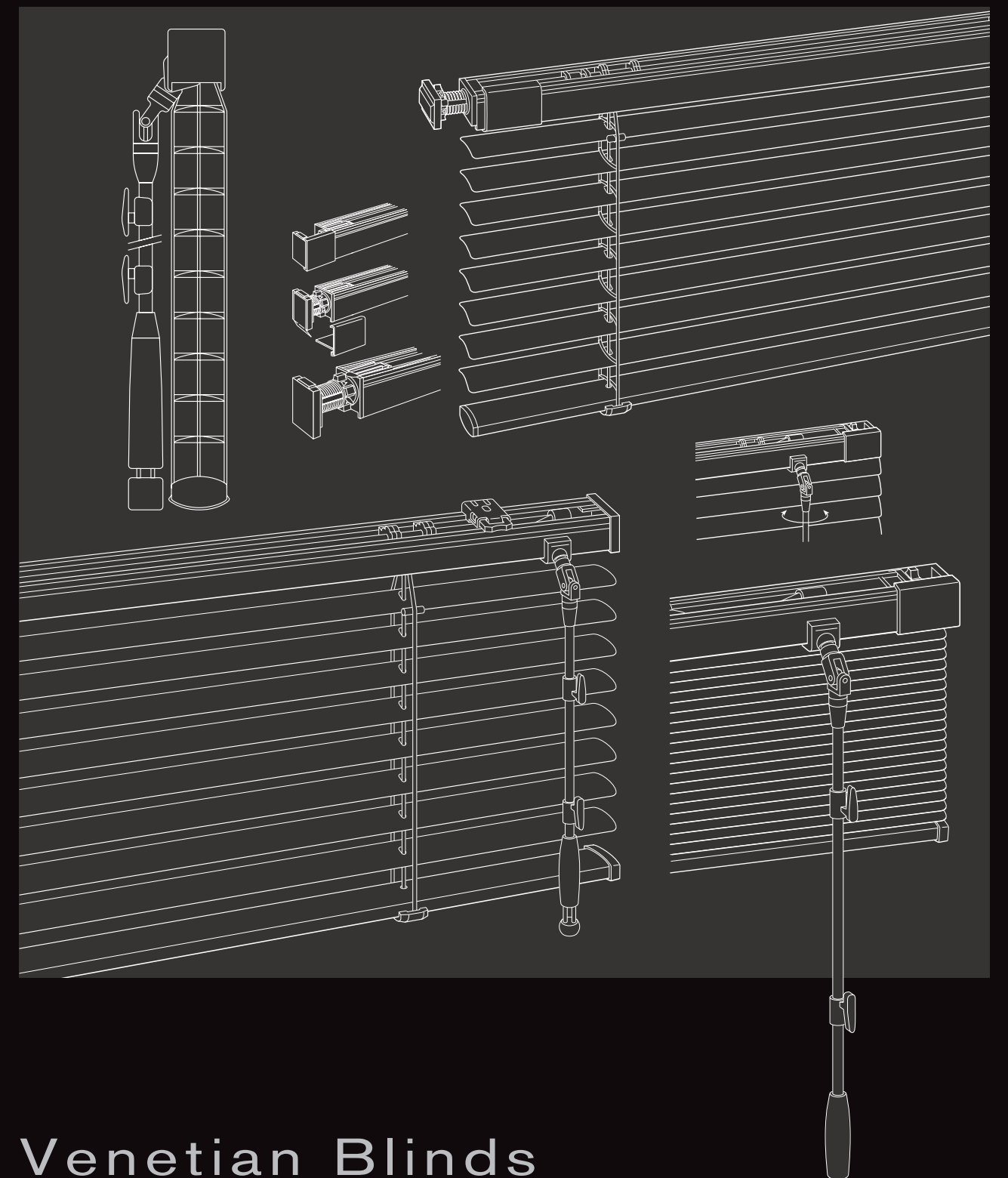

Venetian Blinds Product Manual

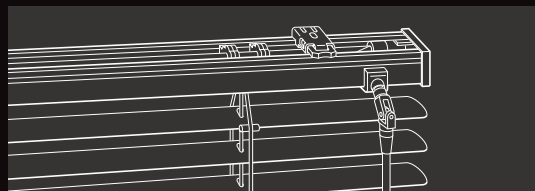
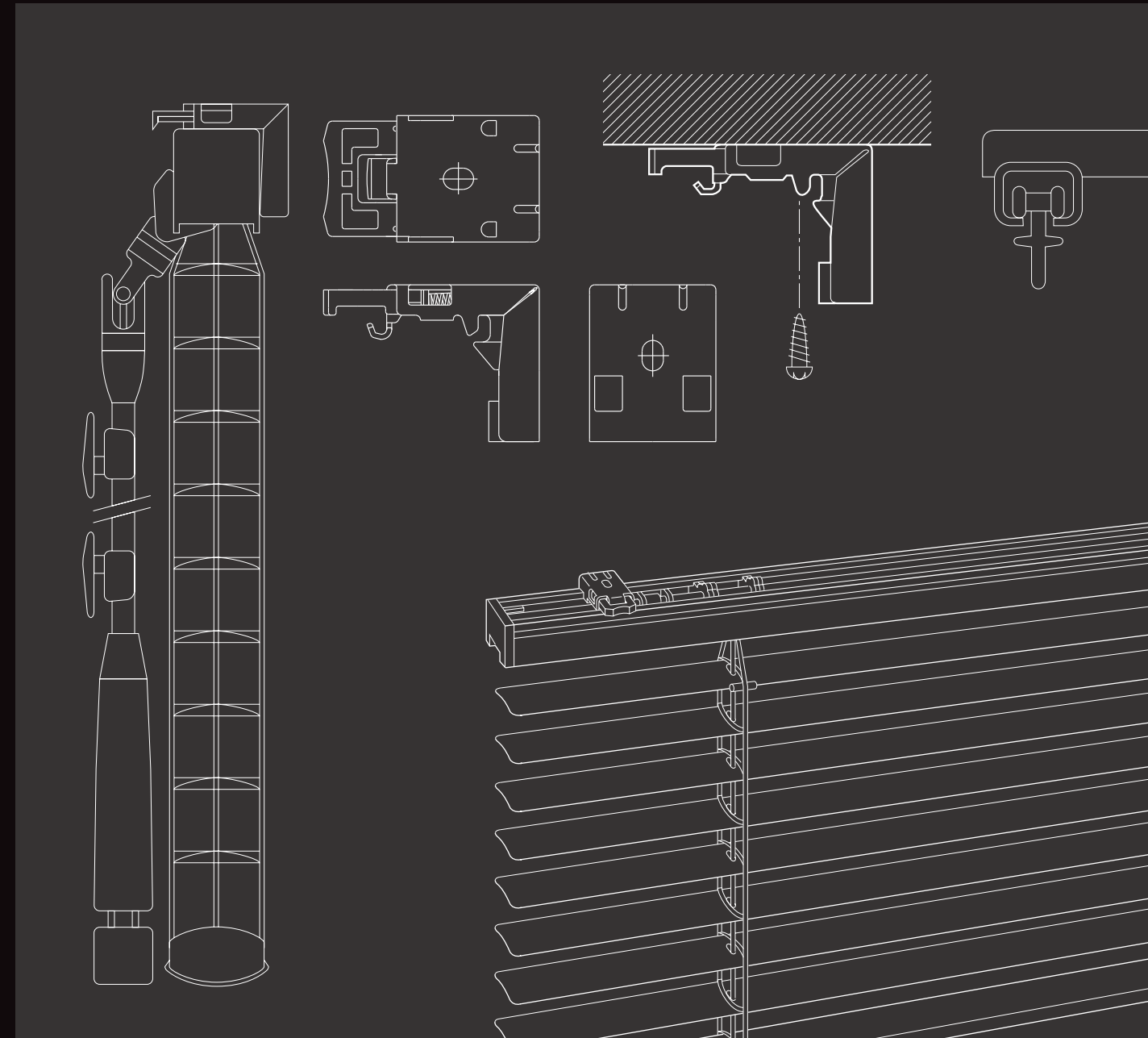

Venetian Blinds Product Manual

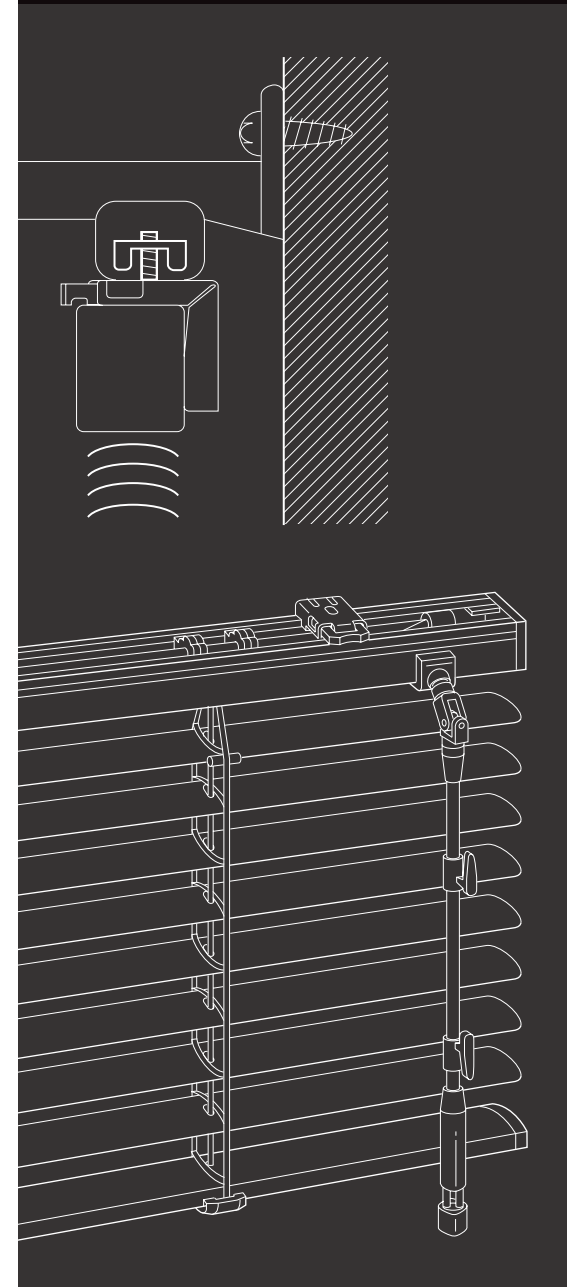

Contents

Product Line-up	P. 03
COLT BLIND 25 Series	P. 05
NEW CERAMY 25 Series	P. 08
How to Order	P. 17
Order Form	P. 18

Product Line-up

	Product Name	Slat Width	Operation Type		Notes	Available Colors	Reference
COLT BLIND	COLT BLIND 25	25 mm		For Ordinary Windows	Standard One Control Type	40 colors	page 05
	COLT BLIND 25 for bathroom	25 mm		For Kitchen and Bathroom	For a kitchen, a bathroom or any other where dew is condensed		
	COLT BLIND 25 Tension for bathroom	25 mm					
NEW CERAMY	NEW CERAMY 25	25 mm	One Control Type With a one-control wand, both tilting and raising/lowering are available.	For Ordinary Windows	Standard One Control Type	161 colors	page 09
	NEW CERAMY 15	15 mm					
	NEW CERAMY 25 for bathroom	25 mm			For a kitchen, a bathroom or any other where dew is condensed	158 colors	page 11
	NEW CERAMY 15 for bathroom	15 mm		For Kitchen and Bathroom			
	NEW CERAMY 25 Tension for bathroom	25 mm			For a window in a tile wall where screw fastening is useless	158 colors	page 13
	NEW CERAMY 15 Tension for bathroom	15 mm					
	NEW CERAMY 25 with Cable Guide	25 mm		For Windy Place	For a windy place or a high-rise apartment	25 colors	page 15



NEW CERAMY 25



COLT BLIND 25 for bathroom

Maintenance Sticker

- For preventive maintenance, a maintenance sticker attached to the underside of Bottom Rail.
(When the slat size is 15 mm, attached to the underside of Head Rail.)
Please refer to the sticker in case you need to contact us or repair the blind.
- With the bar code reader of your mobile phone, you can read a 2-dimensional bar code on the sticker and access our site to get the product information.
*Attention: you may not be able to read the bar code if the sticker gets dirty or damaged.

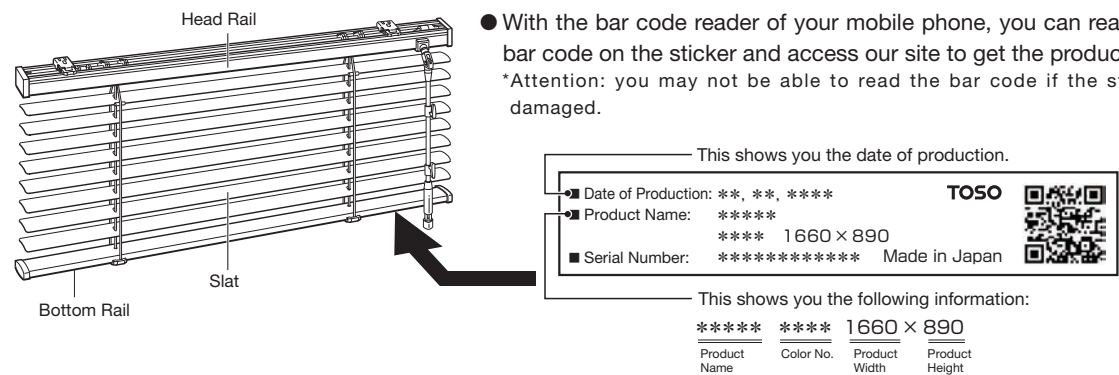

COLT BLIND 25 / COLT BLIND 25 for bathroom /

Product Overview

Structure Drawing

COLT BLIND 25

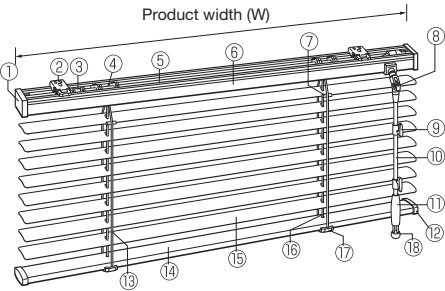

Components	Materials
① Head Cap	plastic molded
② Bracket	steel, plastic molded
③ Click	plastic molded
④ Tilter	plastic molded
⑤ Shaft	steel
⑥ Head Rail	steel
⑦ Slat Clip	plastic molded
⑧ Universal Joint	plastic molded
⑨ Cord Hook	plastic molded
⑩ One-control Pipe	aluminum alloy
⑪ Grip	plastic molded
⑫ Bottom Cap	plastic molded
⑬ Ladder Cord	synthetic fiber
⑭ Bottom Rail	steel
⑮ Slat	aluminum alloy
⑯ Lift Cord	synthetic fiber
⑰ Bottom Cover	plastic molded
⑱ Safety Tassel	plastic molded

COLT BLIND 25 for bathroom

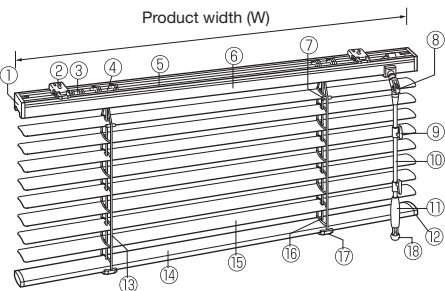

Components	Materials
① Head Cap	plastic molded
② Bracket	stainless steel, plastic molded
③ Click	plastic molded
④ Tilter	plastic molded
⑤ Shaft	steel
⑥ Head Rail	aluminum alloy
⑦ Slat Clip	plastic molded
⑧ Universal Joint	plastic molded
⑨ Cord Hook	plastic molded
⑩ One-control Pipe	aluminum alloy
⑪ Grip	plastic molded
⑫ Bottom Cap	plastic molded
⑬ Ladder Cord	synthetic fiber
⑭ Bottom Rail	aluminum alloy
⑮ Slat	aluminum alloy
⑯ Lift Cord	synthetic fiber
⑰ Bottom Cover	plastic molded
⑱ Safety Tassel	plastic molded

COLT BLIND 25 Tension for bathroom

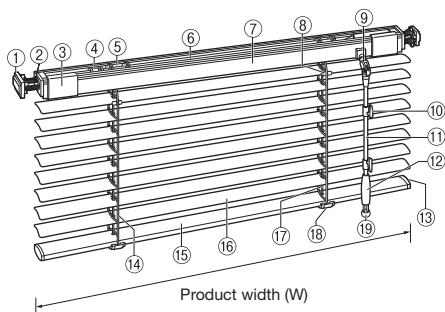

*When the product width is 470 mm or less, Tension Bracket is available only on one side.
*When the product width is 470 mm or less, Click mechanism is not built in.
*The product width is equal to the Slat one.
*Allowable width for fitting is the product (Slat) with plus 20 mm, at the maximum.

Components	Materials
① Support Plate	plastic molded
② Tension Braket	plastic molded
③ Side Bracket Cover	plastic molded
④ Click	plastic molded
⑤ Tilter	plastic molded
⑥ Shaft	stainless steel
⑦ Head Rail	aluminum alloy
⑧ Slat Clip	plastic molded
⑨ Universal Joint	plastic molded
⑩ Cord Hook	plastic molded
⑪ One-control Pipe	aluminum alloy
⑫ Grip	plastic molded
⑬ Bottom Cap	plastic molded
⑭ Ladder Cord	synthetic fiber
⑮ Bottom Rail	aluminum alloy
⑯ Slat	aluminum alloy
⑰ Lift Cord	synthetic fiber
⑱ Bottom Cover	plastic molded
⑲ Safety Tassel	plastic molded

Side View

COLT BLIND 25

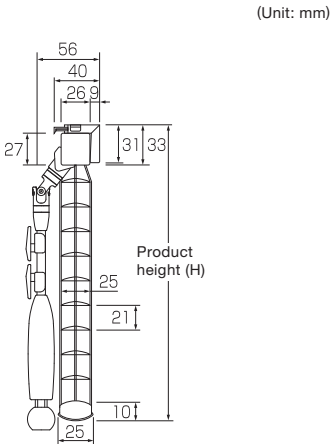

COLT BLIND 25 for bathroom

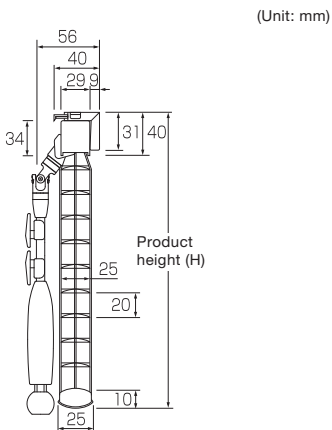

COLT BLIND 25 Tension for bathroom

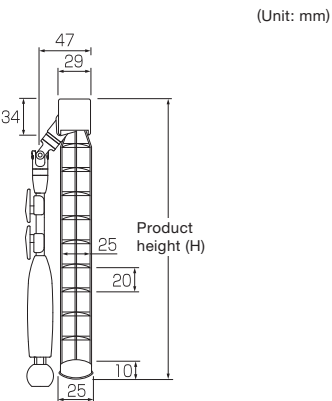

COLT BLIND 25 Tension for bathroom

Attachments

Bracket

(Use for COLT BLIND 25 and COLT BLIND 25 for bathroom)

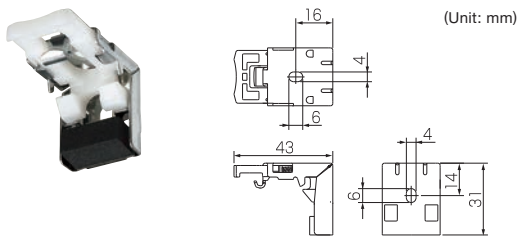

Cap Plate / 2 pieces

(Use for COLT BLIND 25 Tension for bathroom)

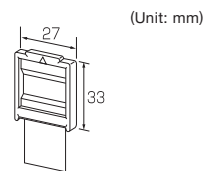

Part Color



White

Beige

Standard color diffes, depending on Slat colors.
See page 20 and 21 on Japanese catalog for details.

Allowable Size

Product Name	Product Width (W)	Product Height (H)	Maximum Area
COLT BLIND 25	280–3,000 mm	110–5,000 mm	7 m ²
COLT BLIND 25 for bathroom			
COLT BLIND 25 Tension for bathroom	280–1,800 mm	110–1,900 mm	—

*For COLT BLIND 25 Tension for bathroom, when the product width is 470 mm or less, Tension Bracket is available only on one side.
*For ordering, round down the nearest 10 mm both in width and in height.

Stack-up Guide (mm)

COLT BLIND 25	Product height (H) × 0.025 + 50
COLT BLIND 25 for bathroom	Product height (H) × 0.030 + 50
COLT BLIND 25 Tension for bathroom	

Product Weight Guide

COLT BLIND 25	Product width 1,000 mm × Product height 1,000 mm: 1.3 kg Product width 2,000 mm × Product height 2,000 mm: 3.7 kg
COLT BLIND 25 for bathroom	Product width 1,000 mm × Product height 1,000 mm: 1.5 kg Product width 2,000 mm × Product height 2,000 mm: 4.1 kg
COLT BLIND 25 Tension for bathroom	Product width 1,000 mm × Product height 1,000 mm: 1.5 kg Product width 2,000 mm × Product height 2,000 mm: 3.7 kg

One-control Wand Length

Headrail-to-floor Height (a)	Product Height (H)	One-control Wand Length
—1,590 mm	— mm	320 mm
1,600–1,990 mm	—1,590 mm	480 mm
2,000–2,190 mm	—1,990 mm	680 mm
2,200–2,390 mm	—2,190 mm	880 mm
2,400–2,590 mm	—2,390 mm	1,000 mm
2,600–2,790 mm	—2,590 mm	1,280 mm
2,800–3,000 mm	—2,790 mm	1,480 mm
3,010–3,200 mm	—3,000 mm	1,680 mm
3,210–3,400 mm	—3,400 mm	1,890 mm
3,410–3,670 mm	—3,670 mm	2,280 mm
3,680–3,870 mm	—3,870 mm	2,480 mm
3,880–4,070 mm	—4,070 mm	2,680 mm
4,080–4,270 mm	—4,270 mm	2,880 mm
4,280–4,470 mm	—4,470 mm	3,080 mm
4,480–4,670 mm	—4,670 mm	3,280 mm
4,680–4,870 mm	—4,870 mm	3,480 mm
4,880–5,000 mm	—5,000 mm	3,690 mm

*When the one-control wand length is 1,480 mm or over, the wand has a joint.

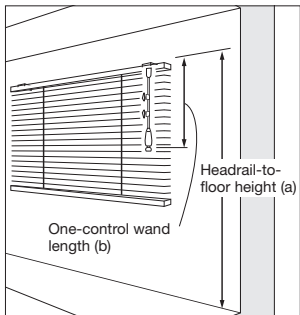

(a): From the top of the Bracket to the floor (headrail-to-floor height).
(b): From the top of the Bracket to the bottom of the one-control wand Grip.

Installation Method

COLT BLIND 25 / COLT BLIND 25 for bathroom

1. Bracket installation

- ① Install the Bracket in a position 30-60 mm inward from each end of the Head Rail. If three or more Brackets are required, install the Bracket in between at equal intervals.

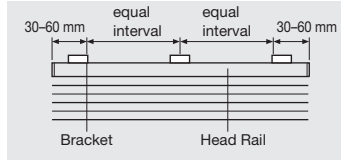

- ② Fit the Bracket with accompanying screws.

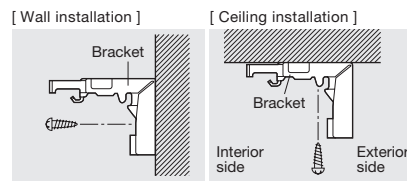

2. Installing the main unit

- ① With the Slats stacked-up, hang the front groove of the Head Rail on the temporal hook of each Bracket.
- ② Push up until it securely clicks in.

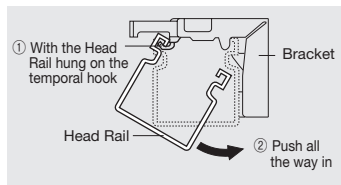

3. Removing the main unit

- ① With the Slats stacked-up, pull the Head Rail toward you while pressing the Bracket release button.
- ② Remove the main unit from the temporal hook.

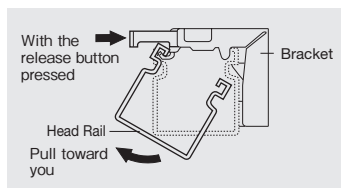

When fitting a Venetian Blind on a Curtain Track

Use the Curtain Track Fitting (option).

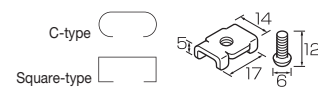

*With this fitting, a venetian blind fits on a metal track such as a C-type track and a square-type track.

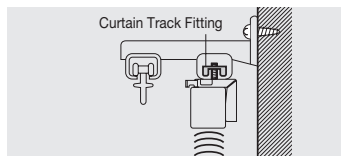
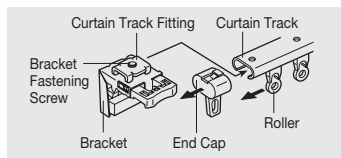

Installation Method

- ① Remove End Caps and Rollers from the curtain track.
- ② Hang the Curtain Track Fitting (option) temporarily on the Brackets.
- ③ Slide them in the curtain track and then fix.

COLT BLIND 25 Tension for bathroom

1. Installing the main unit

- ① Remove stains, oil or water-drops on a mounting surface to install and dry excess moisture.
- ② Peel off the release paper of the double-sided tape on the Cap Plate and fit the Cap Plate evenly with the △ mark facing up.
- ③ While pushing the Support Plate, not on the operational side, into the Cap Plate, push the Support Plate on the operational side into the other Cap Plate for temporal fixing.
- ④ Rotate the dial on the operational side in the direction of arrow and adjust the gaps equally on both sides.

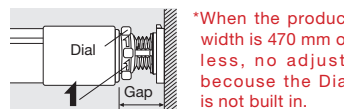
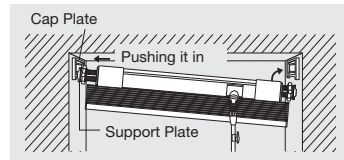
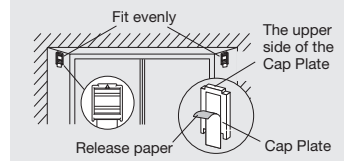

- ⑤ Rotate the dial opposite to the operational side in the direction of arrow until it is tightly fastened so that the product is securely fixed.



*As shown in the below, rotate the dial until the projection located at the foot of the dial becomes invisible.

- ⑥ Pull the upper side of the Side Bracket Cover toward you to remove it from the Head Rail.

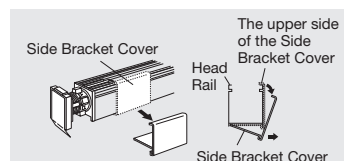

- ⑦ Fold the double-sided tape toward the blind and put the Side Bracket Cover on the Head Rail to cover the Support Plate and the Tension Cover.

*To fit the Bracket Cover, put on the upper side of the cover, pressing the lower part against the projection on the bottom of the Head Rail.

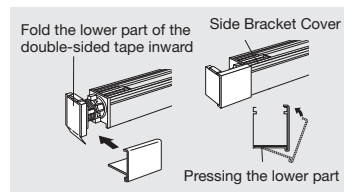

2. Removing the main unit

- ① Pull the upper side of the Side Bracket Cover toward you to remove it from the Head Rail.
- ② Stack up Slats.
- ③ Rotate each dial of both sides in the opposite direction of arrow to loosen.
- ④ While pushing the blind toward the non operational side, remove the Support Plate from the Cap Plate on the operational side.
- ⑤ While grasping the Cap Plate with one hand, pull down the double-sided tape just downwards to peel it off.

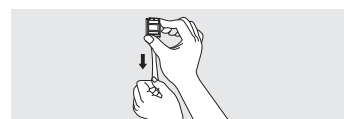
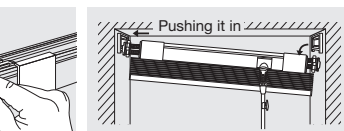
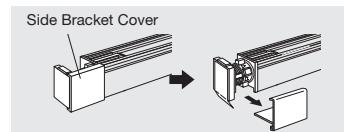

Operation Method (One Control Type)

Lowering the blind

With the Lift Cords in your hand, loosen the Cords by pulling down the Grip slightly to lower the blind.

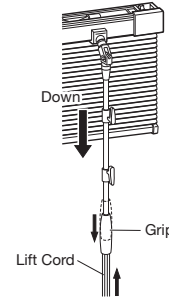

Lifting the blind

With the Slats set horizontal, pull down the Lift Cords to raise the blind.

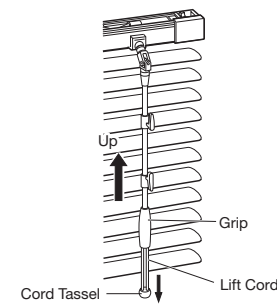

Stopping the blind

Release your hand from the Grip and the blind will stop at that point.

Adjusting a Slat angle

Twist the Grip for tilting.

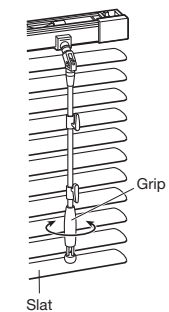

Click mechanism

When the Slats reach the top, the click mechanism will act with a "click" sound to keep them from returning. (It activates both on the room side and the window side.)

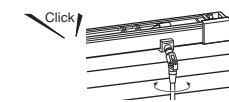

How to use the Cord Hook

Put the Lift Cords on the Cord Hook when the Slats stacked-up.

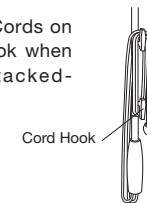

How to Take Measurements

*For the product size, specify to round down the nearest 10 mm.

Ceiling mount inside the window frame

Ceiling installation

Subtract approx. 10 mm from both the actual inner width and height of the window.

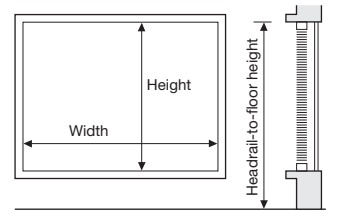

Outside mount covering the window frame

Wall installation

Specify the actual outside sizes, both width and height, for finished dimensions.

*COLT BLIND 25 Tension for bathroom can not the wall attachment.

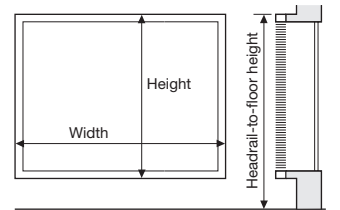

In case fitting the blind inside the curtain box (the Blind Box)

Subtract approx. 10 mm from the box inside width. Measure the height from the top of the box inside.

*Please note that the product height might have a certain margin of error. *Be sure to specify the height from the top of the Bracket to the floor (head-rail-to-floor height). Please note that the one-control wand length may be short unless specified.

NEW CERAMY 25

Product Overview

Structure Drawing

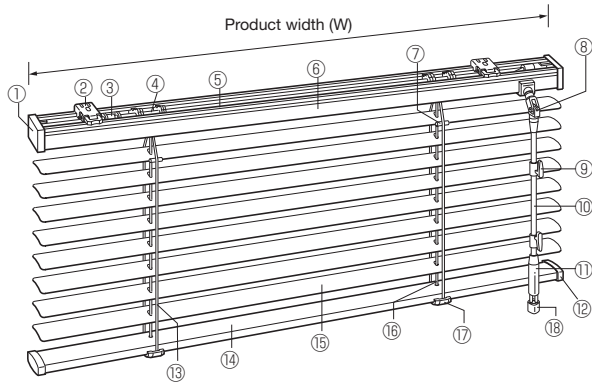

Components	Materials
① Head Cap	plastic molded
② Bracket	steel, plastic molded
③ Click	plastic molded
④ Tilter	plastic molded
⑤ Shaft	steel
⑥ Head Rail	steel
⑦ Slat Clip	plastic molded
⑧ Universal Joint	plastic molded
⑨ Cord Hook	plastic molded
⑩ One-control Pipe	aluminum alloy
⑪ Grip	plastic molded
⑫ Bottom Cap	plastic molded
⑬ Ladder Cord	synthetic fiber
⑭ Bottom Rail	steel
⑮ Slat	aluminum alloy
⑯ Lift Cord	synthetic fiber
⑰ Bottom Cover	plastic molded
⑱ Safety Tassel	plastic molded

Side View

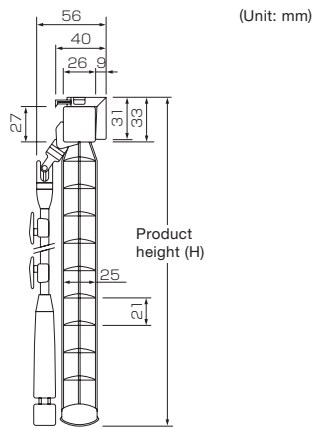

Allowable Size

Product Width (W)	Product Height (H)	Maximum Area
280–3,000 mm	110–5,000 mm	7 m ²

*For ordering, round down the nearest 10 mm both in width and in height.

Stack-up Guide (mm)

Product height (H) × 0.025 + 50

Product Weight Guide

Product width 1,000 mm × Product height 1,000 mm: 1.3 kg
Product width 2,000 mm × Product height 2,000 mm: 3.7 kg

Attachments

Bracket

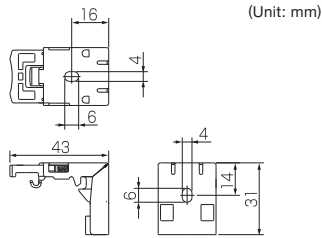

Product Width (mm)	Parts
–1,280	2
1,290–2,180	3
2,190–	4

Installation Method

1. Bracket installation

①Install the Bracket in a position 30-60 mm inward from each end of the Head Rail. If three or more Brackets are required, install the Bracket in between at equal intervals.

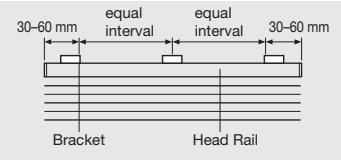

②Fit the Bracket with accompanying screws.

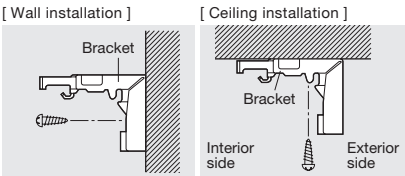

2. Installing the main unit

①With the Slats stacked-up, hang the front groove of the Head Rail on the temporal hook of each Bracket.
②Push up until it securely clicks in.

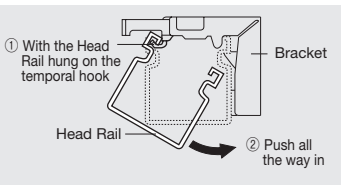

3. Removing the main unit

①With the Slats stacked-up, pull the Head Rail toward you while pressing the Bracket release button.
②Remove the main unit from the temporal hook.

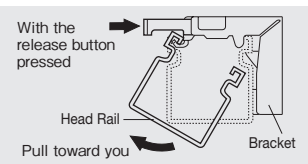

When fitting a Venetian Blind on a Curtain Track

Use the Curtain Track Fitting (option).

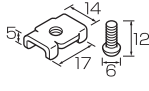

*With this fitting, a venetian blind fits on a metal track such as a C-type track and a square-type track.

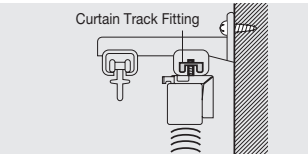
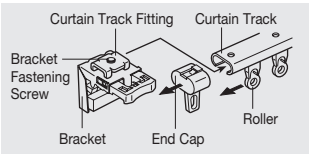

Installation Method
①Remove End Caps and Rollers from the curtain track.
②Hang the Curtain Track Fitting (option) temporarily on the Brackets.
③Slide them in the curtain track and then fix.

Operation Method (One Control Type)

Lowering the blind

With the Lift Cords in your hand, loosen the Cords by pulling down the Grip slightly to lower the blind.

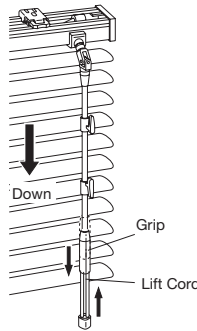

Lifting the blind

With the Slats set horizontal, pull down the Lift Cords to raise the blind.

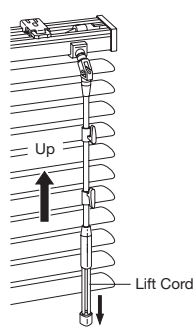

Stopping the blind

Release your hand from the Grip and the blind will stop at that point.

Adjusting a Slat angle

Twist the Grip for tilting.

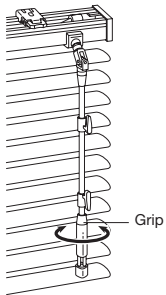

Click mechanism

When the Slats reach the top, the click mechanism will act with a "click" sound to keep them from returning. (It activates both on the room side and the window side.)

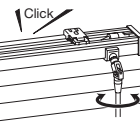

How to use the Cord Hook

Put the Lift Cords on the Cord Hook when the Slats stacked-up.

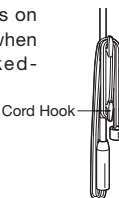

How to Take Measurements

*For the product size, specify to round down the nearest 10 mm.

Ceiling mount inside the window frame

Ceiling installation

Subtract approx. 10 mm from both the actual inner width and height of the window.

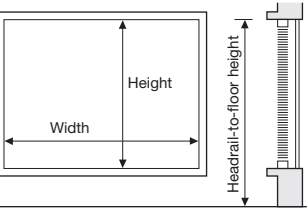

Outside mount covering the window frame

Wall installation

Specify the actual outside sizes, both width and height, for finished dimensions.

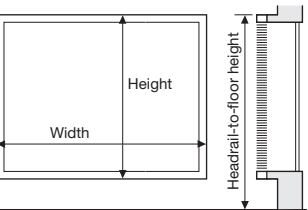

In case fitting the blind inside the curtain box (the Blind Box)

Subtract approx. 10 mm from the box inside width. Measure the height from the top of the box inside.

*Please note that the product height might have a certain margin of error.
*Be sure to specify the height from the top of the Bracket to the floor (head-rail-to-floor height).
Please note that the one-control wand length may be short unless specified.

NEW CERAMY 25 for bathroom

Product Overview

Structure Drawing

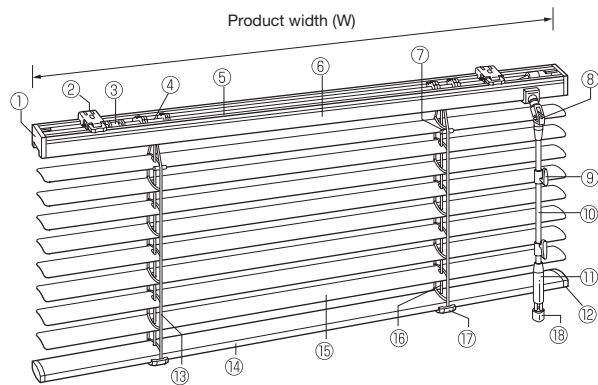

Components	Materials
① Head Cap	plastic molded
② Bracket	stainless steel, plastic molded
③ Click	plastic molded
④ Tilter	plastic molded
⑤ Shaft	stainless steel
⑥ Head Rail	aluminum alloy
⑦ Slat Clip	plastic molded
⑧ Universal Joint	plastic molded
⑨ Cord Hook	plastic molded
⑩ One-control Pipe	aluminum alloy
⑪ Grip	plastic molded
⑫ Bottom Cap	plastic molded
⑬ Ladder Cord	synthetic fiber
⑭ Bottom Rail	aluminum alloy
⑮ Slat	aluminum alloy
⑯ Lift Cord	synthetic fiber
⑰ Bottom Cover	plastic molded
⑱ Safety Tassel	plastic molded

Side View

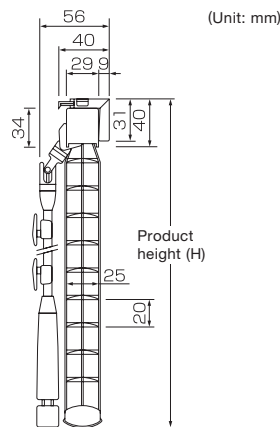

Attachments

Bracket

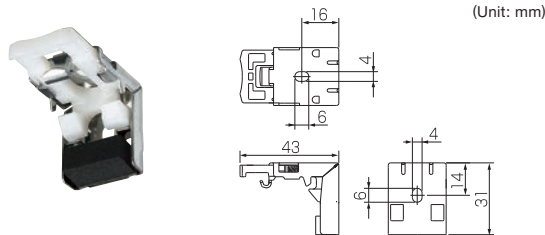

Product Width (mm)	-1,280	1,290-2,180	2,190-
Parts			
Bracket	2	3	4

Allowable Size

Product Width (W)	Product Height (H)	Maximum Area
280-3,000 mm	110-5,000 mm	7 m ²

*For ordering, round down the nearest 10 mm both in width and in height.

Stack-up Guide (mm)

Product height (H) × 0.030 + 50

Product Weight Guide

Product width 1,000 mm × Product height 1,000 mm: 1.5 kg
Product width 2,000 mm × Product height 2,000 mm: 4.1 kg

Installation Method

1. Bracket installation

①Install the Bracket in a position 30-60 mm inward from each end of the Head Rail. If three or more Brackets are required, install the Bracket in between at equal intervals.

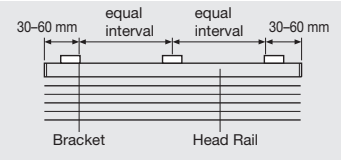

②Fit the Bracket with accompanying screws.

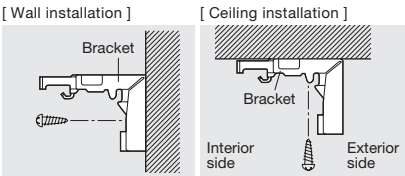

2. Installing the main unit

①With the Slats stacked-up, hang the front groove of the Head Rail on the temporal hook of each Bracket.
②Push up until it securely clicks in.

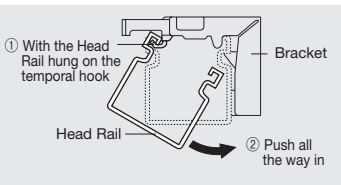

3. Removing the main unit

①With the Slats stacked-up, pull the Head Rail toward you while pressing the Bracket release button.
②Remove the main unit from the temporal hook.

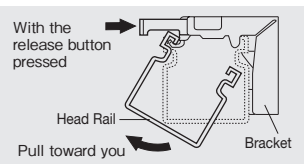

When fitting a Venetian Blind on a Curtain Track

Use the Curtain Track Fitting (option).

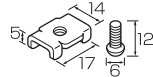

*With this fitting, a venetian blind fits on a metal track such as a C-type track and a square-type track.

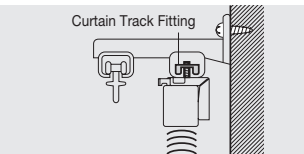
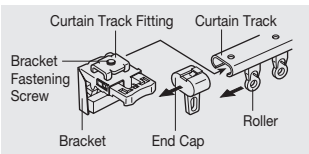

- Installation Method**
- ①Remove End Caps and Rollers from the curtain track.
 - ②Hang the Curtain Track Fitting (option) temporarily on the Brackets.
 - ③Slide them in the curtain track and then fix.

Operation Method (One Control Type)

Lowering the blind

With the Lift Cords in your hand, loosen the Cords by pulling down the Grip slightly to lower the blind.

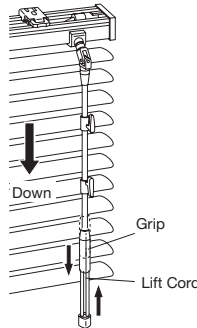

Lifting the blind

With the Slats set horizontal, pull down the Lift Cords to raise the blind.

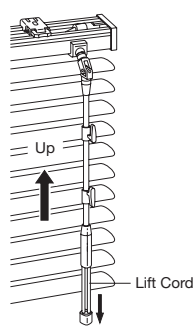

Stopping the blind

Release your hand from the Grip and the blind will stop at that point.

Adjusting a Slat angle

Twist the Grip for tilting.

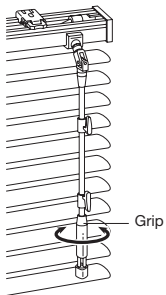

Click mechanism

When the Slats reach the top, the click mechanism will act with a "click" sound to keep them from returning. (It activates both on the room side and the window side.)

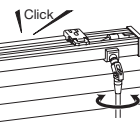

How to use the Cord Hook

Put the Lift Cords on the Cord Hook when the Slats stacked-up.

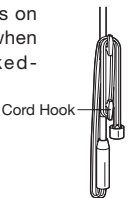

How to Take Measurements

*For the product size, specify to round down the nearest 10 mm.

Ceiling mount inside the window frame

Ceiling installation

Subtract approx. 10 mm from both the actual inner width and height of the window.

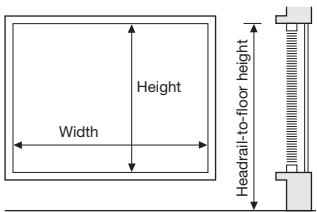

Outside mount covering the window frame

Wall installation

Specify the actual outside sizes, both width and height, for finished dimensions.

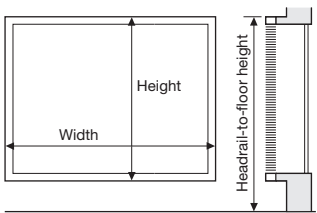

In case fitting the blind inside the curtain box (the Blind Box)

Subtract approx. 10 mm from the box inside width. Measure the height from the top of the box inside.

*Please note that the product height might have a certain margin of error.
*Be sure to specify the height from the top of the Bracket to the floor (head-rail-to-floor height).
Please note that the one-control wand length may be short unless specified.

NEW CERAMY 25 Tension for bathroom

Product Overview

Structure Drawing

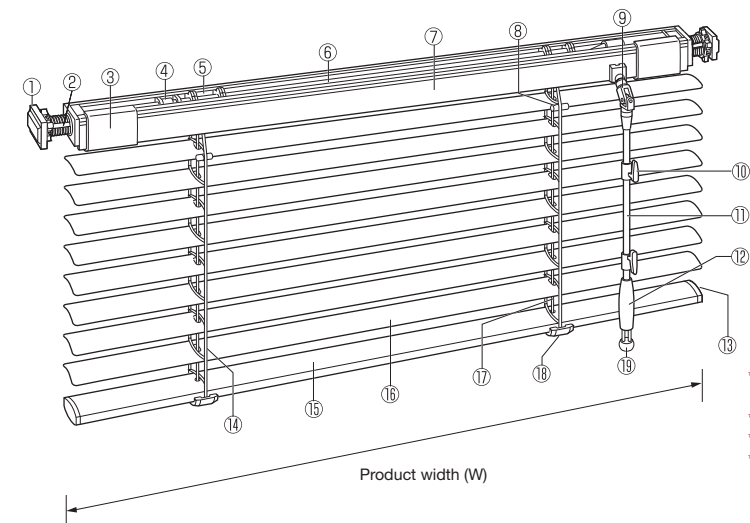

*When the product width is 470 mm or less, Tension Bracket is available only on one side.
*When the product width is 470 mm or less, click mechanism is not built in.
*The product width is equal to the Slat one.
*Allowable width for fitting is the product (Slat) with plus 20 mm, at the maximum.

Components	Materials
① Support Plate	plastic molded
② Tension Bracket	plastic molded
③ Side Bracket Cover	plastic molded
④ Click	plastic molded
⑤ Tilter	plastic molded
⑥ Shaft	stainless steel
⑦ Head Rail	aluminum alloy
⑧ Slat Clip	plastic molded
⑨ Universal Joint	plastic molded
⑩ Cord Hook	plastic molded
⑪ One-control Pipe	aluminum alloy
⑫ Grip	plastic molded
⑬ Bottom Cap	plastic molded
⑭ Ladder Cord	synthetic fiber
⑮ Bottom Rail	aluminum alloy
⑯ Slat	aluminum alloy
⑰ Lift Cord	synthetic fiber
⑱ Bottom Cover	plastic molded
⑲ Safety Tassel	plastic molded

Allowable Size

Product Width (W)	Product Height (H)
280–1,800 mm	110–1,900 mm

*For ordering, round down the nearest 10 mm both in width and in height.
*When the product width is 470 mm or less, Tension Bracket is available only on one side.

Stack-up Guide (mm)

Product height (H) × 0.030 + 50

Product Weight Guide

Product width 1,000 mm × Product height 1,000 mm: 1.5 kg
Product width 2,000 mm × Product height 2,000 mm: 3.7 kg

Side View

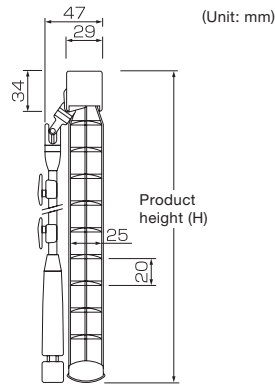

Attachments

Cap Plate / 2 pieces

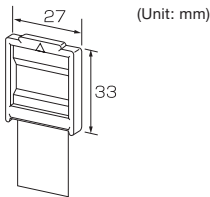

How to Take Measurements

*For the product size, specify to round down the nearest 10 mm.

Subtract approx. 10 mm from both the actual inner width and height of the window.

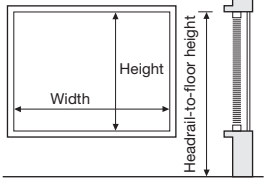

*Please note that the product height might have a certain margin of error.
*Be sure to specify the height from the top of the Bracket to the floor (head-rail-to-floor height).
Please note that the one-control wand length may be short unless specified.

Installation Method

Caution

- Do not use this for walls with rough surface such as textured wallpaper, mud wall, sand wall, cloth wall.
- Install on the surface that has solid framework underneath; e.g. wood, tile. If not, due to its weakness, the bar does not give enough tension to support, which may cause a fall. If installed in a fabricated bathroom with a hollow structure, strong tension may damage PVC sash. Do not use for such a place.
- Before installation, remove stains, oil or waterdrops on the wall and dry excess moisture. The remaining stains and waterdrops will reduce the adhesive power of double-sided tape, which may cause a fall.
- When installing on tiles, avoid attaching the Cap Plate to the joint between the tiles. If placed on the joint, the double-sided tape may come off, which could result in a fall.
- Be sure to fit the Cap Plate evenly. If not installed evenly, the product may have a risk of a fall.

1. Installing the main unit

- Remove stains, oil or waterdrops on a mounting surface to install and dry excess moisture.

- Peel off the release paper of the double-sided tape on the Cap Plate and fit the Cap Plate evenly with the \triangle mark facing up.

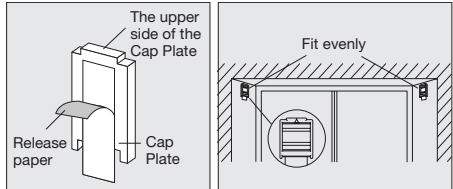

Caution

- Press the Cap Plate hard on the mounting surface (more than 5 seconds) to stick it firmly.
- Never peel the transparent seal off the edge of the double-sided tape. It is necessary when removing.

- While pushing the Support Plate, not on the operational side, into the Cap Plate, push the Support Plate on the operational side into the other Cap Plate for temporal fixing.

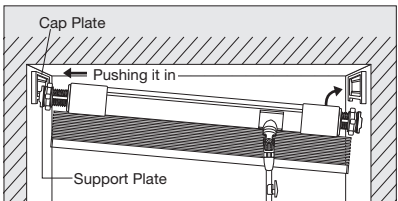

Caution

- Do this job while holding the product securely.
- Do not apply too much force to the product, such as operating the blind, which may cause a fall.

- Rotate the dial on the operational side in the direction of arrow and adjust the gaps equally on both sides.

*When the product width is 470 mm or less, no adjust, because the Dial is not built in.

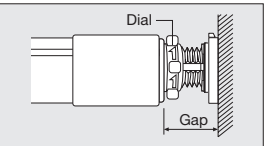

- Rotate the dial opposite to the operational side in the direction of arrow until it is tightly fastened so that the product is securely fixed.

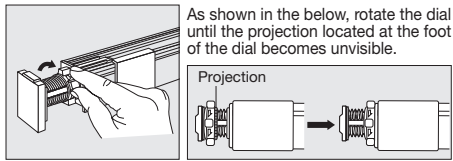

- Pull the upper side of the Side Bracket Cover toward you to remove it from the Head Rail.

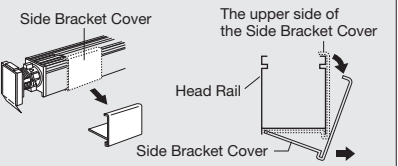

- Fold the double-sided tape toward the blind and put the Side Bracket Cover on the Head Rail to cover the Support Plate and the Tension Cover.

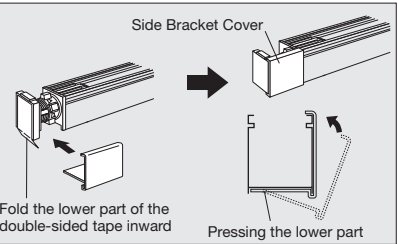

- To fit the Bracket Cover, put on the upper side of the cover, pressing the lower part against the projection on the bottom of the Head Rail.

Caution

- Never peel the transparent seal off the edge of the double-sided tape. It is necessary when removing.
- Do not cut the part of the double-sided tape that is sticking out from the Cap Plate; push it inside the Bracket Cover. It is necessary when removing.
- After installing the main unit, be sure to see that the Support Plate is securely fixed and that the dial is tightly fastened. If not fastened, the product may have a risk of a fall.
- Conduct a periodic checkup to make sure if the dial becomes loose.

2. Removing the main unit

- Pull the upper side of the Side Bracket Cover toward you to remove it from the Head Rail.
- Stack up Slats.
- Rotate each dial of both sides in the opposite direction of arrow to loosen.

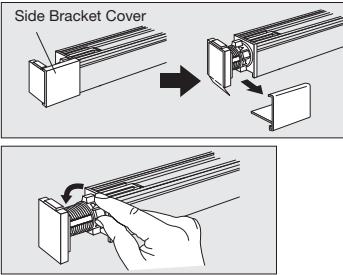

Caution

- When loosening the dial of the Tension Bracket, be sure to support the product with your hand.
- When loosening the dial of the Tension Bracket, do not apply too much force to the product, such as operating the blind, which may cause a fall.

- While pushing the blind toward the non operational side, remove the Support Plate from the Cap Plate on the operational side.

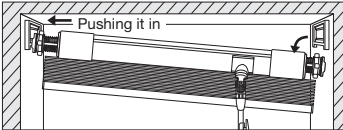

- While grasping the Cap Plate with one hand, pull down the double-sided tape just downwards to peel it off.

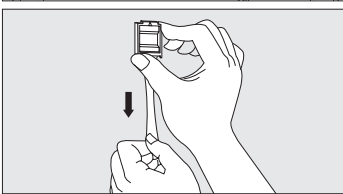

Caution

- If not grasping it, the Cap Plate may bounce, which can cause an injury.
- Be sure to pull down the double-sided tape. Tape is peeled off so as to extend (Extends approx. 30 cm.)
- Peel it off slowly little by little.
- Do not reuse the peeled-off double-sided tape.
- When removing the Cap Plate, pull in parallel the double-sided tape to the mounting surface. If pulling down in the other direction, the tape may damage the mounting surface or the tape itself be torn.
- Peel it off slowly little by little. If peeling it off violently, the tape may damage the mounting surface or the tape itself be torn.
- When peeling off the double-sided tape, some wallpapers may also be peeled off.

Operation Method (One-control Type)

Lowering the blind

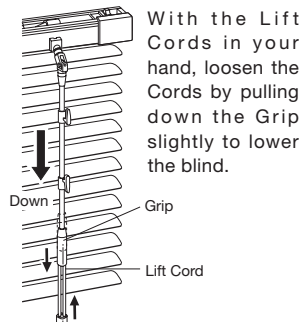

Lifting the blind

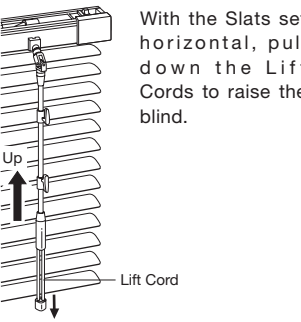

Stopping the blind

Release your hand from the Grip and the blind will stop at that point.

Adjusting a Slat angle

Twist the Grip for tilting.

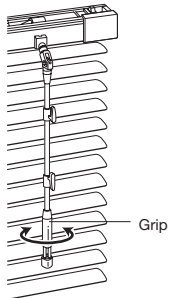

Click mechanism

When the Slats reach the top, the click mechanism will act with a "click" sound to keep them from returning. (It activates both on the room side and the window side.)

*When the product width is 470 mm or less, click mechanism is not built in.

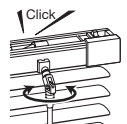

How to use the Cord Hook

Put the Lift Cords on the Cord Hook when the Slats stacked-up.

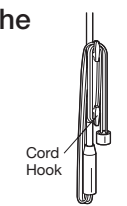

NEW CERAMY 25 with Cable Guide

Product Overview

Structure Drawing

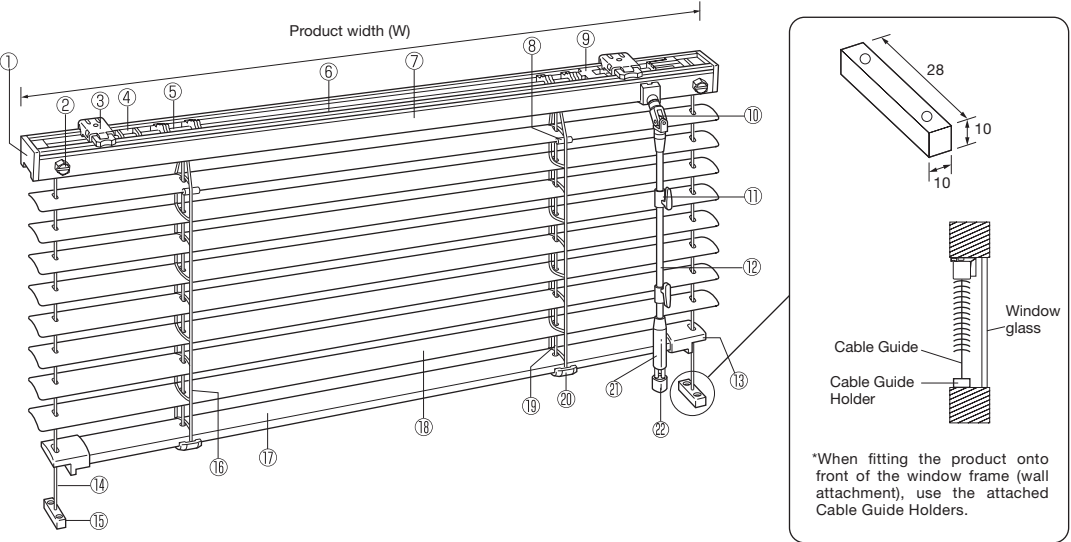

Side View

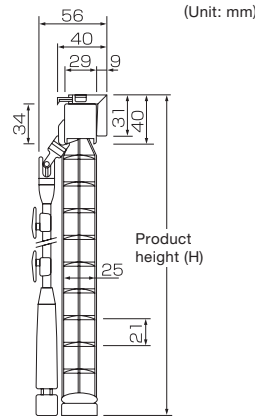

Components	Materials
① Head Cap	plastic molded
② Winding Reel	stainless steel
③ Bracket	stainless steel, plastic molded
④ Click	plastic molded
⑤ Tilter	plastic molded
⑥ Shaft	stainless steel
⑦ Head Rail	aluminum alloy
⑧ Slat Clip	plastic molded
⑨ Clutch Box	plastic molded
⑩ Universal Joint	plastic molded
⑪ Cord Hook	plastic molded
⑫ One-control Pipe	aluminum alloy
⑬ Bottom Cap	plastic molded
⑭ Cable Guide	plastic molded
⑮ Cable Guide Holder	plastic molded
⑯ Ladder Cord	synthetic fiber
⑰ Bottom Rail	aluminum alloy
⑱ Slat	aluminum alloy
⑲ Lift Cord	synthetic fiber
⑳ Bottom Cover	plastic molded
㉑ Grip	plastic molded
㉒ Safety Tassel	plastic molded

Allowable Size

Product Width (W)	Product Height (H)	Maximum Area
480-2,000 mm	350-2,000 mm	4 m ²

*For ordering, round down the nearest 10 mm both in width and in height.

Stack-up Guide (mm)

Product height (H) × 0.025 + 50

Product Weight Guide

Product width 1,000 mm × Product height 1,000 mm: 1.2 kg
Product width 2,000 mm × Product height 2,000 mm: 3.5 kg

Attachments

Bracket

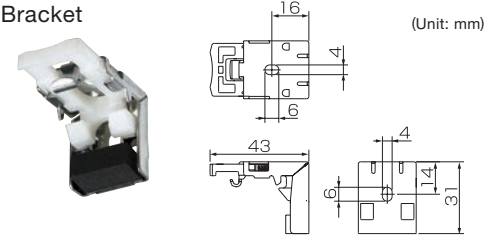

Cable Guide Holder A

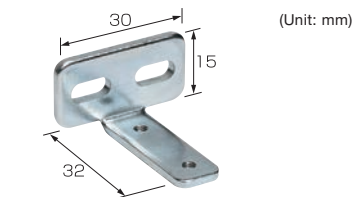

Cable Guide Holder B

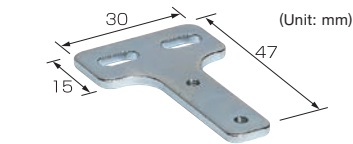

Parts	Product Width (mm)	-1,280	2,190-
Bracket		2	3
Cable Guide Holder A		2	2
Cable Guide Holder B		2	2

*Use the Cable Guide Holder when unable to directly install the Cable Guide inside the window frame.

Installation Method

1. Bracket installation

① Install the Bracket in a position 30-60 mm inward from each end of the Head Rail. If three or more Brackets are required, install the Bracket in between at equal intervals.

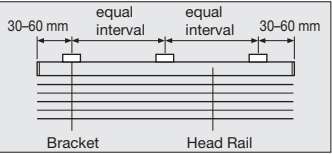

② Fit the Bracket with accompanying screws.

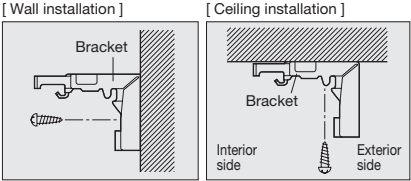

2. Installing the main unit

① With the Slats stacked-up, hang the front groove of the Head Rail on the temporal hook of each Bracket.
② Push up until it securely clicks in.

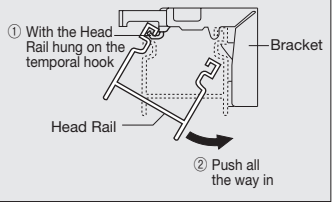

3. Removing the main unit

① With the Slats stacked-up, pull the Head Rail toward you while pressing the Bracket release button.
② Remove the main unit from the temporal hook.

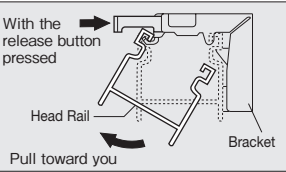

4. Installing Cable Guide Holder

① Install the Cable Guide Holders to make the cables at right angles.
② For wall installation, install the Cable Guide Holders shown in the illustration.

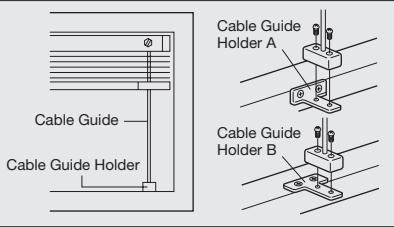

5. Stretching the Cable Guide

Turn the hexagonal winding reel with a coin.
*Winding with a coin gives enough tension. Note that excessive tension may cause a malfunction.

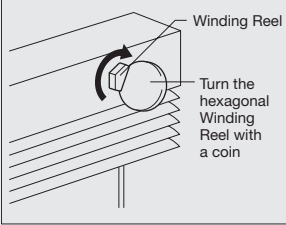

Operation Method (One-control Pipe)

Lowering the blind

With the Lift Cords in your hand, loosen the Cords by pulling down the Grip slightly to lower the blind.

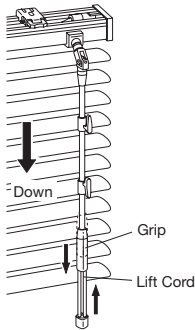

Lifting the blind

With the Slats set horizontal, pull down the Lift Cords to raise the blind.

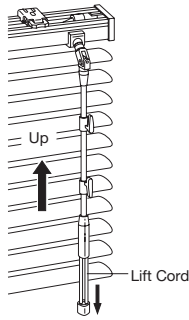

Stopping the blind

Release your hand from the Grip and the blind will stop at that point.

Adjusting a Slat angle

Twist the Grip for tilting.

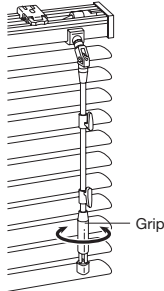

Click mechanism

When the Slats reach the top, the click mechanism will act with a "click" sound to keep them from returning. (It activates both on the room side and the window side.)

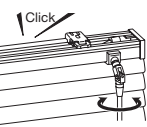

How to use the Cord Hook

Put the Lift Cords on the Cord Hook when the Slats stacked-up.

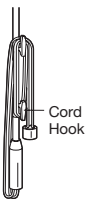

How to Take Measurements

*For the product size, specify to round down the nearest 10 mm.

Ceiling mount inside the window frame

Ceiling installation

Subtract approx. 10 mm from both the actual inner width and height of the window.

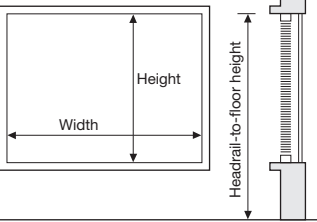

Outside mount covering the window frame

Wall installation

Specify the actual outside sizes, both width and height, for finished dimensions.

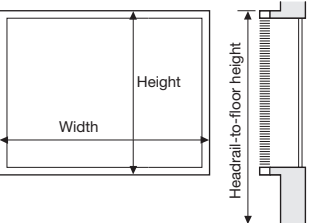

In case fitting the blind inside the curtain box (the Blind Box)

Subtract approx. 10 mm from the box inside width. Measure the height from the top of the box inside.

*Please note that the product height might have a certain margin of error.
*Be sure to specify the height from the top of the Bracket to the floor (head-rail-to-floor height).
Please note that the one-control wand length may be short unless specified.

How to Order

- STEP 1

Choose your type of the blinds.
e.g.) NEW CERAMY 25
- STEP 2

Specify your Slat number.
e.g.) TB-100
- STEP 3

Specify the dimensions (width and height) of the product in 10 millimeters.
e.g.) Width: 1,000 mm, Height: 1,000 mm
*Please note that the product height might have a certain margin of error.
- STEP 4

Specify the control position (right hand control or left hand control viewed from the room side).
e.g.) Right hand control
- STEP 5

Be sure to specify the height from the Bracket position to the floor.
e.g.) 2,000 mm
*Please note that the one-control wand length may be short unless specified.
- STEP 6

Specify the quantity.
e.g.) 1 unit
- STEP 7

Specify optional parts if necessary.
e.g.) Curtain Track Fitting, 2 pieces

● One-control Wand Length
[NEW CERAMY and COLT BLIND Series (One Control Type)]

Headrail-to-floor Height (a)	Product Height (H)	One-control Wand Length
~1,590 mm	— mm	320 mm
1,600~1,990 mm	~1,590 mm	480 mm
2,000~2,190 mm	~1,990 mm	680 mm
2,200~2,390 mm	~2,190 mm	880 mm
2,400~2,590 mm	~2,390 mm	1,000 mm
2,600~2,790 mm	~2,590 mm	1,280 mm
2,800~3,000 mm	~2,790 mm	1,480 mm
3,010~3,200 mm	~3,000 mm	1,680 mm
3,210~3,400 mm	~3,400 mm	1,890 mm
3,410~3,670 mm	~3,670 mm	2,280 mm
3,680~3,870 mm	~3,870 mm	2,480 mm
3,880~4,070 mm	~4,070 mm	2,680 mm
4,080~4,270 mm	~4,270 mm	2,880 mm
4,280~4,470 mm	~4,470 mm	3,080 mm
4,480~4,670 mm	~4,670 mm	3,280 mm
4,680~4,870 mm	~4,870 mm	3,480 mm
4,880~5,000 mm	~5,000 mm	3,690 mm

*When the one-control wand length is 1,480 mm or over, the wand has a joint.

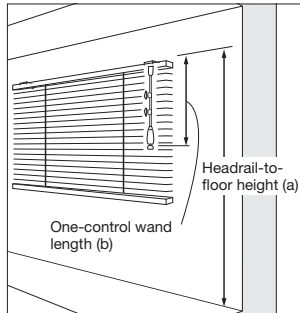

(a): From the top of the Bracket to the floor (headrail-to-floor height).
(b): From the top of the Bracket to the bottom of the one-control wand Grip.

Option

Curtain Track Fitting

Use this when fitting a roller blind on a curtain track.

*With this fitting, a venetian blind fits on a metal track such as a C-type track and a square-type track.

C-type Square-type
120 Yen two pieces (tax excluded)
with 2 Bracket Fastening Screws
180 Yen three pieces (tax excluded)
with 3 Bracket Fastening Screws

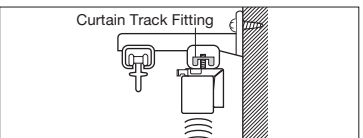
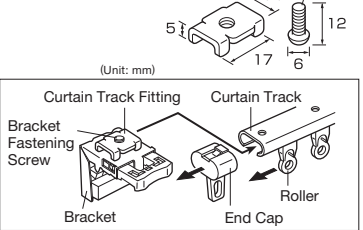

*Curtain Track Fitting: we deliver the fitting free of charge if you specify it when ordering.

Bracket Spacer

Use this when you need to clear the window frame for an outside mount.

Bracket Spacer 12
1 pc. (pan screw: 2 / 3.5 × 40)
2 pcs. (pan screw: 4 / 3.5 × 40)
3 pcs. (pan screw: 6 / 3.5 × 40)

Bracket Spacer 22
1 pc. (pan screw: 2 / 3.5 × 50)
2 pcs. (pan screw: 4 / 3.5 × 50)
3 pcs. (pan screw: 6 / 3.5 × 50)

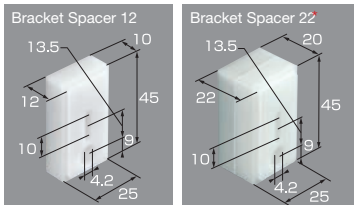
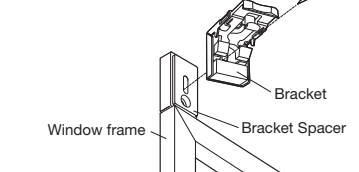

*Lay one spacer on the other before fitting.

Bottom Rail Stabilizer

A device to protect the blind from swaying in the wind when opening a window.

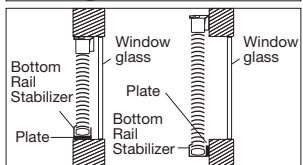
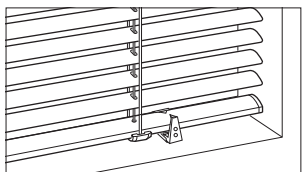
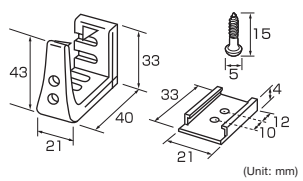

*Bottom Rail Stabilizer: we deliver the fitting free of charge if you specify it when ordering.

Installation Aid 11

Use this when unable to attach the Brackets to the window frame.

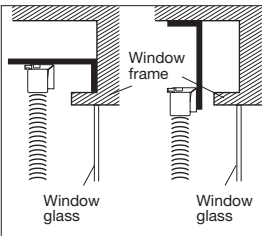
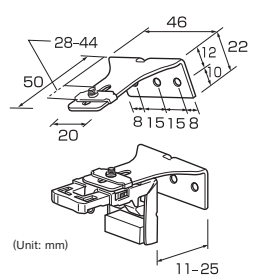

Order Form

Quantity		set(s)
Option		
Headrail-to-floor Height		mm
Control Position	<input type="checkbox"/> Right hand operation <input type="checkbox"/> Left hand operation	
Product Dimensions (Width × Height)	mm × mm	
Slat Number	TB-	
Product Name	<input type="checkbox"/> COLT BLIND 25 <input type="checkbox"/> COLT BLIND 25 for bathroom <input type="checkbox"/> COLT BLIND 25 Tension for bathroom <input type="checkbox"/> NEW CERAMY 25 <input type="checkbox"/> NEW CERAMY 25 for bathroom <input type="checkbox"/> NEW CERAMY 25 Tension for bathroom <input type="checkbox"/> NEW CERAMY 25 with Cable Guide <input type="checkbox"/> NEW CERAMY 15 <input type="checkbox"/> NEW CERAMY 15 for bathroom <input type="checkbox"/> NEW CERAMY 15 Tention for bathroom	