

# Accordion Doors Product Manual

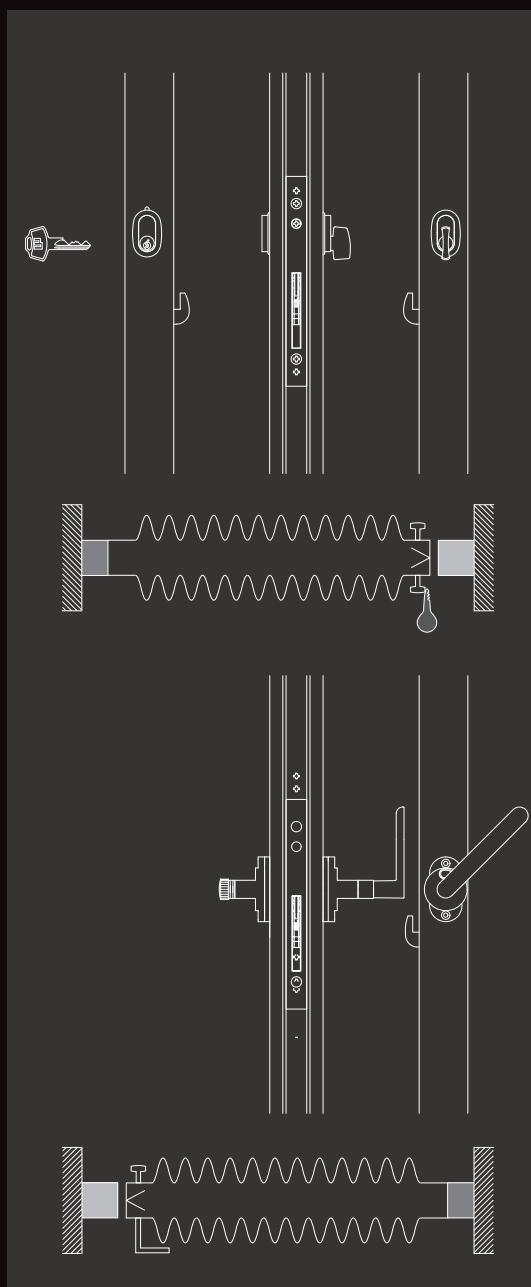



## Contents

Product Line-up .....	1
Specifications and Structure	
CLOZA EXCEL .....	2
CLOZA LIGHT .....	4
Option Specifications .....	6
Option Parts .....	10
Maintenance .....	14
Order Checklists .....	16

# Accordion Doors Product Manual

**TOSO**  
JAPAN  
Premium Curtain Rails & Blinds

## Product Line-up

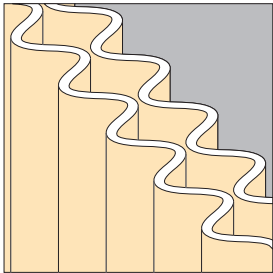
Product Name	CLOZA EXCEL	CLOZA LIGHT
	High-grade Type Widely allowable to use.	Standard Type Operability is light and smooth.
		
Structure	<p><b>Duplex</b></p>  <p>The double structure that the inside is pantograph-shape framework, and paste the Leather on it.</p>	
Allowable Size	Product width: 550–4,000 mm Product height: 610–3,000 mm	Product width: 600–3,000 mm Product height: 1,610–2,400 mm
Track and Handle Color	White Platinum Gray Dark Bronze	White Platinum Gray
Options	Long Handle Type Both Sides Handle Type Front and Back Different Leather Type Upper Leather See-through Type Built-in Type Lock System Type Handle Lock System Type Curved Type Cut-out	Both Sides Handle Type Front and Back Different Leather Type Built-in Type Curved Type *For custom-made products only.

# CLOZA EXCEL

## Product Overview

### Structure Drawing

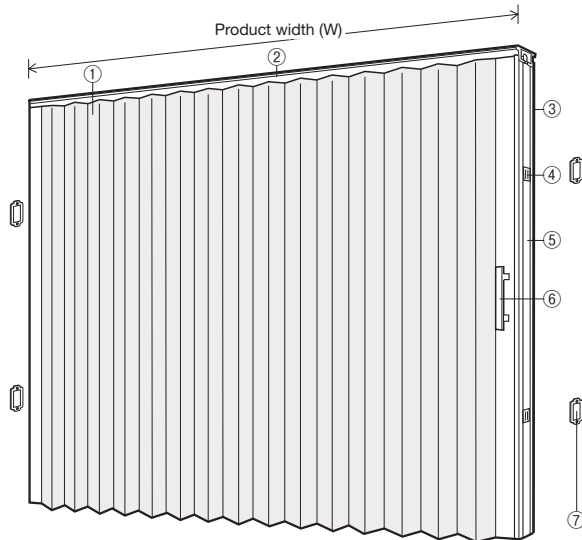

Components	Materials
① Leather	PVC, olefin resin
② Track	aluminum extrusion
③ Frame Cover	aluminum extrusion
④ Magnet	stainless steel press forming, plastic molded, ferrite magnet
⑤ Frame Cushion	plastic molded extrusion
⑥ Handle [antibacterial]	aluminum alloy
⑦ Magnet Adsorption Plate	stainless steel press forming

### Side View

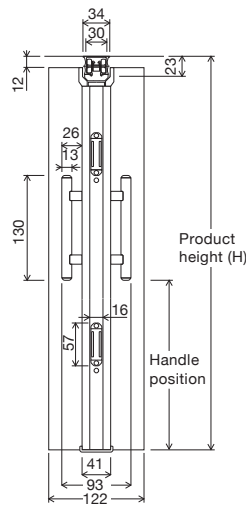

### Handle Position

Unit: mm

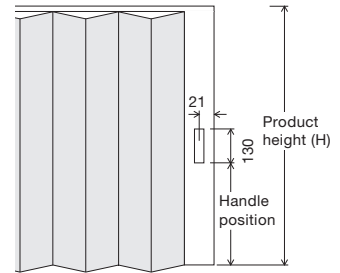

Product Height (H)	Handle Position
610-900	H-315
910-1,200	H-515
1,210-1,700	H-595
1,710-1,800	H-695
1,810-1,900	H-795
1,910-2,000	H-895
2,010-2,100	H-995
2,110-2,300	H-1,095
2,310-2,400	H-1,195
2,410-2,500	H-1,295
2,510-2,600	H-1,395
2,610-2,700	H-1,495
2,710-2,800	H-1,595
2,810-2,900	H-1,695
2,910-3,000	H-1,795

### Attachments

#### Magnet Adsorption Plate

Product Height (H)	Number of Plate
-2,200 mm	4
2,210 mm-	6

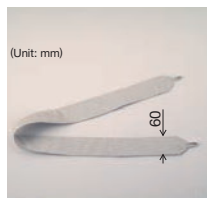
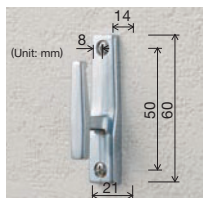
Tieback  
(using the same Leather)Tieback Hook / Type F  
(Silver)

#### Tieback / Tieback Hook

	Owo-way Draw	Split Draw
Tieback (using the same Leather)	1	2
Tieback Hook / Type F	2	4

### Track Cross Section

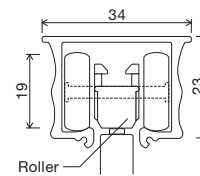

### Allowable Size

Product Width (W)	550-4,000
Product Height (H)	610-3,000

Unit: mm

\*For ordering, round down the nearest 10 mm both in width and in height.

\*Maximum allowable size: One-way draw is of 4 m; Split draw is of 8 m.

### Stack-up Guide

Product Width (W)	Stacked-up Height	Product Width (W)	Stacked-up Height
900	215	2,700	480
1,200	265	3,000	550
1,500	305	3,300	575
1,800	355	3,600	620
2,100	405	4,000	695
2,400	430		







Unit: mm

### Product Weight Guide

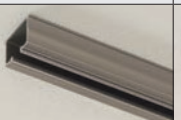
Product width 1,000 mm × Product height 2,000 mm:	10 kg
Product width 1,500 mm × Product height 2,000 mm:	14 kg
Product width 2,000 mm × Product height 2,000 mm:	16 kg

### Available Color Table for Standard Parts

Parts color can be selected from the following three colors. If not specified, we apply a recommended Leather color.

	White	Platinum Gray	Dark Bronze
Track			
Handle			
Magnet Adsorption Plate	 (Unit: mm)		

## Installation Method

### 1. Installing of the main unit



#### Caution

Installing and removing should be done always by two people.  
Leather that tied the door body should not remove until the installing is end.

- Remove the Track Side Cover, pass through Rollers of the body to the Track, set the Track on the body, and disconnect the Alignment Plate slowly with pliers.

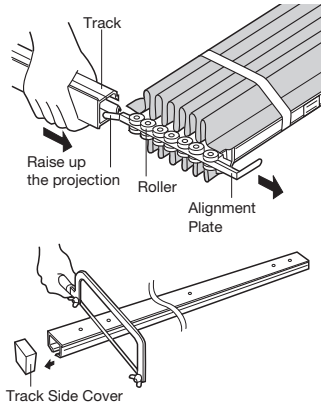

[For cutting the Track]  
Remove the Track Side Cover, and cut the Track with hacksaw.  
Clean up metal chips remaining in the Track.

- Lift up the body, and attach the Track with screws (pan  $\phi 3.5 \times 25$ ). (One person hold the body, and the other person attach the Track.)  
Install the Track with screws in order: first in the center of the Track ①, and next both end ②.  
\*Be careful not to scrape the Track with a screwdriver so as not to become worse the slipping of Rollers.

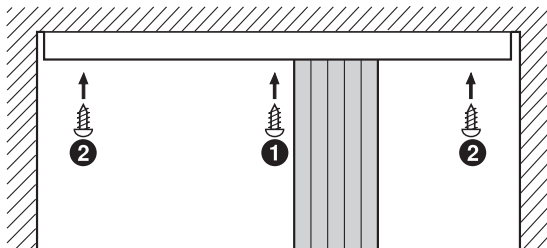

[For Joint Tracks]

- First, attach one Track to the body.
- Attach the Splice Pin to the other Track, and joint them not to make any gap in the seam of both Tracks.
- Slide the Splice Pin in the seam of Tracks by using a fine-tipped tool such as a flat-blade screwdriver.

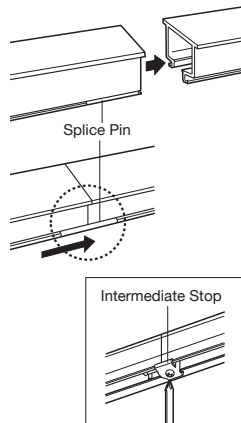

\*In the case of split draw, attach the Intermediate Stop in the connect part.

- Attach the Magnet Adsorption Plate with screw (countersunk  $\phi 3.1 \times 16$ ) to fit the Magnet position of the body.

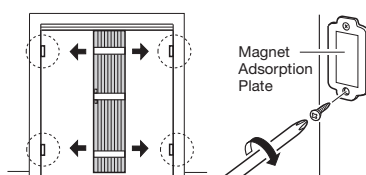

- Remove the Leather that tied the body.

### 2. Removing of the main unit



#### Caution

Because it is dangerous to drop and fall down the main body, another person should always sustain the main body by hand.

- Fold up the body, and move to the center.
- Previously remove the screws at both ends ①, and remove the screw of the center last ②.

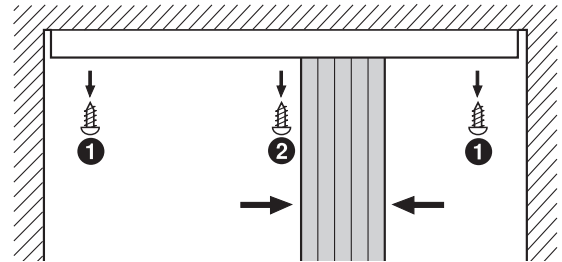

## Operation Method

Opening and closing should always be done by gripping the Handle.

## How to Take Measurements

\*For the product dimensions, specify to round down the nearest 10 mm.

Width: internal dimensions of a door frame.

Height: subtract approx. 20 mm from the height of the opening height.

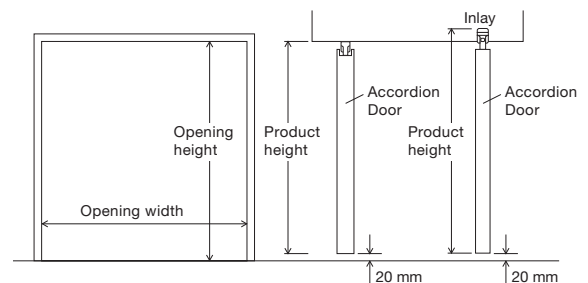

\*Product height: from the Track top to the bottom of the product body

Subtract approx. 20 mm from the top of the carpet if you lay the carpet.

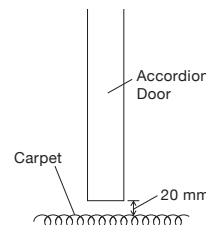

# CLOZA LIGHT

## Product Overview

### ■ Structure Drawing

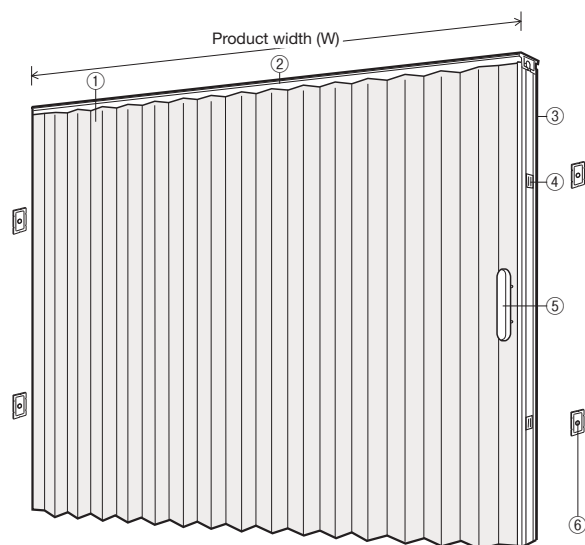

Components	Materials
① Leather	PVC, olefin resin
② Track	aluminum extrusion
③ Frame Cover	plastic molded extrusion
④ Magnet	stainless steel press forming, plastic molded, ferrite magnet
⑤ Handle [antibacterial]	aluminum alloy
⑥ Magnet Adsorption Plate	stainless steel press forming

### ■ Attachments

#### Magnet Adsorption Plate

Product Height (H)	Number of Plate
~2,200 mm	4
2,210 mm~	6

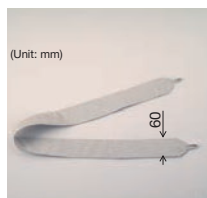

Tieback  
(using the same Leather)

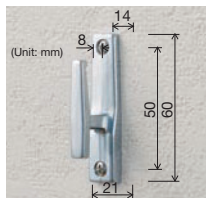

Tieback Hook / Type F  
(Silver)

#### Tieback / Tieback Hook

	Owo-way Draw	Split Draw
Tieback (using the same Leather)	1	2
Tieback Hook / Type F	2	4

### ■ Available Color Table for Standard Parts

Parts color can be selected from the following three colors. If not specified, we apply a recommended Leather color.

	White	Platinum Gray
Track		
Handle		
Magnet Adsorption Plate	 (Unit: mm)	

### ■ Side View

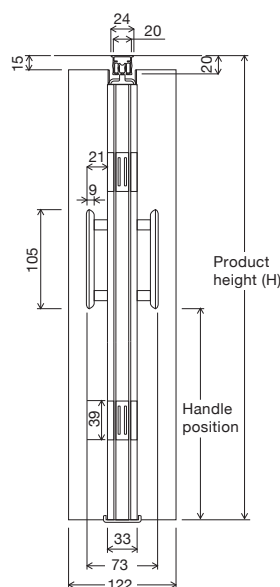

### ■ Handle Position

Unit: mm

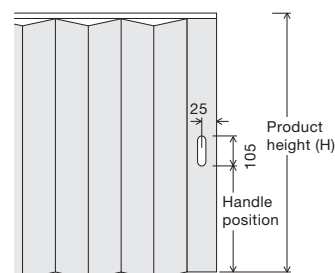

Product Height (H)	Handle Position
1,610~1,800	H-700
1,810~1,900	H-860
1,910~2,000	H-960
2,010~2,100	H-1,000
2,110~2,300	H-1,100
2,310~2,400	H-1,200

### ■ Track Cross Section

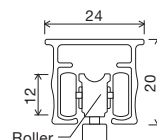

### Allowable Size

Unit: mm

#### [Custom-made product]

Product Width (W)	600~3,000
Product Height (H)	1,610~2,400

\*For ordering, round down the nearest 10 mm both in width and in height.  
\*Maximum allowable size: One-way draw is of 3 m; Split draw is of 6 m.

#### [Standard product]

Product Width (W)	1,000
Product Height (H)	1,740 or 1,800

\*Only TD-5055 and 5056.

### Stack-up Guide

Unit: mm

Product Width (W)	Stacked-up Height	Product Width (W)	Stacked-up Height
1,000	245	2,250	410
1,250	265	2,500	435
1,500	295	2,750	485
1,750	335	3,000	530
2,000	360		

### Product Weight Guide

Product width 1,000 mm × Product height 2,000 mm:	7.0 kg
Product width 1,500 mm × Product height 2,000 mm:	9.5 kg
Product width 2,000 mm × Product height 2,000 mm:	12.5 kg

## Installation Method

### 1. Installing of the main unit



#### Caution

Installing and removing should be done always by two people.  
Leather that tied the door body should not remove until the installing is end.

- Remove the Track Side Cover, pass through Rollers of the body to the Track, set the Track on the body, and disconnect the Alignment Rod slowly with pliers.

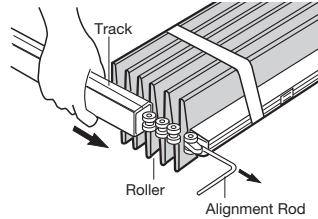

[For cutting the Track]  
Remove the Track Side Cover, and cut the Track of opposite side of the Roller Stop Screw Hole with hacksaw. Clean up metal chips remaining in the Track.

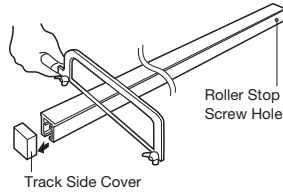

- Lift up the body, and attach the Track with screws (pan  $\phi 3.5 \times 25$ ). (One person hold the body, and the other person attach the Track.)  
Install the Track with screws in order: first in the center of the Track ①, and next both end ②.

\*Be careful not to scrape the Track with a screwdriver so as not to become worse the slipping of Rollers.

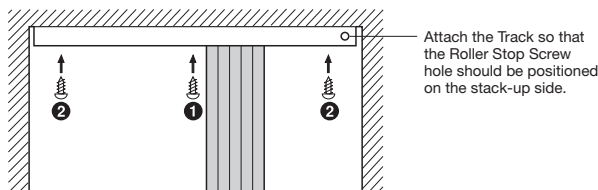

[For the split draw]

- First, attach one Track to the body.
- Attach another Track, and not to make any gap in the seam of Track.
- Attach the Intermediate Stop in the connect part.

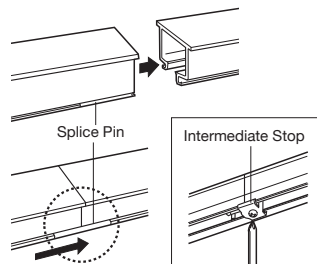

- Attach the Magnet Adsorption Plate with screw (countersunk  $\phi 3.1 \times 16$ ) to fit the Magnet position of the body.

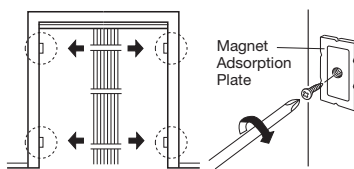

[For fixing one side with the one-way draw]

Fix the Pilot Roller on the fixed side with the Roller Stop Screw (pan  $\phi 3.1 \times 20$ ).

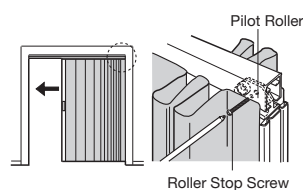

- Remove the Leather that tied the body.

### 2. Removing of the main unit



#### Caution

Because it is dangerous to drop and fall down the main body, another person should always sustain the main body by hand.

- Fold up the body, and move to the center.
- Previously remove the screws at both ends ①, and remove the screw of the center last ②.

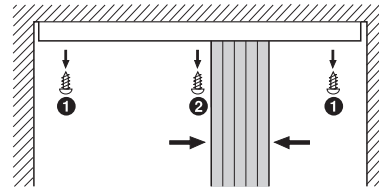

## Operation Method

Opening and closing should always be done by gripping the Handle.

## How to Take Measurements

\*For the product dimensions, specify to round down the nearest 10 mm.

### [Custom-made product]

Width: internal dimensions of a door frame.

Height: subtract approx. 20 mm from the height of the opening height.

### [Standard product]

Choose the size that fits to the mounting location from in the lineup.

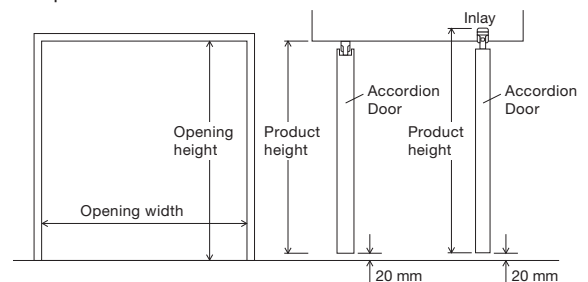

\*Product height: from the Track top to the bottom of the product body

Subtract approx. 20 mm from the top of the carpet if you lay the carpet.

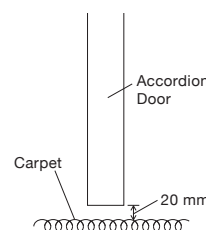



# Option Specifications

## Long Handle Type Antibacterial

Long Handle type easier to grip than normal Handle. The elderly and wheelchair users, as well as healthy people are able to grip the Handle in a natural posture. The surface has been applied antibacterial processing and it is clean.



TD-5053  
Long Handle: Platinum Gray

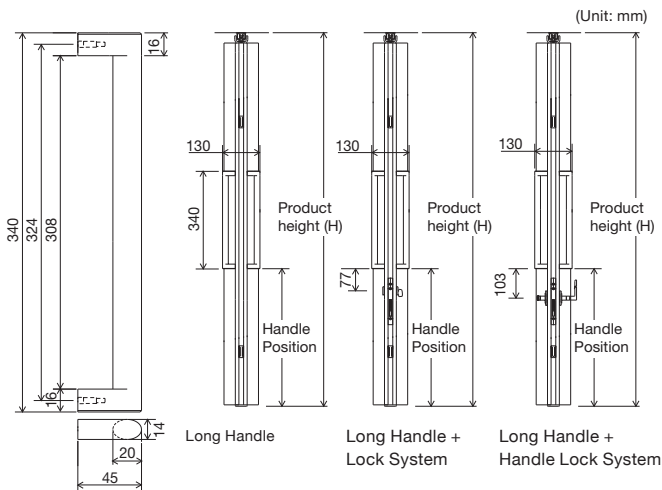

Product Height (H)	Handle Position	Product Height (H)	Handle Position	Product Height (H)	Handle Position
610-1,000	none	1,910-2,000	H-1,125	2,510-2,600	H-1,625
1,010-1,200	H-745	2,010-2,100	H-1,225	2,610-2,700	H-1,725
1,210-1,700	H-825	2,110-2,300	H-1,325	2,710-2,800	H-1,825
1,710-1,800	H-925	2,310-2,400	H-1,425	2,810-2,900	H-1,925
1,810-1,900	H-1,025	2,410-2,500	H-1,525	2,910-3,000	H-2,025

### Attachment Position

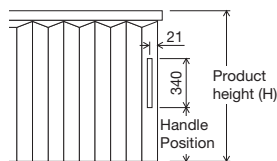

### Allowable Attachment Height

Long Handle	Product height: 1,010 mm or more
Long Handle + Lock System	Product height: 1,210 mm or more
Long Handle + Handle Lock System	Product height: 1,210 mm or more

### Available Types

○ : allowable x : non-allowable

CLOZA EXCEL	○
CLOZA LIGHT	x

### Price

#### One-way draw

Standard price+3,300 Yen (tax excluded)  
\*One pair for the front and back Leathers.

#### Split draw

Standard price+6,600 Yen (tax excluded)  
\*Two pairs for the front and back Leathers.

## Both Sides Handle Type Antibacterial

It is possible to attach the Handle on both sides. If you want to open and close from every side of left or right, it is recommended.



### Available Types

○ : allowable x : non-allowable

CLOZA EXCEL	○
CLOZA LIGHT	○

### Price

#### One-way draw

Standard price+2,600 Yen (tax excluded)  
\*One pair for the front and back Leathers.

#### Split draw

Standard price+5,200 Yen (tax excluded)  
\*Two pairs for the front and back Leathers.

## Front and Back Different Leather Type

You can choose different pattern of Leather in the front and back surface. As a partition, it is recommended in the place where is the taste of the room is different.

### CLOZA EXCEL

\*See-through Leather (TD-5011-5015) is not available.

\*Parts color is standard color of surface Leather. Some color other than standard color also can choose.

### CLOZA LIGHT

\*Parts color is standard color of surface Leather, however back side Handle color is standard color of back surface Leather. Some color other than standard color also can choose.

### Available Types

○ : allowable x : non-allowable

CLOZA EXCEL	○
CLOZA LIGHT	○

### Price

No additional charge



### Caution

In the case of CLOZA EXCEL Handle lock type, please specify the Handle position as well as front and back Leather.



## Upper Leather for See-through Type

You can choose upper part see-through type on front and back Leather. While maintaining the care of elders and children, also keeping their privacies.

### ■ Allowable Size

Product Width (W)	550–5,000 mm
Product Height (H)	1,300–3,000 mm

\*For ordering, round down the nearest 10 mm both in width and in height.

### ■ Available Leather

Upper Part Leather	TD-5011–5015
Lower Part Leather	TD-5001–5010, 5016–5066

### ■ Part Color

It becomes the standard color of the lower part Leather. Some color other than standard color also can choose.

### ■ Two Types

We have two types of upper see-through height. Please specify which height at the time of your order.



Upper part Leather: TD-5013  
Lower part Leather: TD-5017

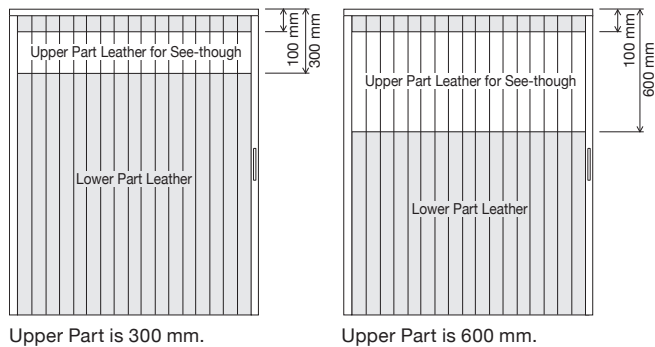

Upper Part is 300 mm.

Upper Part is 600 mm.

### ■ Available Types

○ : allowable × : non-allowable

CLOZA EXCEL	○
CLOZA LIGHT	×

### ■ Price

Standard price of lower part Leather  
+15,900 Yen (tax excluded)

## Built-in Type

By built-in the Track to the ceiling, hanging roots look neat.

\*Built-in type requires a groove processing to the ceiling before installing the product.



### CLOZA EXCEL

(Unit: mm)

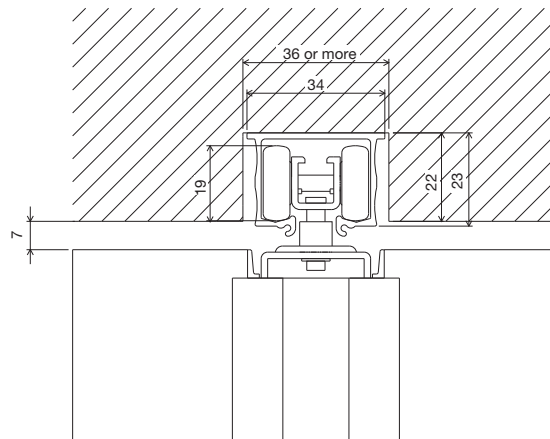

### CLOZA LIGHT

(Unit: mm)

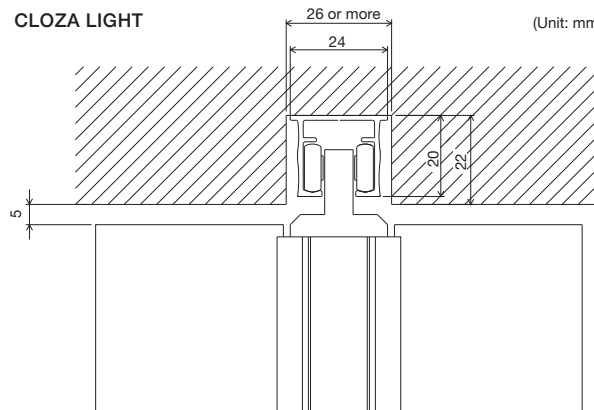

### ■ Available Types

○ : allowable × : non-allowable

CLOZA EXCEL	○
CLOZA LIGHT	○

### ■ Price

No additional charge

## Lock System

Lock and unlock type by using the key. It is recommended to the location where you want to secure privacy such as your study or workplace.

\*In the case of front and back different Leather type, be sure to specify the Leather number of the lock side.



Lock side



Knob side

Lock, knob color: Silver

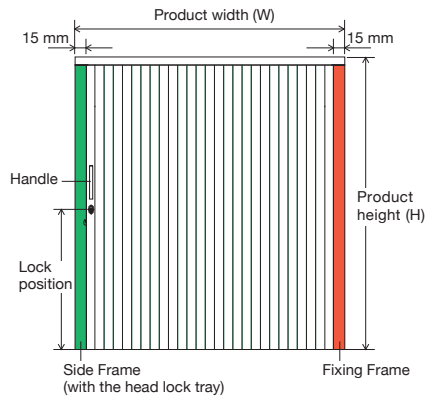
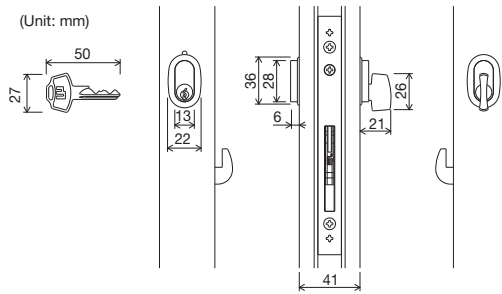

Product Height (H)	Lock Position	Product Height (H)	Lock Position
610-900	H-375	2,310-2,400	H-1,255
910-1,200	H-575	2,410-2,500	H-1,355
1,210-1,700	H-655	2,510-2,600	H-1,455
1,710-1,800	H-755	2,610-2,700	H-1,555
1,810-1,900	H-855	2,710-2,800	H-1,655
1,910-2,000	H-955	2,810-2,900	H-1,755
2,010-2,100	H-1,055	2,910-3,000	H-1,855
2,110-2,300	H-1,155		

Lock position: from the standard position to the bottom of the body

### One-way draw, left lock

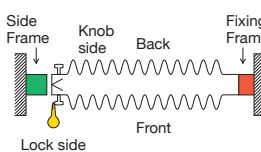

Use one-side Fixing Frame and one-side Side Frame, and attached the lock on the Side Frame side.

### One-way draw, right lock

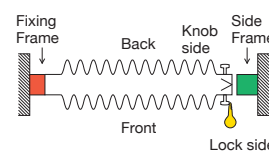

### Split draw

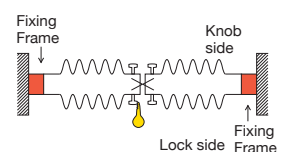

Use Fixing Frame on both sides.

## Available Types

○ : allowable x : non-allowable

CLOZA EXCEL	○
CLOZA LIGHT	x

## Price

### One-way draw

Standard price+24,700 Yen (tax excluded)  
(with Side Frame: 1, Fixing Frame: 1, Key: 3)

### Split draw

Standard price+25,400 Yen (tax excluded)  
(with Fixing Frame: 2, Key: 3)

## Same key assignment

(for one-way draw and split draw)

The price of assigning the same key to multiple doors: + 41,300 Yen

## Handle Lock System Type

Antibacterial

It is possible to attach the Handle on both sides. If you want to open and close from every side of left or right, it is recommended.



Handle lock side



Knob side



Locked



Unlocked

Handle lock, knob color: Platinum Gray

An emergency, you can unlock by fitting a coin in the knob and turning. Or, you can unlock by pinching the knob strongly with your fingers and turning.



## Caution

In the case of front and back different Leather type, please direct the front and back of the Leather, and the Handle lock position.

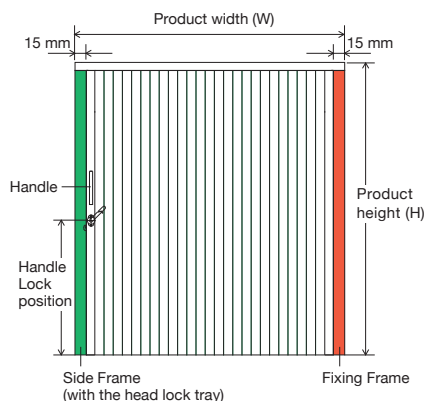
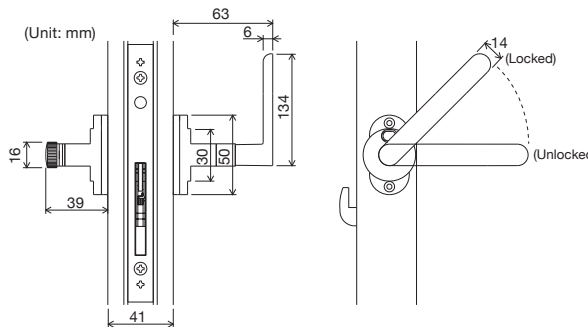

Product Height (H)	Handle Lock Position	Product Height (H)	Handle Lock Position
610-900	H-400	2,310-2,400	H-1,280
910-1,200	H-600	2,410-2,500	H-1,380
1,210-1,700	H-680	2,510-2,600	H-1,480
1,710-1,800	H-780	2,610-2,700	H-1,580
1,810-1,900	H-880	2,710-2,800	H-1,680
1,910-2,000	H-980	2,810-2,900	H-1,780
2,010-2,100	H-1,080	2,910-3,000	H-1,880
2,110-2,300	H-1,180		

Handle lock position: from the standard position to the bottom of the body

### One-way draw, left Handle lock

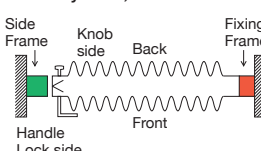

Use one-side Fixing Frame and one-side Side Frame, and attached the Handle lock on the Side Frame side.

### One-way draw, right Handle lock

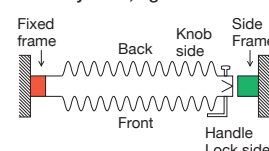

### Split draw

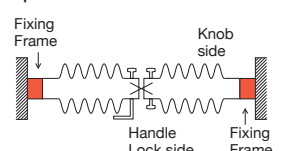

Use Fixing Frame on both sides.

## Curved Type

It is used as a partition to the corner in the storage space or dressing room.

### ■ Allowable Size

CLOZA EXCEL	Product Width (W)	550–4,000 mm
	Product Height (H)	610–3,000 mm
CLOZA LIGHT	Product Width (W)	600–3,000 mm
	Product Height (H)	1,610–2,400 mm
Curved Type	L-shaped Curve	450 mmR 800 mmR or more 90° or more
	Overall Curve	800 mmR or more

\*For ordering, round down the nearest 10 mm both in width and in height.

\*Including the Tieback Hook and the Tieback (using the same Leather).

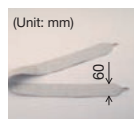

Tieback (using the same Leather)

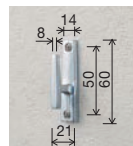

Tieback Hook Type F (Silver)

### L-shaped Curve



TD-5053

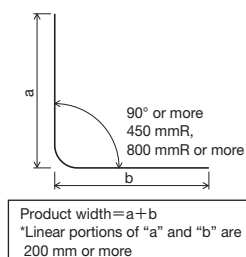

### Overall Curve



TD-5046

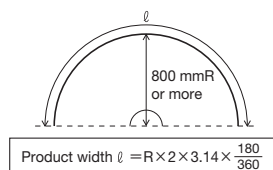

### ■ Available Types

○ : allowable × : non-allowable

CLOZA EXCEL	○
CLOZA LIGHT	○

### ■ Price

#### CLOZA EXCEL

Standard price multiplied by 1.2 (tax excluded)

#### CLOZA LIGHT

Standard price multiplied by 1.3 (tax excluded)

\*No allowable for standard products.

\*Less than 100 yen is rounded.

\*Not available for TD-5011–5014.

	Owo-way Draw	Split Draw
Tieback (using the same Leather)	1	2
Tieback Hook Type F	2	4

\*Curved Track Length for Ordered Separately

CLOZA EXCEL: Maximum 4.5 m

CLOZA LIGHT: Maximum 4 m

## Cut-out

Cut-out possible for the part of the product, if there are obstacles around at the top or bottom of the product installation location.

### Upper Position Cut-out

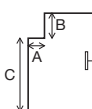

#### ■ Allowable Size

A	70–450 mm
B	50–500 mm
C	1,200 mm–

### Lower Position Cut-out

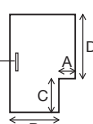

#### ■ Allowable Size

A	70 mm–
B	400 mm–
C	50 mm–
D	500 mm–

\*For ordering of the cut-out, round down the nearest 10 mm both in width and in height.

\*Cut-out part is the opposite of the handle.

### Upper and Lower position Cut-out

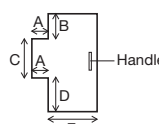

#### ■ Allowable Size

A	70–450 mm
B	50–500 mm
C	1,200 mm–
D	B–
E	1,000 mm–

### ■ Available Types

○ : allowable × : non-allowable

CLOZA EXCEL	○
CLOZA LIGHT	×

### ■ Price

#### Upper cut-out

Standard price+16,000 Yen (tax excluded)

#### Lower cut-out

Standard price+16,000 Yen (tax excluded)

#### Upper and Lower cut-out

Standard price+32,000 Yen (tax excluded)

# Option Parts

## Intermediate Stop

It is used in the case to fix the product in the middle of the Track, or to use as a mark at the center position of split draw.

### CLOZA EXCEL



White



Platinum Gray



Dark Bronze

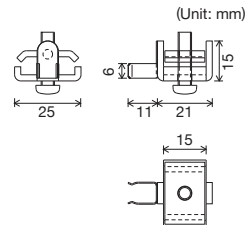

### CLOZA LIGHT



White



Platinum Gray

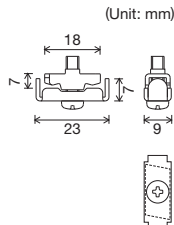

### Available Types

○ : allowable x: non-allowable

CLOZA EXCEL	○
CLOZA LIGHT	○

### Price

#### CLOZA EXCEL

1 piece: 180 Yen (tax excluded)

#### CLOZA LIGHT

1 piece: 120 Yen (tax excluded)

\*It takes delivery time if you order it separately.

## End Cap

It is used when the end of the Track is not a wall, to prevent falling out the product.

### CLOZA EXCEL



White



Platinum Gray



Dark Bronze

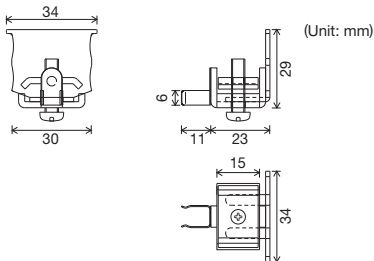

### CLOZA LIGHT



White



Platinum Gray

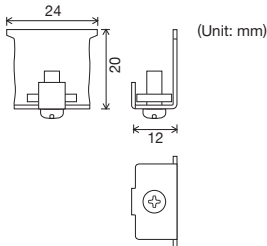

### Available Types

○ : allowable x: non-allowable

CLOZA EXCEL	○
CLOZA LIGHT	○

### Price

#### CLOZA EXCEL

1 piece: 320 Yen (tax excluded)

#### CLOZA LIGHT

1 piece: 180 Yen (tax excluded)

\*It takes delivery time if you order it separately.

## Kamoi Bracket (for a Japanese sliding door)

Use to install the product on the lintel part.

### CLOZA EXCEL



Product Width (mm)	Track	Number
550–1,200	1	3
1,210–1,650	1	4
1,660–2,400	1	5
2,410–3,300	1	7
3,310–4,000	1	9



White



Platinum Gray



Dark Bronze

### CLOZA LIGHT



Product Width (mm)	Number
600–1,000	3
1,010–1,750	4
1,760–2,250	5
2,260–2,750	6
2,760–3,000	7



White



Platinum Gray

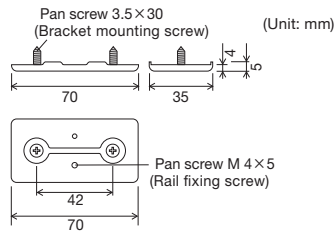

### Available Types

○ : allowable × : non-allowable

CLOZA EXCEL	○
CLOZA LIGHT	○

### Price

1 piece: 180 Yen (tax excluded)

\*It takes delivery time if you order it separately.

### Attachment

Track Fixing Screw  
(pan M4x5): 1 piece

Bracket Screw  
(pan 3.5x30): 2 pieces

## Side Frame

If the wall has a level difference because of the skirting board or crown molding, it fills a gap (thickness of skirt board, etc.) between the product and wall.

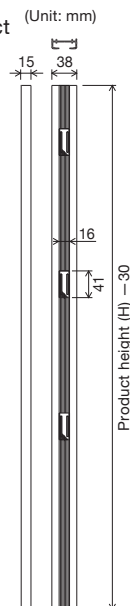

White



Platinum Gray



Dark Bronze

### Available Types

○ : allowable × : non-allowable

CLOZA EXCEL	○
CLOZA LIGHT	×

### Price

1 piece: 6,000 Yen (tax excluded)

\*It takes delivery time if you order it separately.



## Wall Fixing Bracket

Use to fix one side of the product to the wall.

### CLOZA EXCEL

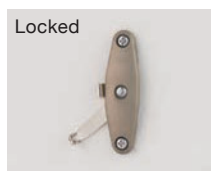

Platinum Gray

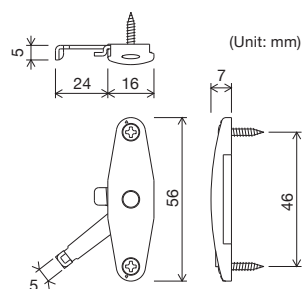

Mounting screws (pan  $\phi 3 \times 16$ )

### CLOZA LIGHT

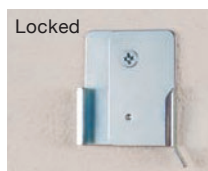

Silver

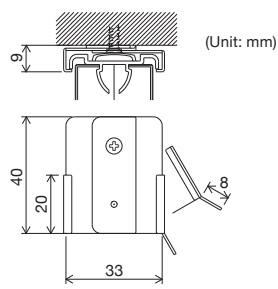

Mounting screws (countersunk  $\phi 3.1 \times 16$ )

### Available Types

○ : allowable × : non-allowable

CLOZA EXCEL	○
CLOZA LIGHT	○

### Price

#### CLOZA EXCEL

1 piece: 310 Yen (tax excluded)

#### CLOZA LIGHT

1 piece: 180 Yen (tax excluded)

\*It takes delivery time if you order it separately.

Product Height (mm)	Number
~2,200	2
2,210~	3

## Wall Fixing Frame

It is used if the wall has a level difference because of the skirting board or crown molding, and fixing one side of the product to the wall.



A fixed state

(Unit: mm)

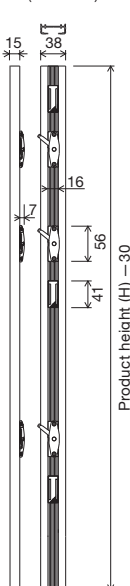

White



Platinum Gray



Dark Bronze

### Available Types

○ : allowable × : non-allowable

CLOZA EXCEL	○
CLOZA LIGHT	×

### Price

1 piece: 6,700 Yen (tax excluded)

\*It takes delivery time if you order it separately.

## Adjustable Hanger Rod

Use to hang the product from the ceiling.

Two-hanging:

Use to support the Track in the middle hanging.

Three-hanging:

If the Track end can not be fixed to the wall, attach the Track with three-hanging to prevent rolling the Track.

One place is necessary within a 500 mm interval.

Position of both ends: appropriate to locate them in a position 50–100 mm inward from each Track end.



White



Dark Bronze

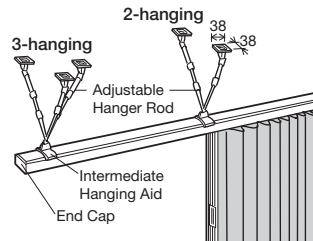

### Available Types

○ : allowable × : non-allowable

CLOZA EXCEL	○
CLOZA LIGHT	○

### Price

Adjustable Hanger Rod  
B400 (250–400 mm)  
1 piece: 1,240 Yen (tax excluded)

Adjustable Hanger Rod  
B700 (400–700 mm)  
1 piece: 1,650 Yen (tax excluded)

\*It takes delivery time if you order it separately.

## Overhead Hanger

On middle portion, it is a connecting part both the Track and Adjustable Hanger Rod.

One place is necessary within a 500 mm interval.

Position of both ends: appropriate to locate them in a position 50–100 mm inward from each Track end.

### CLOZA EXCEL



White



Platinum Gray



Dark Bronze

### CLOZA LIGHT



White



Platinum Gray

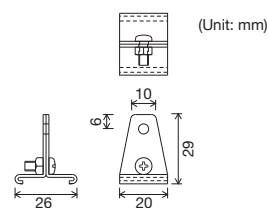
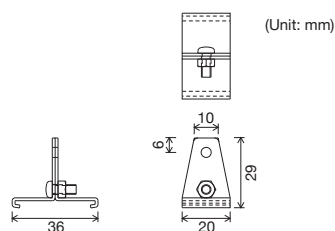

### Available Types

○ : allowable × : non-allowable

CLOZA EXCEL	○
CLOZA LIGHT	○

### Price

CLOZA EXCEL  
1 piece: 140 Yen (tax excluded)

CLOZA LIGHT  
1 piece: 100 Yen (tax excluded)

\*It takes delivery time if you order it separately.

## Wall Bracket

Use to fix the Track on the wall at middle portion.

### CLOZA EXCEL



White



Platinum Gray



Dark Bronze

### CLOZA LIGHT



White



Platinum Gray

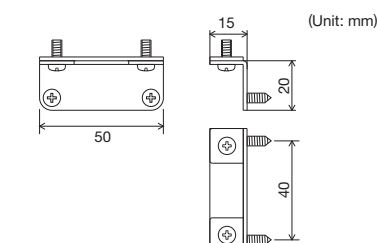
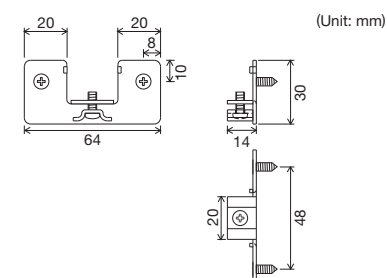

### Available Types

○ : allowable × : non-allowable

CLOZA EXCEL	○
CLOZA LIGHT	○

### Price

CLOZA EXCEL  
1 piece: 140 Yen (tax excluded)

CLOZA LIGHT  
1 piece: 140 Yen (tax excluded)

\*It takes delivery time if you order it separately.



# Maintenance

## How to Shorten the Height — CLOZA EXCEL

Between 10 mm and 50 mm, available shorten the product height to the nearest 10 mm.

- ① Remove the main unit from the Track, and remove the Cap End at the bottom of the body.
- ② Remove the Frame Cushion, remove fixing screw, and remove the Frame Cover.
- \*Since Frame Holder remains to the Cut Frame side, take care not to lose it.
- ③ Peel off the Leather about 100–200 mm from the Cut Frame.

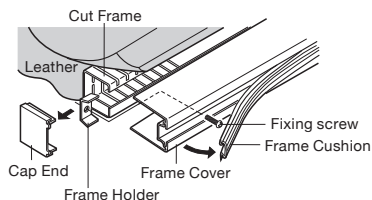

- ④ Cut the Cut Frame in a length you want to shorten with a nipper, and cut out unnecessary part with folding several times. File the cut surface.

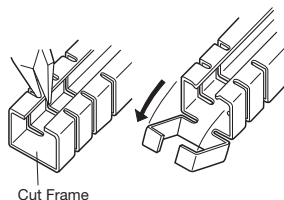

- ⑤ Cut the Leather leaving the turn-up margin (of 20–50 mm) to fit the Cut Frame. Undo the sewing thread as necessary.

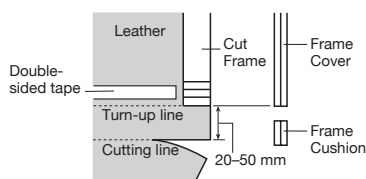

- ⑥ Bond the Leather with double-sided tape along the return line of the Leather.
- ⑦ Cut the Frame Cover and the Leather Cushion with hacksaw to fit the Cut Frame.
- ⑧ Paste the Leather to the Cut Frame.

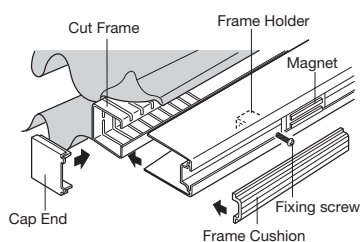

- ⑨ Insert the magnet to the Frame Cover, and relocate to the original position.
- ⑩ Do a temporarily tacking of the fixing screw and the Frame Holder to the Frame Cover.

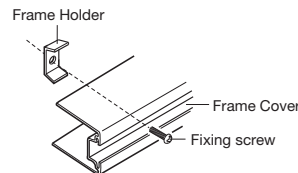

\*Tacking of the fixing screw should be to the extent that Frame Cover and the Frame Holder hit as shown in the figure.

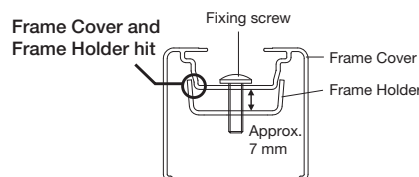

- ⑪ Fit the Frame Cover to the Cut Frame, suit the position of the Handle, push strongly and fix it by tightening the fixing screw.
- \*Push the Frame Cover strongly and firmly.

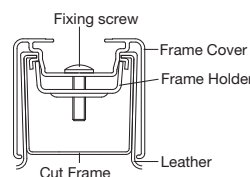

- ⑫ Attach the Frame Cushion and the Cap End.
- ⑬ Attach the main unit to the Track.

\*If the slack of the Leather has occurred, adjust the Leather by pulling the tension tape to the bottom. If the tape is visible from the bottom of Leather, cut the tape.

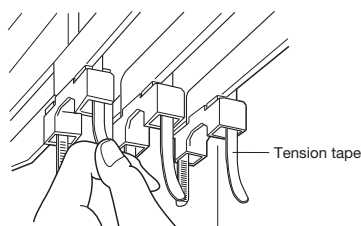

## How to Shorten the Height — CLOZA LIGHT

Available shorten the product height to the nearest 10 mm in the following range.

Unit: mm

Product height (Two digits)	-0	-10	-20	-30	-40	-50	-60	-70	-80	-90
Allowable shortening length	90	00 (60)	10 (70)	20 (80)	30 (90)	40	50	60	70	80

- ① Remove the main unit from the Track, and remove the Cap End at the bottom of the body.
- ② Remove the Cap End and the Frame Cover at the bottom of the body.
- ③ Peel off Leather about 100–200 mm from Cut Frame.

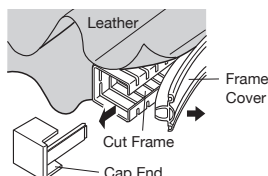

- ④ Cut the Cut Frame in a length you want to shorten with nipper, and cut out unnecessary part with folding several times. File the cut surface.

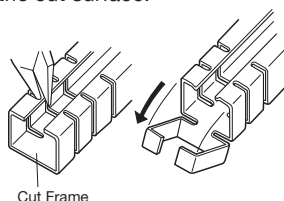

- ⑤ Cut the Leather leaving the turn-up margin (of 20–50 mm) to fit the Cut Frame. Undo the sewing thread as necessary.

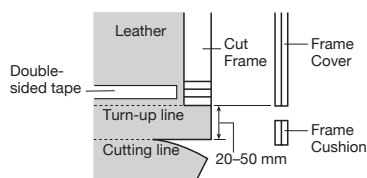

- ⑥ Bond the Leather with double-sided tape along the return line of Leather.
- ⑦ Cut the Frame Cover and the Frame Cushion with hacksaw to fit the Cut Frame.
- ⑧ Paste the Leather to the Cut Frame.
- ⑨ Push strongly the Frame Cover to the Cut Frame, and attach the Cap End.
- ⑩ Attach the main unit to the Track.

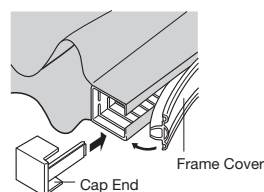

\*If the slack of the Leather has occurred, adjust the Leather by pulling the tension tape to the bottom. If the tape is visible from the bottom of Leather, cut the tape.

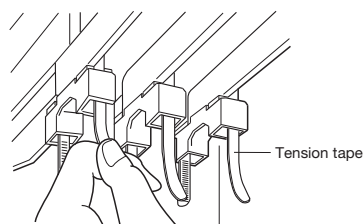

## Maintenance Sticker

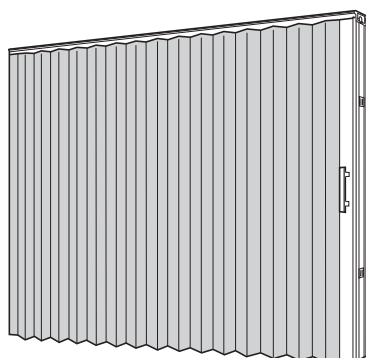

- For preventive maintenance, a maintenance sticker attached to the product you bought. Please refer to the sticker in case you need to contact us or repair the product.

CLOZA EXCEL: Pasted on the place where the frame cushion is removed.

CLOZA LIGHT: Pasted on the place where the frame cover is removed.

This shows you the date of production.

Date of Production: \*\*, \*\*, \*\*\*\*\*  
 Product Name: CLOZA EXCEL  
 TD-5001 2000 × 2000  
 Serial Number: \*\*\*\*\* Made in Japan

TOSO



This shows you the following information:

CLOZA EXCEL TD-\*\*\*\*\* 2000 × 2000  
 Product Name Leather Number Product Width Product Height

- With the bar code reader of your mobile phone, you can read a 2-dimensional bar code on the sticker and access our site to get the product information.

\*Attention: you may not be able to read the bar code if the sticker gets dirty or damaged.

## How to Care

Wipe lightly with a cloth moistened with detergent if the product gets dirty.  
Do not use the paint thinner.

1. Leather Number

2. Product Size

\*Width (W) : 10 mm units

\*Height (H) : 10 mm units

\*Allowable size is depending on the leather series.

3. Operation System

4. Parts Color

5. Quantity

6. Options

No Additional Charge

7. Options

Additional Charge

CLOZA EXCEL

☐ Front and Back Same Leather

TD-

☐ Front and Back Different Leather

TD- (Front)

TD- (Back)

\*TD-5011-5015 : CANNOT CHOOSE

Width (W) mm

Height (H) mm

☐ One-way Draw

☐ Split Draw

☐ White

☐ Platinum Gray

☐ Dark Bronze

Unit(s)

☐ Built-in Track

☐ Long Handle

☐ Both Handle

☐ Upper Leather for see-through

☐ Upper 300 mm

☐ Upper 600 mm

☐ Lock

☐ One-way Draw / left lock

☐ One-way Draw / right lock

☐ Split Draw

☐ Handle Lock

☐ One-way Draw / left handle lock

☐ One-way Draw / right handle lock

☐ Split Draw

☐ Curved

☐ L-shaped / 450 mmR

☐ L-shaped / 800 mmR

☐ L-shaped / 800 mmR more mmR

☐ Overall / 800 mmR

☐ Overall / 800 mmR more mmR

☐ Cut-out \*Attach the illustration.

☐ Upper

☐ Lower

☐ Upper and Lower

☐ Intermediate Stop

☐ End Cap

☐ Kamoi Bracket (for Japanese Sliding Door)

☐ Side Frame

☐ Wall Fixing Bracket

☐ Wall Fixing Frame

☐ Adjustable Hanger Rod

☐ B400

☐ B700

☐ Overhead Hanger

☐ Wall Bracket

CLOZA LIGHT

☐ Front and Back Same Leather

TD-

\*TD-5011-5015 : CANNOT CHOOSE

☐ Front and Back Different Leather

TD- (Front)

TD- (Back)

\*TD-5011-5015 : CANNOT CHOOSE

Width (W) mm

Height (H) mm

☐ One-way Draw

☐ Split Draw

☐ White

☐ Platinum Gray

Unit(s)

☐ Built-in Track

☐ Both Handle

☐ Curved

☐ L-shaped / 450 mmR

☐ L-shaped / 800 mmR

☐ L-shaped / 800 mmR more mmR

☐ Overall / 800 mmR

☐ Overall / 800 mmR more mmR

☐ Intermediate Stop

☐ End Cap

☐ Kamoi Bracket (for Japanese Sliding Door)

☐ Wall Fixing Bracket

☐ Adjustable Hanger Rod

☐ B400

☐ B700

☐ Overhead Hanger

☐ Wall Bracket



# Accordion Doors Product Manual

