



ATTENTION

- ❗ For the Rail Set with OT Splice, this task should be performed by no fewer than two people.
- ❗ For the Rail Set with OT Splice, make sure the Joint part is adequately supported during the mounting process.

■ Disassembly method of the Bracket

Loosen the Bracket screw and rotate the Fastener to remove the bracket.



Cleaning

- Be aware that direct contact with water, wiping the product with paint thinner or other solvent, or cleaning it with chemicals could cause malfunction, discoloration or distortion.
- If the product becomes dirty, clean it by wiping with a clean, soft dry cloth.

Disposal of packing materials

- Do not leave packing materials at the installation site.
- Separate combustible cardboard from noncombustible waste.
- Observe the local waste separation regulations when disposing of the materials.

TOSO

Motorized Curtain Tracks

PROGRESS 50 Rail Set

No.N-08100101

Instruction Manual

Thank you for purchasing TOSO products. To ensure safe use of this product, please read the following thoroughly and keep this manual stored.

Guide for Distributors and Installation Contractors

This manual contains information for a user to safely operate this product. Please provide this manual to a customer.

INDEX

■ Caution	2
■ Product view and part names	4
■ Installation and Disassembly Method	6
■ Cleaning	12
■ Disposal of Packing Materials	12

CAUTION

- This manual contains cautions and instructions for safe use of the product. Please read it carefully before use and ensure appropriate use.
- This document illustrates the dangers of using this product without taking necessary precautions. Please refer to below symbols for different types of safety points.



CAUTION

Illustrates when misused, there are dangers of serious injuries or possible fatal accidents.



ATTENTION

Illustrates when misused, there are dangers of casualties or possible physical damage of the product.

- This document illustrates safety points to be kept using below symbols.



Illustrates specific conducts which are prohibited.



Illustrates specific guidelines which are enforced.

■ Precautions upon installing the product (Please read before installation.)



CAUTION

- ❗ Check the foundation base and strength of the material before installing this product. If not installed properly to the foundation base, there are dangers of it falling.
- ❗ Install a product as instructed with necessary quantity of brackets. If not the product may fall.



ATTENTION

- ❗ This product is intended for indoor use. Please do not use it for exterior purpose.
- ❗ Locations subject to high temperatures and high humidity, or areas where water may leak, should be avoided.
- ❗ Make sure to install a product horizontally.



■ Safety in Use (Please read thoroughly)



CAUTION

- ❗ Do not hang anything on this product or do not hang down. This may cause accident.
- ❗ Power source for this product is AC100V ~ 240V. Do not use any other power supply.
- ❗ This product supports our designated switch only. Do not use any other switch.
- ❗ Avoid any actions that may damage the power cord or plug. Using damaged components may result in electric shock, short circuits, or fire.
- ❗ Clean power plugs at regular intervals. Plugs exposed to moisture or to excessive dust may lead to insulation failures or cause fires.
- ❗ Avoid handling power plugs with wet hands. Doing so may result in electric shock.



ATTENTION

- ❗ When there is strong wind, please either close the window or have the curtain completely open.
- ❗ Please do not dismantle the mechanical assembly nor lubricate the moving parts of this product. This will ensure physical damage or malfunction of the product.
- ❗ To avoid breakage and malfunction, do not disassemble this product.
- ❗ Please do not use it by open flames.
- ❗ Around the area where the screen is to open and close, please remember to clear all objects which may break when placed around the screen.



Product view and parts names

■ Product view and parts names

● Rail Set (Without OT Splice)

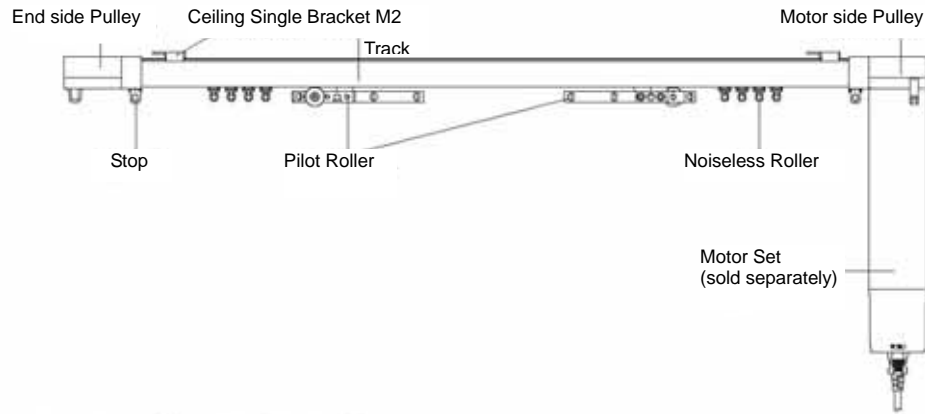

● Rail Set (With OT Splice)

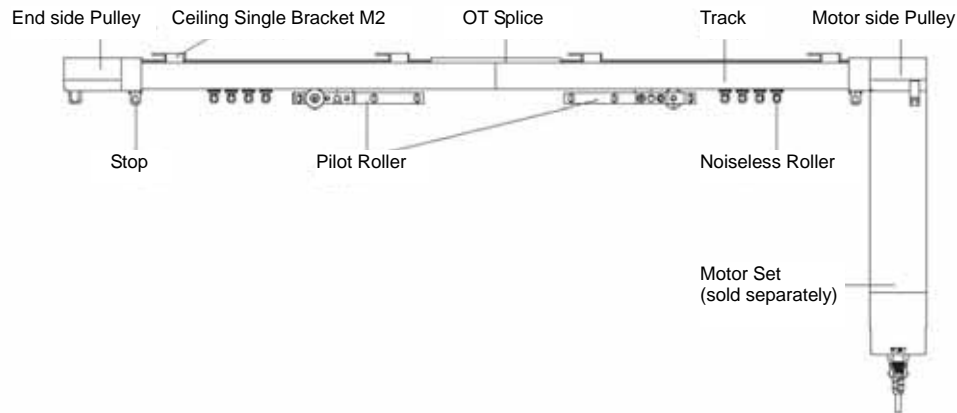

■ Attached Parts

● Ceiling Single Bracket M2

● OT Splice

● Splice Pin

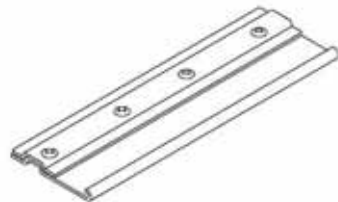
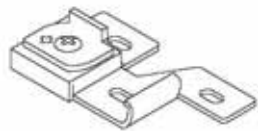

● Joint Plate
X 1 pc *



● Master Roller Arm
X 1 pc *

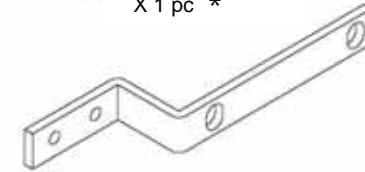

● Pilot Roller Plate with Wheel
X 1 pc *



● Pilot Roller fixation Screw
X 2 pcs *



● Noiseless Roller
10 pcs / m *



* For the Rail Set without a Joint, all parts are fitted to the Rail Set.

■ The number containing of attached parts

Specifications of Rail Set	Parts Name	1000	2010	3010	3510	4010	5010	6010	7010	8010	9010	9010
		~ 2000	~ 3000	~ 3500	~ 4000	~ 5000	~ 6000	~ 7000	~ 8000	~ 9000	~ 10000	
Straight	Bracket	4	5	6	8	8	10	12	14	15	17	17
	OT Splice	0	0	0	0	1	1	1	1	2	2	2
	Splice Pin	0	0	0	0	2	2	2	2	4	4	4
Single Curve	Bracket	5	6	7	7	9	11	13	15	16	18	18
	OT Splice	0	0	0	0	1	1	1	2	2	2	2
	Splice Pin	0	0	0	0	2	2	2	4	4	4	4
Two Curves	Bracket	6	7	8	8	10	12	14	17	18	19	19
	OT Splice	0	0	0	0	1	1	1	2	2	2	2
	Splice Pin	0	0	0	0	2	2	2	4	4	4	4
Gradual Curve	Bracket	4	5	6	8	10	10	12	-	-	-	-
	OT Splice	0	0	0	1	1	1	1	-	-	-	-
	Splice Pin	0	0	0	2	2	2	2	-	-	-	-

⚠ ATTENTION

❗ Fixing screws are not supplied for the Bracket. Select the appropriate screws suitable for the material of the base.

Installation and Disassembly Method

Installation Dimensions & Diagram

● Ceiling Single Attachment

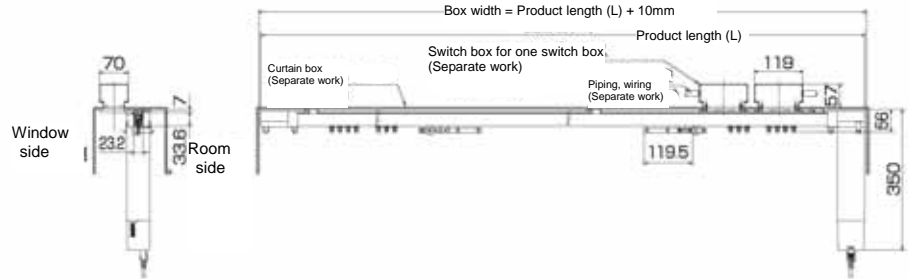
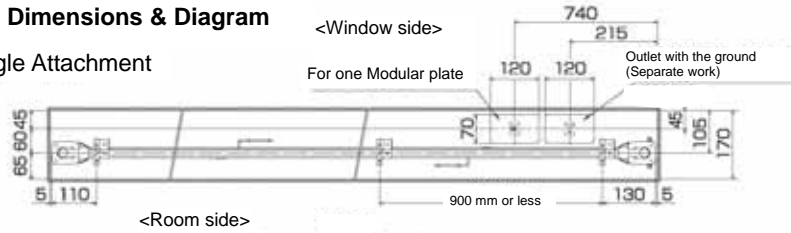

● Ceiling Double Attachment

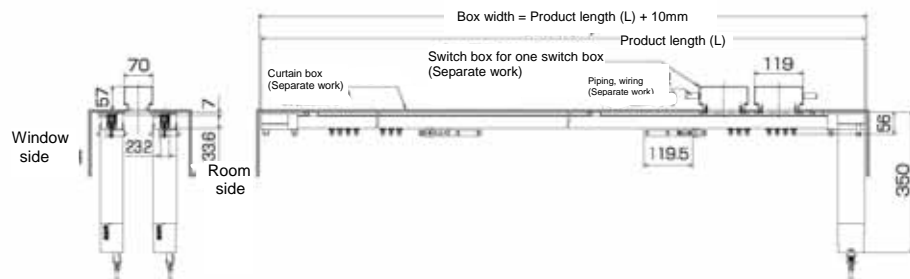
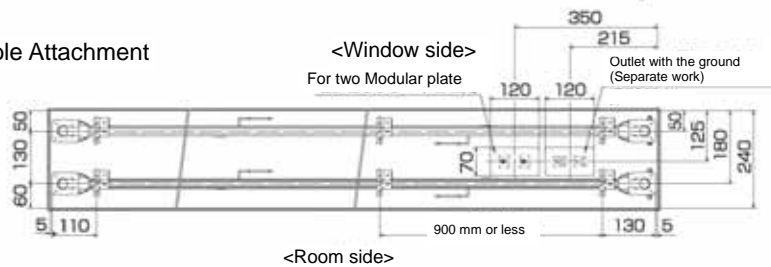

● Bracket Dimension

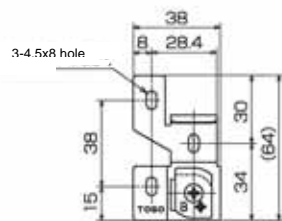

P. 6

How to assemble the Track (with OT Splice).

- For the Rail Set with OT Splice, join the Track by the procedure described below before fitting.

Loosen the OT Splice Screw and insert by sliding along the Track groove.

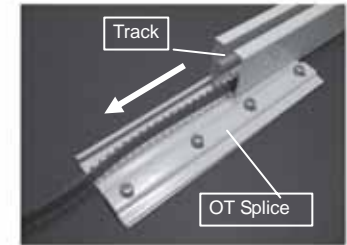

Insert the Splice Pin into the opening of a Track. (If insertion is difficult, tap with a wooden hammer or similar tool.)

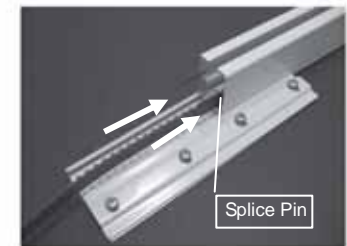

Insert the other Track into the OT Splice. (If insertion is difficult, cover the Pulley with a cloth and tap with a wooden hammer or similar tool.)

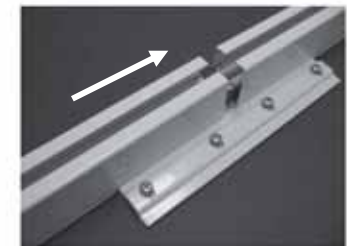

Position the Track so that the joint section is at the center of the OT Splice, then tighten the screws of the OT Splice.

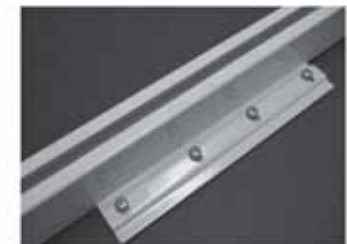

⚠ ATTENTION

- ❶ Check to confirm that the OT Splice is securely attached to the Track.

P. 7

Place the Pilot Rollers end to end.

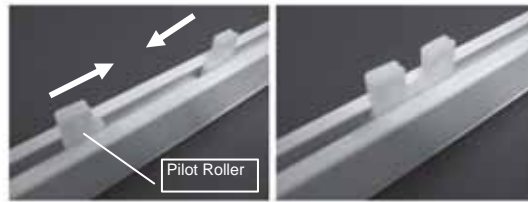

Use the Joint Plate to join the Pilot Rollers.

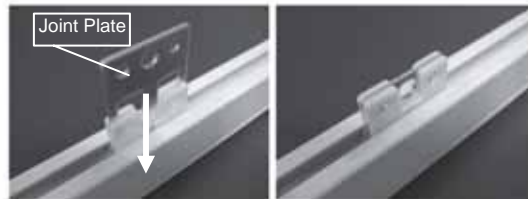

Fix Master Roller Arm and Pilot Roller Plate with Wheel with the Pilot Roller attachment screw.

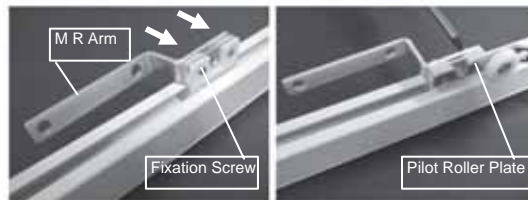

Use a screwdriver to loosen the Stop screw, then remove the Stop.



Insert Noiseless Rollers and secure the Stop into place.
(Two-way draw, insert the same number of Noiseless Rollers from the Pulley at both ends.)



ATTENTION

When securing the Stop into position, fit in such a way that the convex portion of the Stop fits into the concave portion of the Pulley. Align carefully; an improper fit may cause the Stop to fall off.

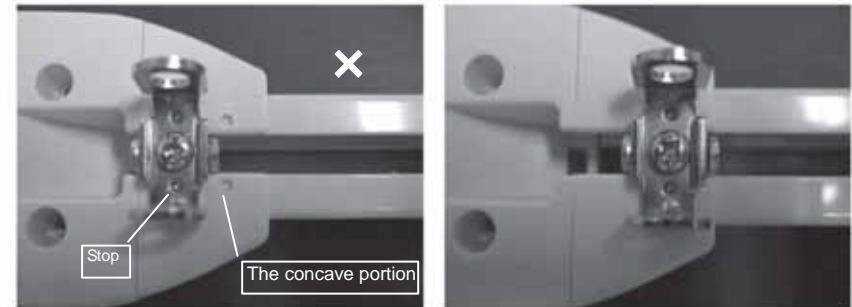

Location of Bracket

Refer to chart below, determine the locations of the Brackets.

For the Rail Set with OT Splice, fit Brackets to both sides of the OT Splice.

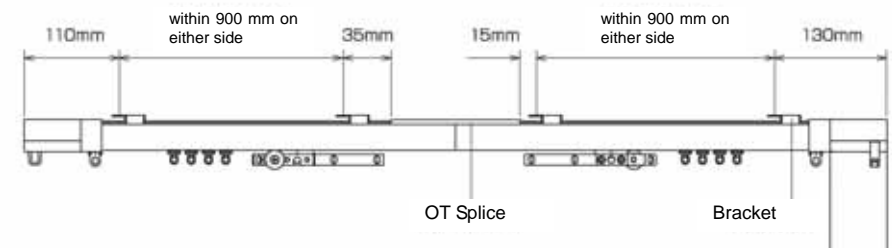

Installation method of the bracket

After attaching the Brackets to the product body, fit the Brackets to the mounting surface.

Loosen the Bracket screw and rotate the Fastener.



Insert by sliding along the Track groove, Nip the groove of the Track with the Fastener.

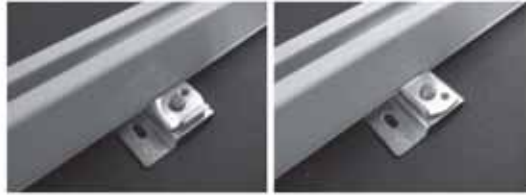

Tighten the screw to ensure firm attachment.



⚠ ATTENTION

- ❗ Check to confirm that the Brackets are securely attached to the Track.

■ Installation method of the product body

Insert cardboard pads in the Rail groove at 1m intervals.
(Use the cardboard pads used for packaging.)

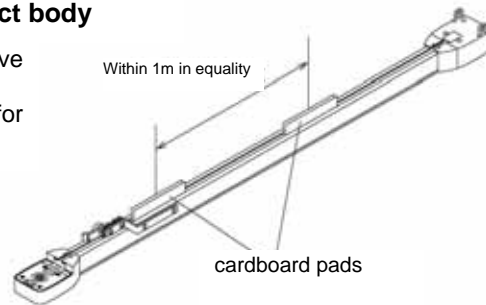

⚠ ATTENTION

- ❗ To keep the Belt from coming off, lift the Track only after inserting the cardboard pads.

Lift the Track and mount the product with the mounting screws.

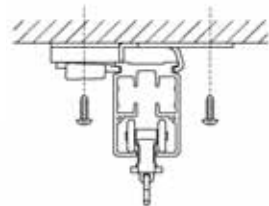

P. 10

⚠ ATTENTION

- ❗ For the Rail Set with OT Splice, this task should be performed by no fewer than two people.
- ❗ For the Rail Set with OT Splice, make sure the Joint part is adequately supported during the mounting process. The Product may fall off.
- ❗ Be sure to use four fixing screws or more for each bracket. Using too few screws may cause the Product to fall off at some point.

■ Installation method of the Motor

Loosen the Motor mounting screws, then insert the Motor into the Motor side Pulley while keeping the Motor mounting screws in place.



Tighten the Motor mounting screw, and fix the Motor surely.



⚠ ATTENTION

- ❗ Check to confirm that the Motor is securely attached to the Track. (Pull down on the Motor to confirm that it is securely mounted.)

■ Disassembly method of the Motor

Loosen the Motor mounting screws, and remove the Motor while pulling to keep the mounting screws clear.

■ Disassembly method of the Rail Set

While supporting the Track, remove the mounting screws for the Bracket and remove the Rail set.

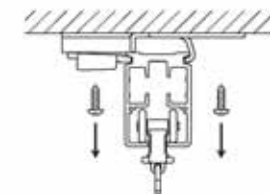

P. 11