

CURTAIN TRACK

ELITE

SINGLE SET/DOUBLE SET

C-04102201

Instruction manual

Thank you for purchasing this TOSO product.
Read this guide to ensure safety, and keep the guide handy for future reference.

Guide for Distributors and Installation Contractors

This guide provides instructions and cautions to ensure proper use of the product. **Be sure to give the guide to customers.**

⚠ Caution

- ⊘ The supplied bracket-mounting screws are screws that should be used for wood only.
- ❗ When installing the product, examine the strength and quality of the backing material underneath. If the product is not securely fastened to the backing material, the product may fall off.
- ⊘ Do not hang anything on the product or hang on to it in order to avoid damage to the product and prevent it from falling off.

General View of Product and Names of Parts

<Single Set>

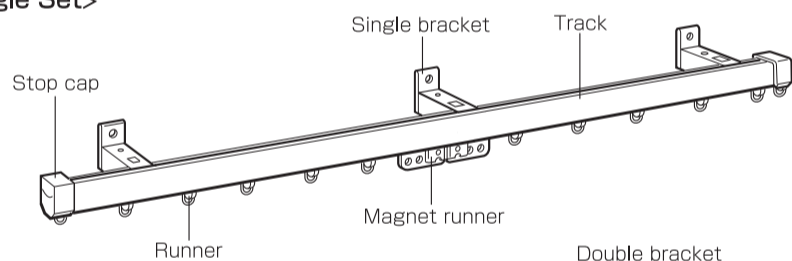

<Double Set>

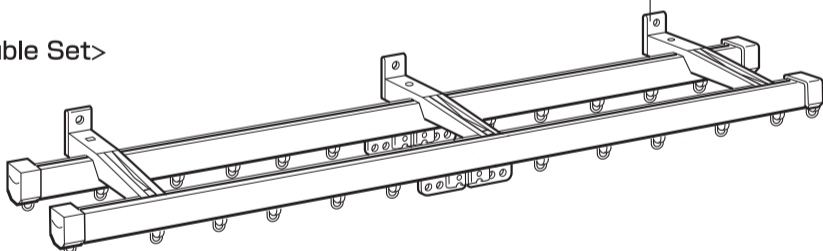

■ Parts Quantities(for 2.00-m Set)

Description	Single Set	Double Set
Track	1 pc (2.00 m)	2 pcs (2.00 m)
Stop cap	2 pcs	4 pcs
Runner	18 pcs	36 pcs
Magnet runner	1 pair	2 pairs
Single bracket	3 pcs	—
Double bracket	—	3 pcs
Mounting screw(pan head 3.5 x 20)	3 pcs	2 pcs

Elite/Single Set/Double Set

Installation

① We recommend that the track be approximately 10 to 20 cm longer than the window width, and that the distance from the end of the track to the nearest bracket be 10 cm or less. If the track is too long, cut it using a hacksaw.

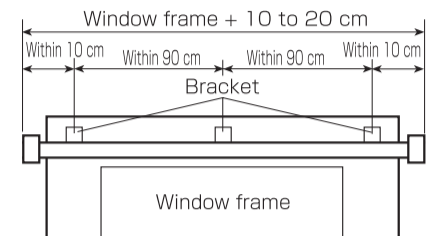

② Attach the required numbers of runners and magnet runners to the track. Fit the stop cap to each end of the track.

③ Mount the brackets on the wall or the window frame at regular intervals (within 90 cm).

⚠ Caution

- ❗ When mounting the brackets on the wall, pre-check what kind of backing material is used.

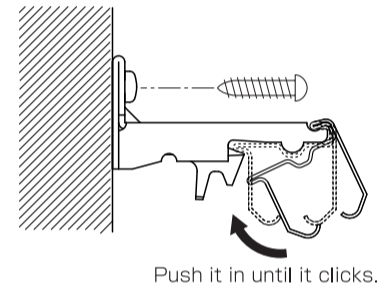

④ Hang the groove of the track on the bracket. Push the track in until it clicks.

<Dismounting the Track>

- Push in the plastic part of the bracket pull it toward you as indicated in (1), then dismount the track as in (2).

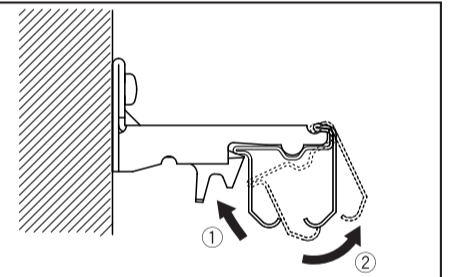

■ Mounting Dimensional Diagram (mm)

Mounting on a Single Bracket
(Bracket width: 18 mm)

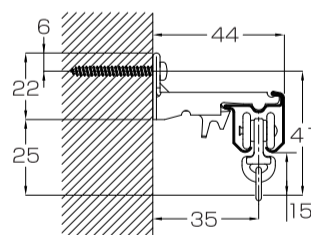

Mounting on a Double Bracket
(Bracket width: 18 mm)

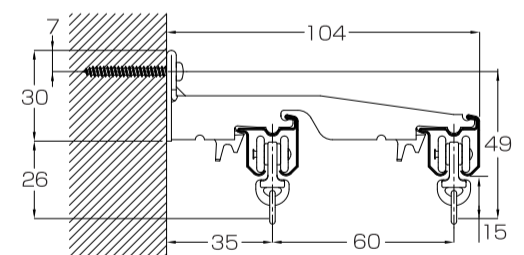

Maintenance

- ① Do not use a thinner or other chemical for cleaning, as they may discolor or deform the product.
- ② To clean the product, wipe it using a soft, dry, clean cloth.