

Flow



- The sophisticated symmetrical design and simple Fixed Hanger Rod stylishly divide any space.
- A truly noise-less finish—no visible hardware—creates a sense of refined elegance.
- Seamlessly compatible with wave style curtains for a wide range of sophisticated interior arrangements.

Flow

Flow's Unique Features and Applications

Ideal for partition applications

A clean, symmetrical form with no visual front or back makes this rail ideal for refined space division. The matte finish blends seamlessly into interiors, creating subtle boundaries that enhance the design.

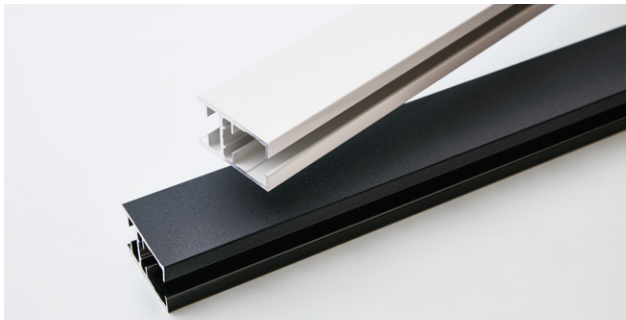

Dedicated support rod with a simple design

Suitable for high-ceiling spaces or areas with sprinkler systems, without interfering with water dispersion. Flow Fixed Hanger Rod is available in lengths from 250mm to 700mm, and can also be cut to length on-site as needed.



Concealed, noise-free components

Brackets, joints, and curtain stoppers are all built into the rail structure, ensuring a clean appearance with no visible hardware. The seamless finish maintains a refined design.

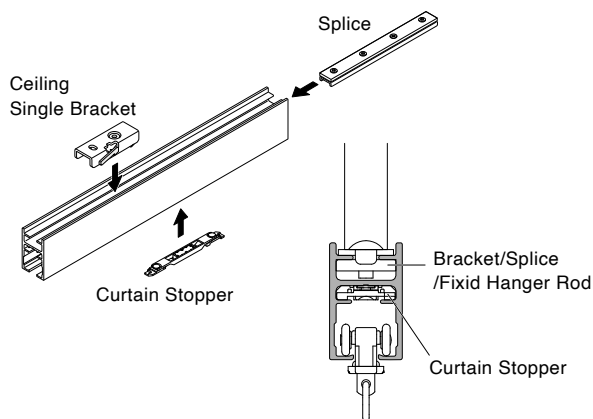

Flexible curves for spatial design

The curtain rail supports both L-shaped and gradual curved configurations, allowing for gentle, flowing space division.



Curve Application



Radius 180mm



Min. radius 800mm

Smart Wave Curtain System

Smart Wave Curtain System is the ideal curtain rail system for creating elegant wave curtains, allowing for the creation of beautiful wave patterns without exposing any pitch-keeper tape, preserving the design's integrity. When used as a curtain for glass partitions, it adds a gentle touch that softens the overall space. The system can be adapted to curved installations as well.

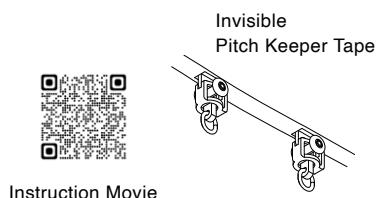

Instruction Movie



Comfortable curtain operation

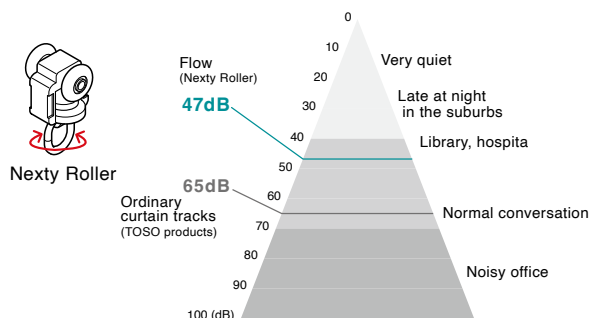

Wheeled rollers allow smooth gliding even over joints.
For quieter operation, Nexty Rollers help minimize curtain noise.

Side MG Carrier

The Side MG Carrier lets you draw in the curtains from either end of the rail.
Even with wide openings, the curtain can be operated smoothly from both ends.

*Please use the One-way MG Carrier as needed.

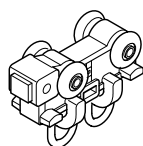

Curtain Stopper (patented)

Even curtains that tend to close automatically due to the fabric or interlining's tension can be kept open at any position you like, simply by installing a curtain stopper inside the rail.

*It can be used with Nexty Magnet Carrier and Smart Wave MG Carrier.

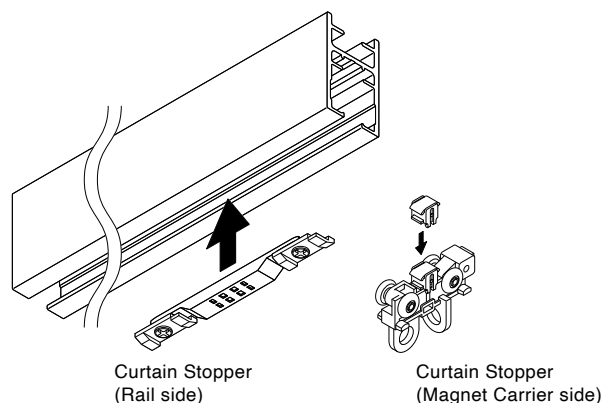

Required Parts and Quantities (For custom curved products)

L-shaped Rail

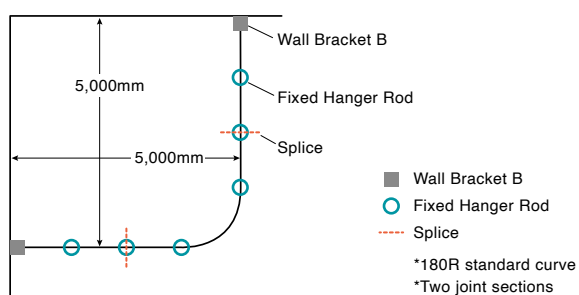

Required Quantity

Rail	10m (39")
Curve	1 point
Nexty Roller (8 pcs/m)	80 pcs
Nexty One-way MG Carrier	1 pc
Nexty MG Carrier	—
End Stop	—
Wall Bracket B	2 pcs
Fixed Hanger Rod (H250)	6 rods
Splice	2 pcs
Curtain Stopper	1 pc

Specified Overall Curve Angle with Straight Extension

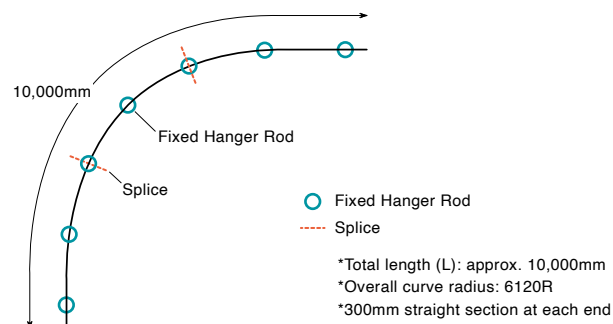

Required Quantity

Rail	10m (39")
Curve	3 points
Nexty Roller (8 pcs/m)	80 pcs
Nexty One-way MG Carrier	—
Nexty MG Carrier	1 pc
End Stop	2 pcs
Wall Bracket B	—
Fixed Hanger Rod (H250)	7 rods
Splice	2 pcs
Curtain Stopper	2 pcs

Materials and Finishes

Parts		Material	Finish
Rail	White	Aluminum alloy extrusion material	Almite white, Olefin resin coating film wrapping vinyl
	Black		Almite black, Chloride Resin coating wrapping
Roller (C Type and New Delac are common)	Plate	Hard polyethylene	—
	Wheel	Polyester elastomer	
	Oval ring	Stainless steel	
End Stop	Body	Acetal resin	—
	Adsorption plate	Steel	
Wall Bracket A, B		Steel	Coating
Ceiling Single Bracket		Stainless steel	—
Curtain Stopper		Acetal resin, magnet	—
Fixed Hanger Rod	Pipe	Aluminum	Coating
	Base	ABS resin, Steel	—

Bracket Installation Interval and Allowable Curtain Load

*Please fix the joint sections using Fixed Hanger Rods or brackets.

*When installing on a system ceiling, ensure that a supporting base is provided.

When Using Fixed Hanger Rods

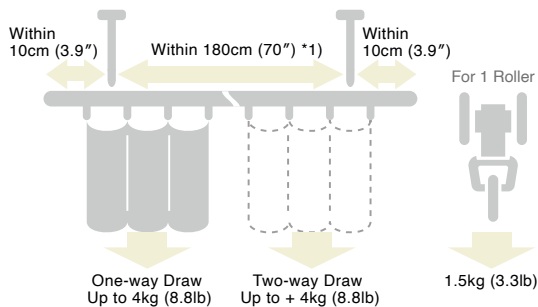

When Using Ceiling Brackets

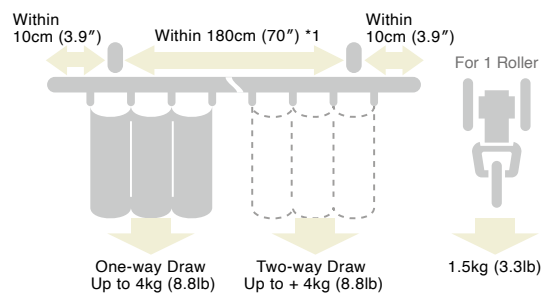

*When used in medical facilities such as hospitals, please ensure that patients do not grab onto the curtains and put their weight on them. Exceeding the load capacity may cause the curtain rail to detach.

*For an installation pitch of 180cm, the maximum weight is 4kg (8.8lb) for a one-way draw, and an additional 4kg (8.8lb) for a two-way draw.

- *1) For fixed Fixed Hanger Rods L=500mm and L=700mm:
- Secure the rods at intervals of 100cm or less.
 - For end sections, secure with wall brackets or with two Adjustable Hanger Rod A.
 - If end section fixation is not possible, use at least three Fixed Hanger Rods for the entire length when using fixed Fixed Hanger Rods of L=500mm (with intervals of 100 cm or less).
 - For fixed suspension rods of L=700mm, use at least four Fixed Hanger Rods for the entire length (with intervals of 60cm or less).

Installation Dimensions

Ceiling Attachment

Ceiling Single Bracket

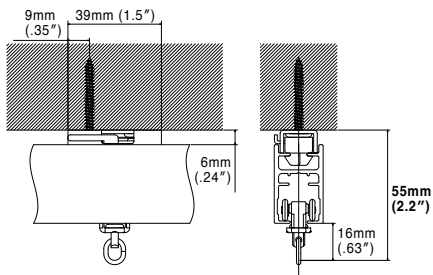

Direct attachment

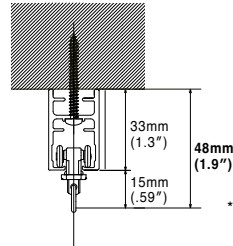

*Mounting holes are not provided.
On-site processing is required.

Wall Attachment

Wall Bracket A

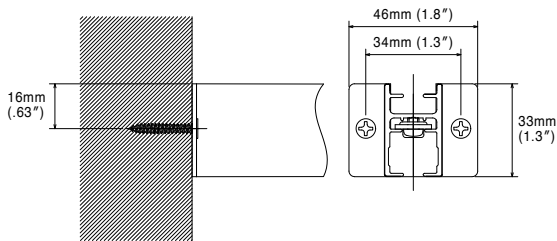

Wall Bracket B

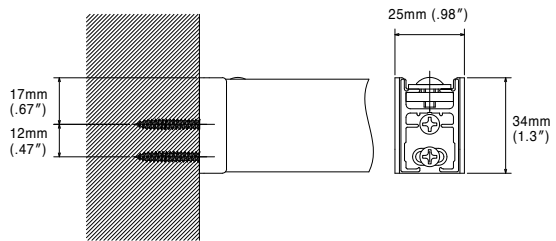

Fixed Hanger Attachment

Fixed Hanger Rod

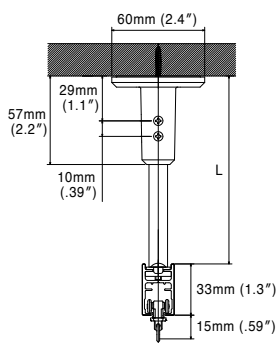

Adjustable Hanger Rod A

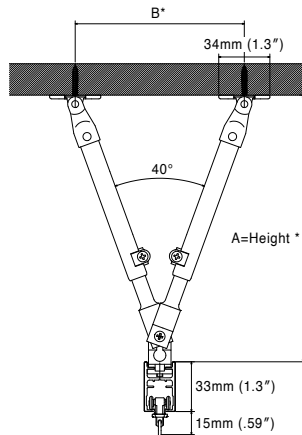

*For dimensions A and B, please refer to Partrac II, page 7.

*The "White" color of Adjustable Hanger Rod A and the "White" color of Flow differ in shade.

End Cap

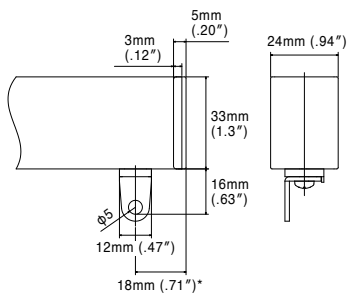

*Dimensions when the intermediate stopper is positioned at the end.

Intermediate Stop

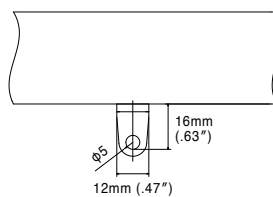

Installation Method

How to Install the Fixed Hanger Rods

The spacing for installation varies according to the length of the Fixed Hanger Rods. The rods can also be cut to length at the site as needed.

● Installation with Fixed Hanger Rods only

Length of Hanger Rod	Maximum Mounting Interval	Minimum Required Quantity
L250	1,800mm (71")	2 pcs
L350	1,800mm (71")	2 pcs
L500	1,000mm (39")	3 pcs
L750	600mm (24")	4 pcs

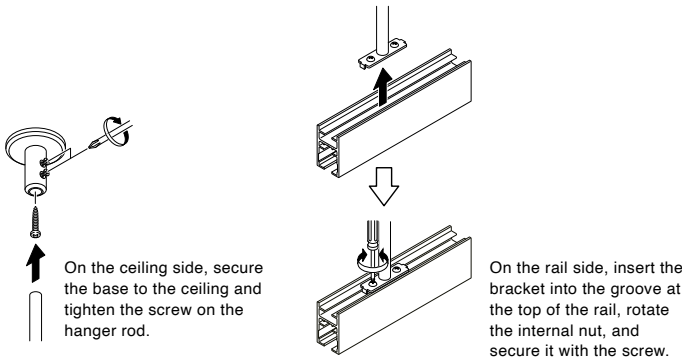

How to Install the Ceiling Brackets

The ceiling single bracket uses a clamp mechanism that is hidden from below. To install, push the rail upward from underneath and secure it by rotating the arm.

*There will be a 6mm gap between the ceiling surface and the top of the rail.
*This product does not have a temporary holding function.
Please have at least two people for installation.

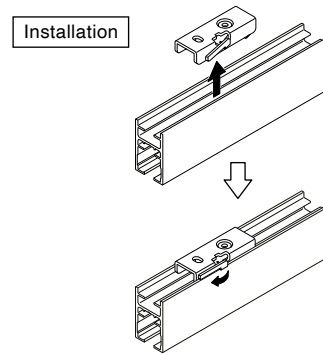

How to Install the Wall Brackets (A and B)

If both ends can be attached to the wall, use wall brackets to install the rail. Wall Bracket A is fixed from the outside of the rail, while Wall Bracket B has concealed screws.

(Wall Bracket B cannot be installed close to the ceiling.)

● If both ends can be secured to the wall

Length of Hanger Rod	Maximum Mounting Interval
L250	1,800mm (71")
L350	1,800mm (71")
L500	1,000mm (39")
L750	1,000mm (39")

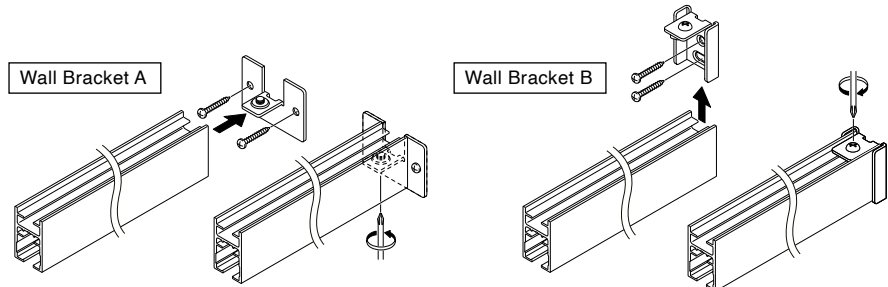

How to Install the Hanger Rods on Curved Rails

When partitioning with curved rails, be sure to support the corners with a Fixed Hanger Rod.

Fixed Hanger Rods can be attached to gentle curves with a radius of 800mm or more, but cannot be used on standard curves with a 180mm radius.

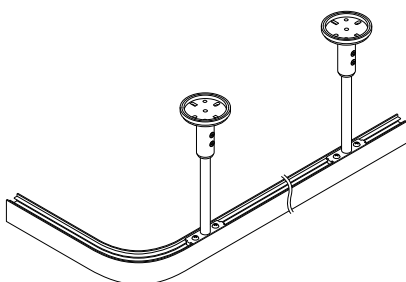

How to Install the Intermediate Stop

The Flow rail does not have a stopper function in the cap or brackets. If you want to secure the curtain at the end, use an intermediate stop.

(If you are using a New Delac Roller or New Delac Silent Roller, be sure to use the exclusive after-insert intermediate stop designed for New Delac)

How to install the Intermediate Stop

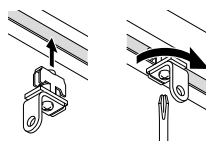

Insert it into the groove of the curtain rail, rotate it 90 degrees, and secure it with a screw.

How to use with the MG Roller

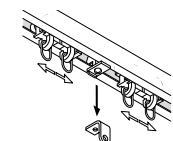

If you want to use the magnet function of the roller please remove the plate.

Flow Rails

White



Black

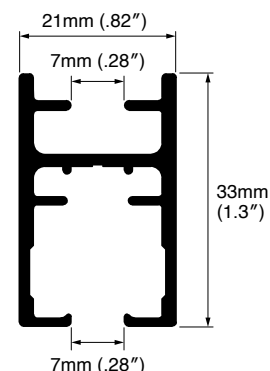

	Size	Product Code	
		White	Black
Rail	1.82m (72")	30020054	30020049
	2.00m (79")	30020055	30020050
	3.00m (118")	30020056	30020051
	4.00m (157")	30020057	30020052
Curved Rail (180mmR / 7.1"R)	1.0m X 1.0m (39" X 39")	30020058	30020053

Nexty Parts

Product Name			Product Code
Rollers	Nexty Roller (8 pieces per strip)	Natural	03572457
		Black	30020026
	Nexty MG Carrier	Natural	03570037
		Black	30020027
	Nexty One-way MG Carrier	Natural	03570038
		Black	30020028
End Stops	End Cap	White	30020031
		Black	30020030
	Nexty Intermediate Stop		30009041
Brackets	Ceiling Single Bracket		30020041
	Wall Bracket A	White	30020043
		Black	30020042
	Wall Bracket B	White	30020045
		Black	30020044

Product Name			Product Code
Other Parts	Splice		30020040
	Curtain Stopper		30020048
	Fixed Hanger Rods	250 250mm (9.8")	Natural 30020033
			Black 30020032
		350 350mm (14")	Natural 30020035
			Black 30020034
		500 500mm (20")	Natural 30020037
			Black 30020036
		700 700mm (28")	White 30020039
			Black 30020038
	Overhead Hanger B	White	30020047
		Black	30020046

Smart Wave Curtain System Dedicated Parts for Flow

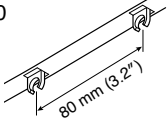
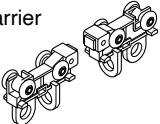
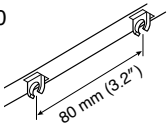
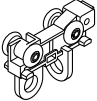
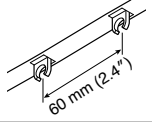
Product Name			Product Code		Product Name			Product Code	
Rollers		Smart Wave Roller (8 pieces per strip)	Natural	30018621	Other Parts		Invisible Pitch Keeper Tape 80 (15m)	30018624	
			Black	30020020					
		Smart Wave MG Carrier	Natural	30018622			Invisible Pitch Keeper Tape 80 (50m)	30018625	
			Black	30020021					
		Smart Wave One-way MG Carrier	Natural	30018623			Invisible Pitch Keeper Tape 60 (50 m)	30019302	
			Black	30020022					

