

Troubleshooting

■ Before you decide that the trouble is a malfunction, perform the following check.

Condition	Possible Causes and Solution
Not operating	● The power cord plug is not connected. ⇒ Switch the Progress Motor Set to on (AC 100-240V).
	● The wire from the switch is not connected to the Motor Set. ⇒ Refer to "Wiring Method" on page 6 and connect appropriately.
	● The Infra-red Receiver is not installed to enable remote control. ⇒ Refer to "Wiring Method" on page 6 and connect appropriately.
	● Address of motor set is not correctly set. ⇒ Refer to "Address Setting Switch" on page 12 and set the address.
	● In case of FM remote control, wiring from receiver 2.4G with IR terminal is connected to "SW". ⇒ Connect to "IR".
	● In case of FM remote control, the receiver has no address setting. ⇒ Refer to Instruction manual of FM Receiver and set the address.
	● No connection is in place between the interior wiring and the switch or the modular outlet. ⇒ Refer to "Connection Method" on page 9 and connect appropriately.
Unstable operation	● In case of remote control, the battery is not in the FM transmitter. ⇒ Install batteries in the transmitter.
	● Batteries are old. ⇒ Replace old batteries with new batteries.
	● Inverter light is used near the Infra-red Receiver. ⇒ Remove the Infra-red receiver from the inverter light.
	● Infra-red Receiver is under the sun light. ⇒ Remove the Infra-red receiver to a location with no sun light.
	● There is an obstacle blocking the curtain. ⇒ Remove the obstacle before the curtain in the opening/closing position.
● Connection between the interior wiring and the switch or the modular outlet is loose. ⇒ Refer to "Connection Method" on page 9 and connect appropriately.	
Moves adversely and in opposite direction	● The rail is not assembled correctly. ⇒ Refer to "Instruction Manual" of Rail Set and assemble appropriately.
	● The switches and interior wiring are not connected correctly. ⇒ Exchange the red and green cables and reconnect.
	● The interior wiring and Modular outlet are not connected correctly. ⇒ Exchange the red and green cables and reconnect.
Operation speed is low	● Opening/closing is set to the slowest speed. ⇒ Refer to "Setting Method of the various switches" on page 11 and change to a more suitable speed.
	● The instruction has not been completed. ⇒ Refer to "Limit Setting Method" on page 13 and completely finish the Limit Setting Method (instructive operation)
Movement speed after having spent a power supply is low	● The various setting switch No.4 is turned ON. ⇒ Turn off the switch No.4.
Operates only while pushing the button	● The value set here corresponds to two-button operations. ⇒ Turn off the No.1 setting switch.
Curtain moves automatically when force opened manually.	● The various setting switch No.3 is turned on and Touch-motion functions is set. ⇒ Turn off the switch.

TOSO

Motorized Curtain Tracks

Progress 25·50 Motor Set

No.N-110014E

Instruction Manual

Thank you for purchasing TOSO products. To ensure safe use of this product, please read the following thoroughly and keep this manual stored.

Guide for Distributors and Installation Contractors

This manual contains information for a user to safely operate this product. Please provide this manual to a customer.

INDEX

■ Caution	2
■ Product View and Part Names	4
■ Wiring Method	6
■ Connection Method	9
■ Connecting the various switches	11
■ Setting Method of the various switches	11
■ Limit Setting Method	13
■ Check the Operation	13
■ Product Specification	15
■ Cleaning	15
■ Disposal of Packing Materials	15
■ Troubleshooting	16

CAUTIONS

* This manual contains cautions and instructions for safe use of the product.
Please read it carefully before using to ensure appropriate use.

● **This document illustrates the dangers of using this product without taking necessary precautions. Please refer to the symbols below for different types of safety points.**

 **Warning** Illustrates that if this product is misused, there are dangers of serious injuries or possible fatal accidents.

 **Caution** Illustrates that if this product is misused, there are dangers of casualties or possible physical damage of the product.

● **This document illustrates safety points to be followed using the symbols below.**

 Illustrates specific actions which are prohibited.

 Illustrates specific guidelines which must be followed.

■ **Precautions upon installing the product (Please read before installation.)**

 **Warning**

- ❗ Check the foundation base and strength of the material before installing this product. If not installed properly to the foundation base, there are dangers of it falling.
- ❗ Install this product as instructed with the necessary quantity of brackets. Otherwise the product may fall.
- ❗ This is a class A product. In a domestic environment, this product may cause radio interference in which case the user may be required to take adequate measures.

 **Caution**

- ⊘ This product is intended for indoor use. Please do not use it for outdoor purposes.
- ⊘ Locations subject to high temperatures and high humidity, or areas where water may leak, should be avoided.
- ❗ Make sure to install this product horizontally.



■ **Safety in Use (Please read thoroughly)**

 **Warning**

- ⊘ Please do not hang from or pull on this product. This may damage the product or cause it to fall down.
- ⊘ This product requires an AC 100–240V power source. Do not use any other power source.
- ⊘ Unplug the power cord from the outlet if the product will not be used for a long time.
- ⊘ Avoid any actions that may damage the power cord or plug. Using damaged components may result in electric shock, short circuits, or fire.
- ⊘ Clean power plugs at regular intervals. Plugs exposed to moisture or to excessive dust may lead to insulation failures or cause fires.
- ⊘ Do not touch the product with a wet hand as there are danger of electrical shock.
- ⊘ This appliance is not intended for use by persons (including children) with reduced physical, sensory or mental capabilities, or lack of experience and knowledge unless they have been given supervision or instruction concerning use of the appliance by a person responsible for their safety.



 **Caution**

- ⊘ When there is strong wind, please either close the window or have the curtain completely open.
- ⊘ Please do not dismantle the mechanical assembly nor lubricate the moving parts of this product. This will ensure physical damage or malfunction of the product.
- ⊘ To avoid breakage and malfunction, do not disassemble this product.
- ⊘ Please do not use it by open flames.
- ⊘ Around the area where the screen is to open and close, please remember to clear all objects which may break when placed around the screen.



Product View and Part Names

Product View · Part Names

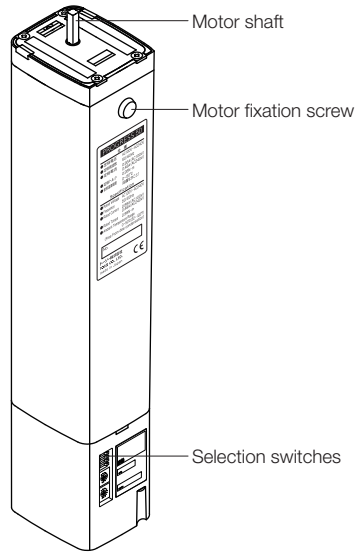

Progress25 · 50 Motor Set Dimension (mm)

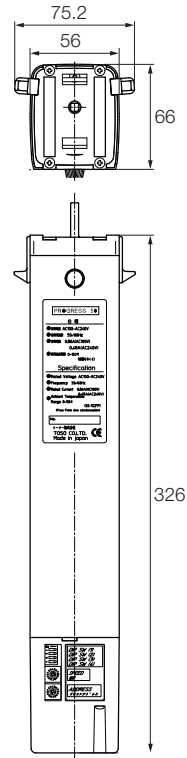

Accessories

- Curtain Hook x 2pcs

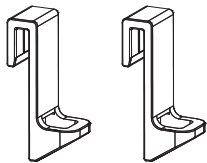

- Power cord 1 m x 1

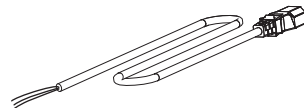

Optional (Sold separately)

- Infra-red Receiver 01

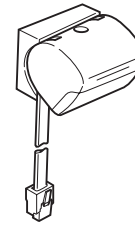

- Transmitter 01N

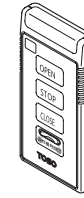

- Transmitter 02



- 3 button switch (Wide switch plate + Inlay wide switch 3 button A)

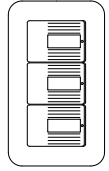

- Modular Plate for Single (6 poles)

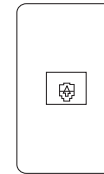

- Modular cord (1 m) (6 poles)

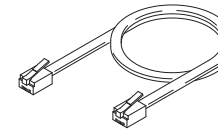

- FM Remote-control transmitter 2.4G (mm)

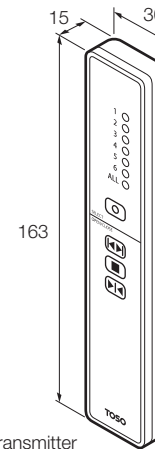

- FM Remote-control receiver 2.4G with IR terminal (mm)

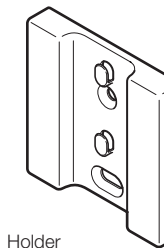
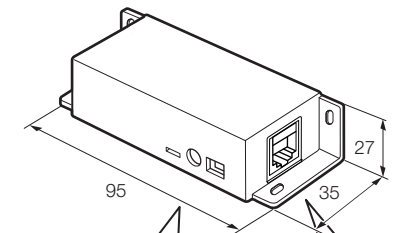

Transmitter

Holder

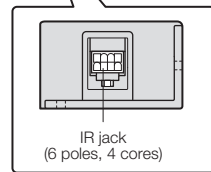
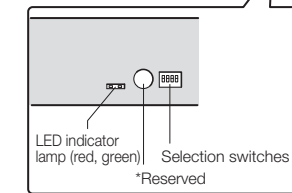

Wiring Method



Caution

- ❗ Be sure to consult with a TOSO representative and an electrician before installing power cables/operation cables. In addition, hire an electrician to install and connect cables.
- ❗ Entrust the wiring and connection work to the electrical contractor.
- ⊘ While the connection work is underway, do not activate the power. Failure to observe this precaution may lead to electric shock.

Individual operation

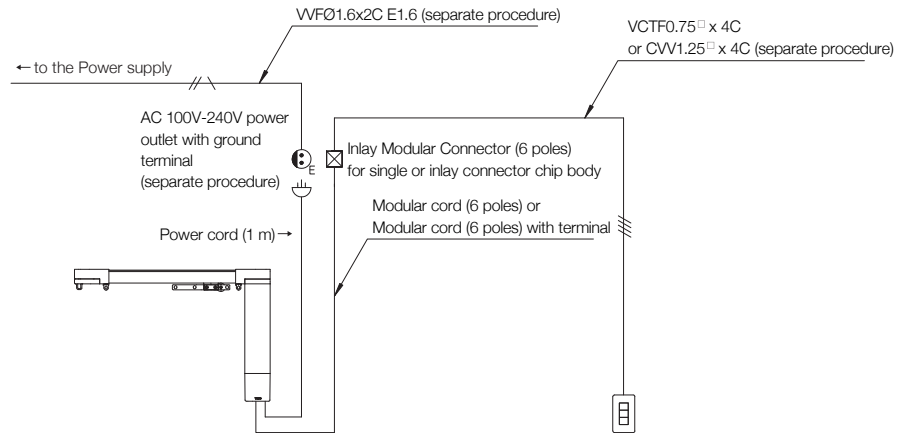

Two-point operation

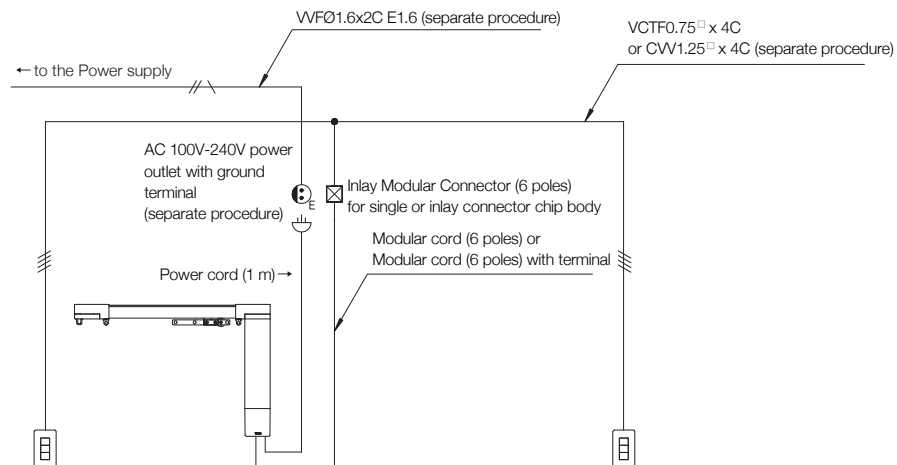

Simultaneous operation

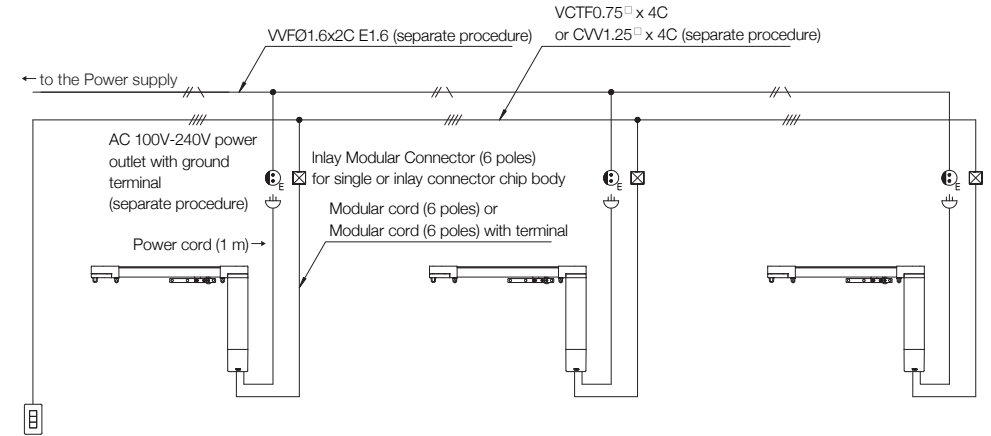

Simultaneous selective operation

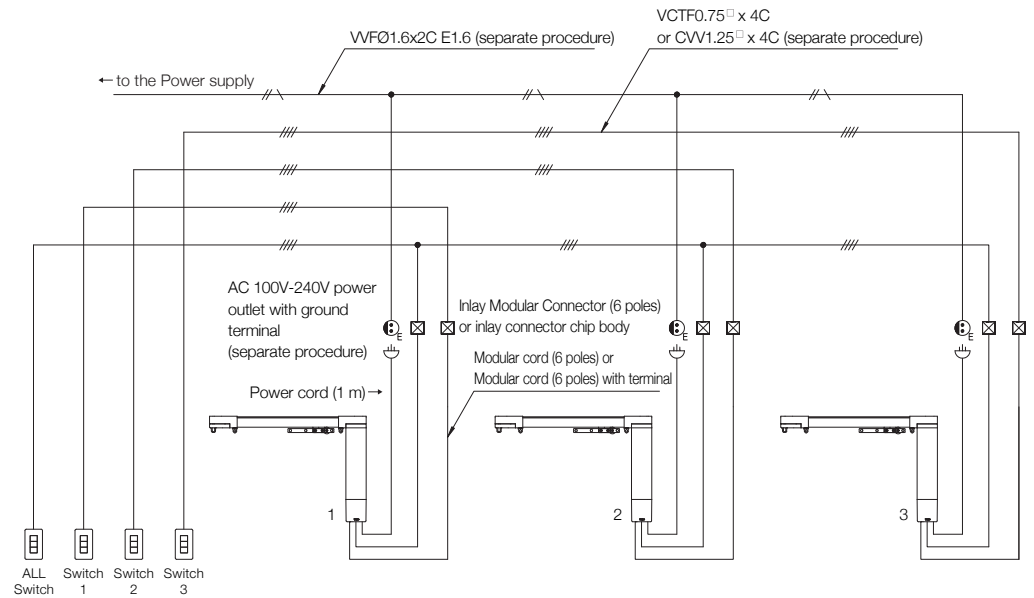

Infrared remote control operation

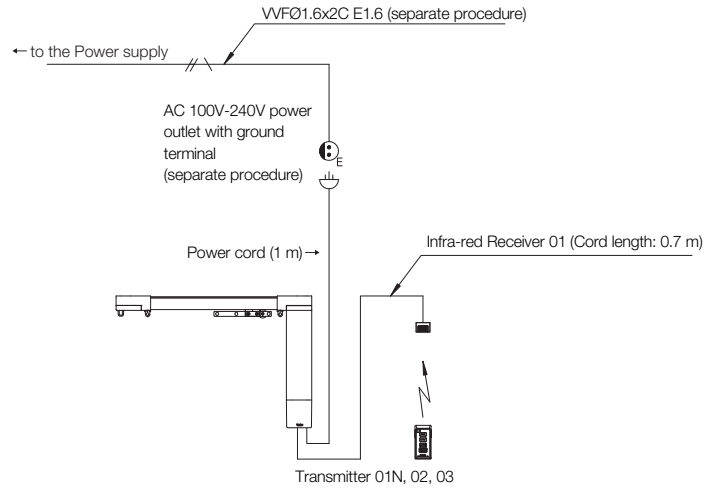

FM remote control operation

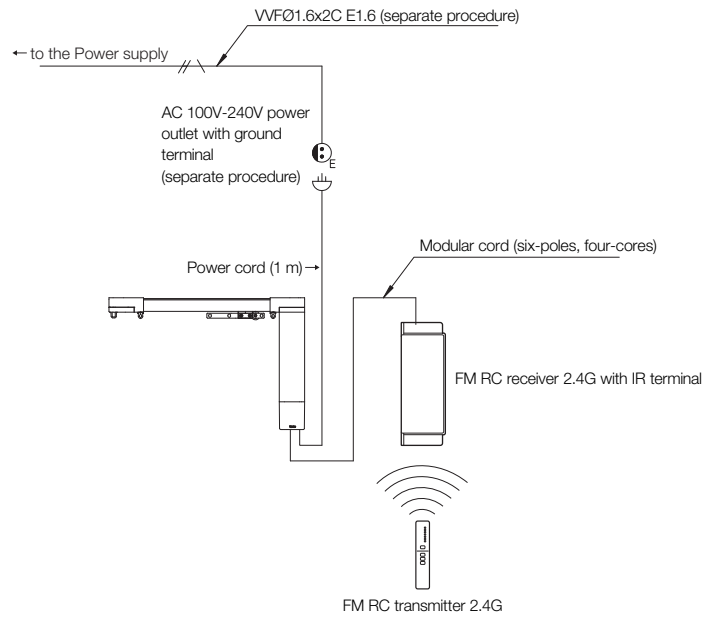

Connection Method



Caution

- ⚠ Be sure to consult with a TOSO representative and an electrician before installing power cables/operation cables. In addition, hire an electrician to install and connect cables.
- ⚠ Entrust the wiring and connection work to the electrical contractor.
- ⊘ While the connection work is underway, do not activate the power. Failure to observe this precaution may lead to electric shock.

Individual operation

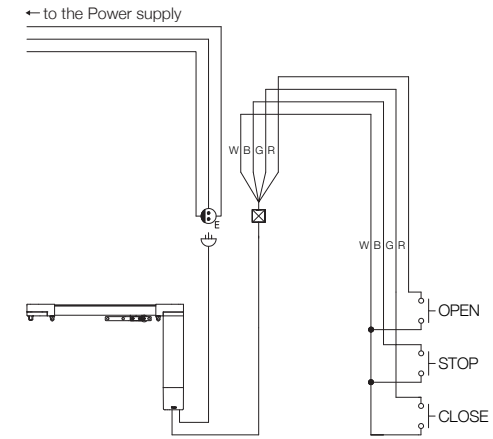

W : White
B : Black
G : Green
R : Red

Two-point operation

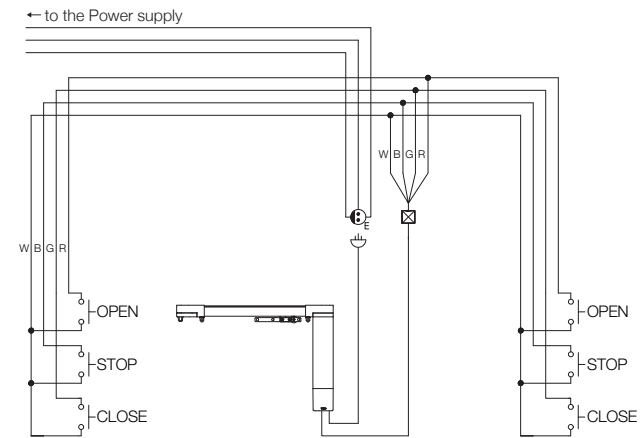

W : White
B : Black
G : Green
R : Red

Simultaneous operation

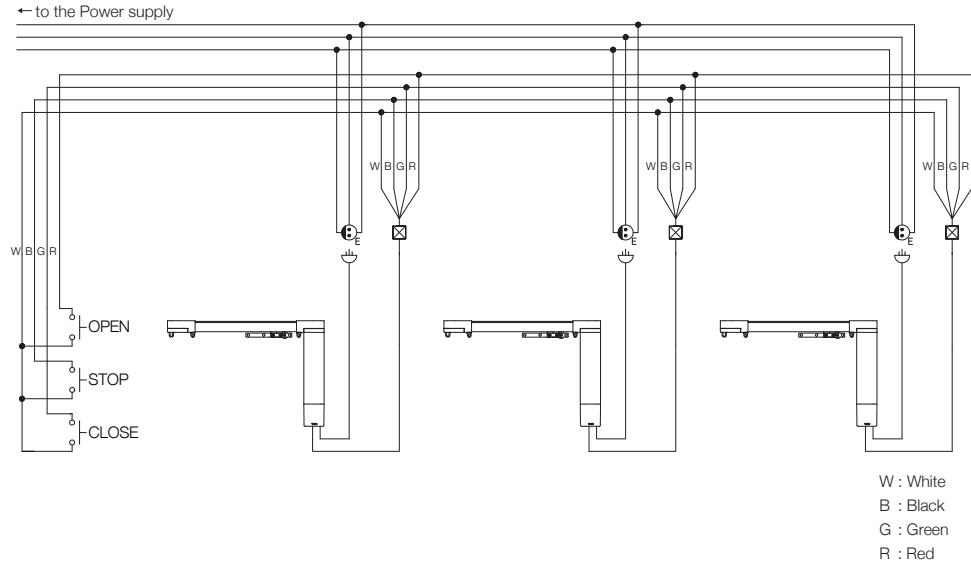

Simultaneous selective operation

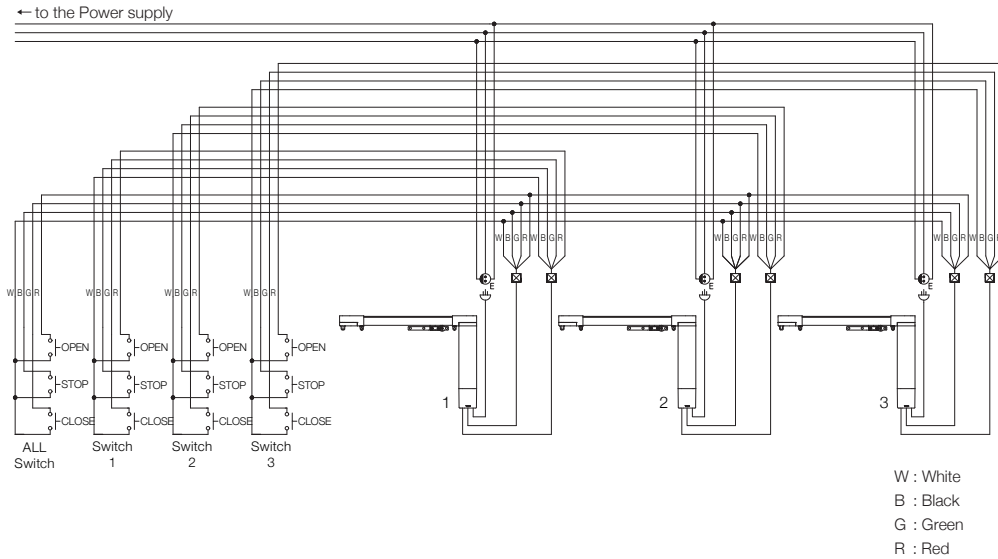

Connecting the various switches

● Follow the procedures illustrated in the figures below to connect the various switches to the main unit.

<3 Button Switch and TIOS Single Switch>

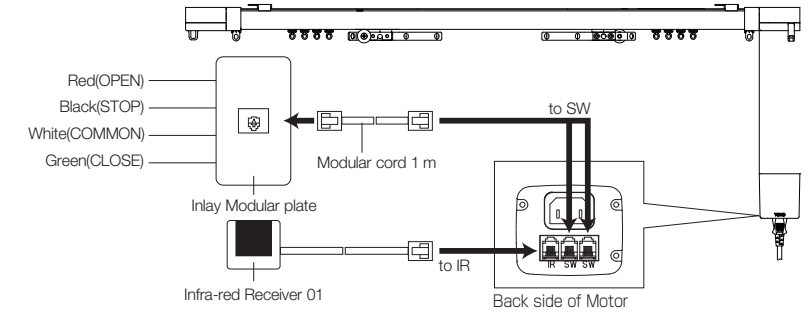

<FM Terminal>

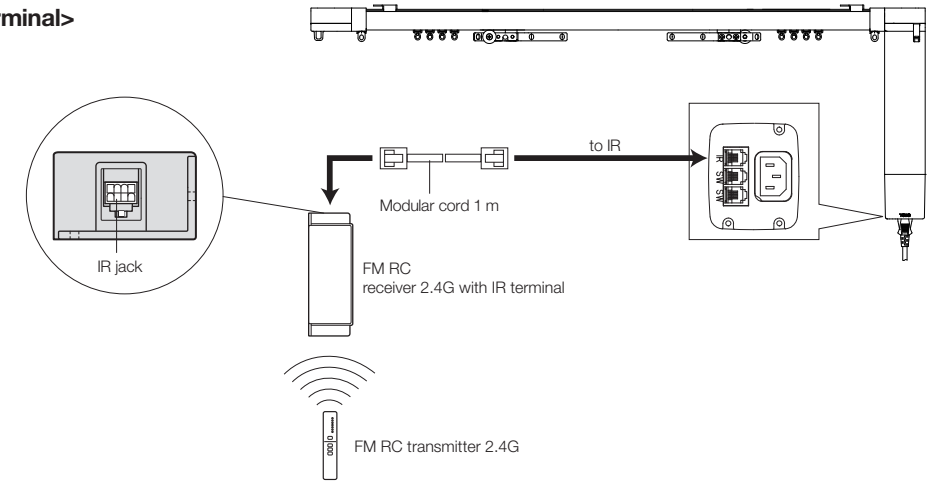

Setting Method of the various switches

● Basic operating parameters or controls, including speed settings, can be set or controlled using the switches on the Motor unit.

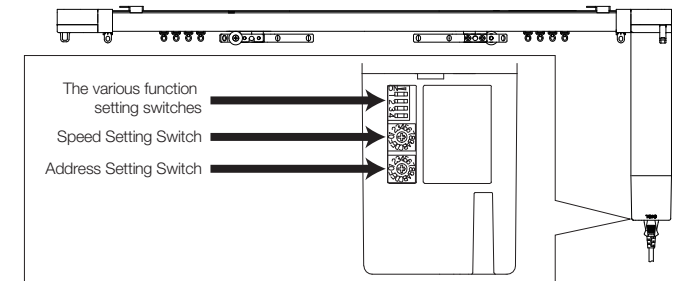

Function Setting of DIP Switch

- The control switches are used to set the functions for various operating switches.
- When shipped, all switches are set by default to their OFF positions.

	Functions to be set	ON	OFF
Switch 1	The setting operations of Two-button and three-button	Two-button	Three-button
Switch 2	The setting operation of self hold circuit on Two-button	Function to be set	Function to be not set
Switch 3	Enables/disables Touch-motion functions *	Enable	Disable
Switch 4	Initializing the Limit Position Memory	Initialization	Normal

<About the Touch-Motion Function>

- Touch-Motion Function enables opening/closing of curtains without using any switch operations.
- By pulling the curtain (Pilot Runner will move 5cm), the curtain will move (motor will operate in the corresponding direction) and stop at Limit Position.

* Switch 1 :ON Switch 2: OFF setting (two button operations/ no function) will disable Touch-Motion function. Apply a different setting.

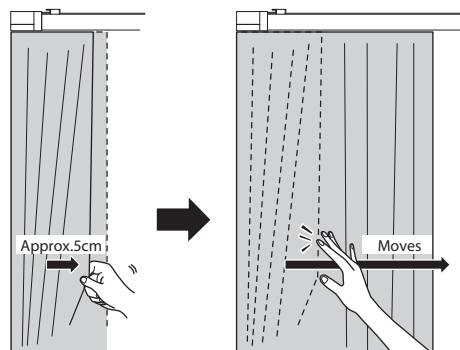

Caution

- ! Always operate with the switch when you want to stop the curtain track. Forcibly pulling the curtain will cause damage.

Speed Setting Switch (sec./m)

- Switch for changing the opening/closing speed for the curtain.
- The speed setting switch are set by level "5" when the unit is delivered. (* speed changes by the weight of curtain.)

Speed level	0	1	2	3	4	5	6	7	8	9	A	B~F
Progress 25 Motor	10	9.5	9	8.5	8	7.5	7	6.5	6	5.5	5	—
Progress 50 Motor	9.5	9	8.5	8	7.5	7	6.5	6	5.5	5	4.5	—

Address Setting Switch

- Switch for setting the address for FM Transmitter 01N, 02.
- When using FM Transmitter 01N, set within the range of 1 to 10.
- When using FM Transmitter 02, set within the range of 1 to 2.

1	2	3	4	5	6	7	8	9	A	B~F · 0
1	2	3	4	5	6	7	8	9	10	—

* In case of FM remote control 2.4G, please refer to "Instruction Manual" of FM Receiver 2.4G and set the address.

Limit Setting Method

- When powered on, the system executes an instruction that automatically detects the full opening/closing position (Limit Position) of the curtain. Always confirm that this instruction is performed before use.

Limit Setting Method (instructive operation)

- 1 Switch the Progress Motor ON.
- 2 Press the OPEN or CLOSE button of remote controller or button switch.
- 3 Pilot Roller will move in the full-closing direction and stop after reaching the full-closing position.
- 4 After stopping at the full-closing position, Pilot Roller automatically moves in the full-opening direction and stops at the full-opening position, thereby completing the instruction.

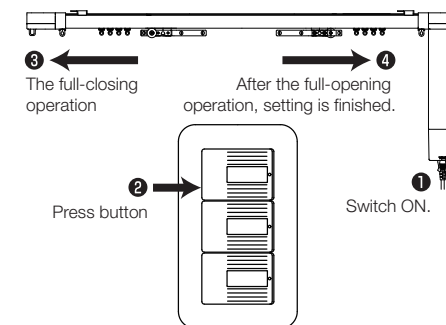

Caution

- ! Please always start the instruction with the curtain hanging condition.
- ! Be sure to run the instruction sequence with the product installed on the Rail Set. Note that Pilot Runner will move at the slowest speed while executing the command. This does not indicate an error or a defect.
- ! If the process is interrupted in this way, issue the command once again. Note that the system will not recall the Limit Position if power is interrupted or the process is otherwise aborted while the command is being executed. (Once this command is completed, the Limit Position will be recalled even if power is interrupted.)

An initialization of Limit Setting Method

- The Limit Position can be set to assume a new value when curtains are replaced or in the event of another action.

- 1 Turn on the No. 4 of the various setting switch.
- 2 Turning power OFF will initialize the Limit Position.
- 3 Turn off the No. 4 of the various setting switch.
- 4 Turn power back ON.
- 5 Run the instruction once again to set the Limit Position.

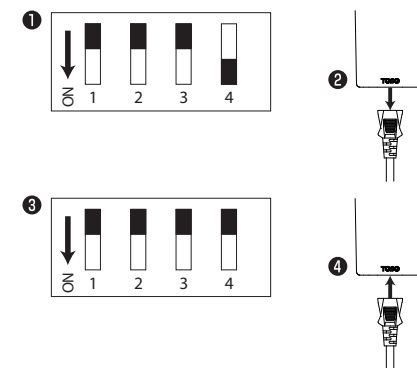

* For detailed information on the various setting switches, refer to "Setting Method of the various switches" described on P11.

Check the Operation

- 1 Switch the Motor Set ON.
- 2 If you have not yet executed the instruction, do so now and set the Limit Position.
- 3 Operate using each switch and check the operation.

<Check the Operation with 3 Button Switch>

① To open and close the curtain, press the OPEN or CLOSE button.

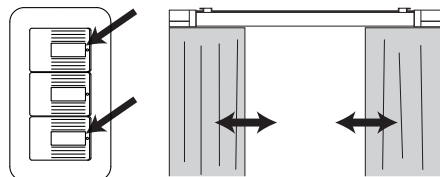

② To stop the curtain half way, press the STOP button.

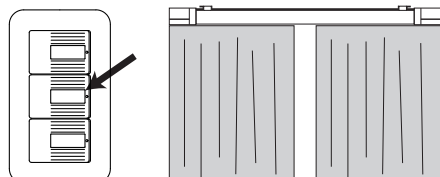

<Check the Operation with Transmitter 01N, 02 >

■ For operations in which the operating address is specified.

① Specify the Address No. registered for the product you want to operate.

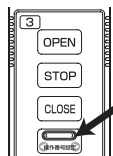

② To open and close the curtain, press the OPEN or CLOSE button.

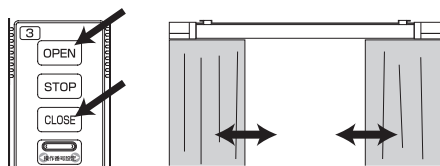

③ To stop the curtain half way, press the STOP button.

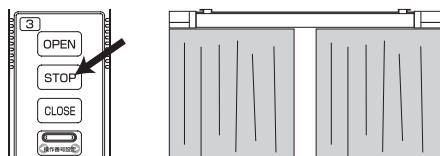

■ To execute an operation for all product addresses

① Specify ALL.

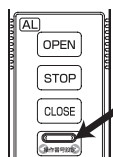

② To open and close the curtain, press the OPEN or CLOSE button.

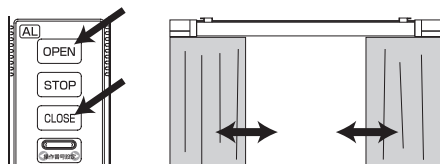

③ To stop the curtain half way, press the STOP button.

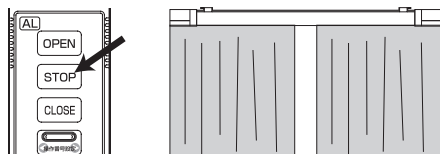

<Check the Operation with Transmitter 03>

① Press the button to repeat the following motion.
OPEN → CLOSE → OPEN → CLOSE

② Press the button once again to interrupt the motion. Press the button yet again to resume movement in the same direction.

* The curtain must be fully closed or open to enable movement in reverse.

⚠ Caution

⚠ Infra-red Transmitter has orientation as illustrated, therefore be sure to point your transmitter toward the Infra-red Receiver. Maximum distance to reach the radiation from the Transmitter to the Receiver is 10 meter in radiation axis. Please note that when the radiation axis is not directly meeting the Receiver, radiation travels shorter distance.

⚠ If the operation became unstable, please change the batteries.

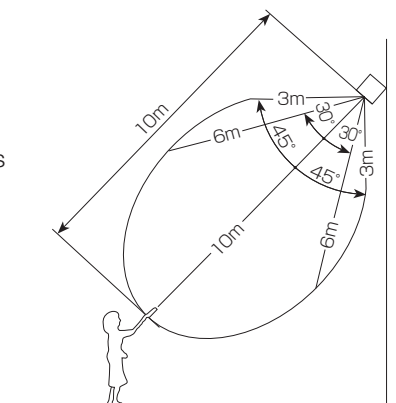

Product Specification

Progress Motor	25	50
Source Voltage	AC 100-240V	
Power Frequency	50/60Hz	
Power consumption	During stand by : 15W or lower , Max . load operation : 86W	
Operation voltage	DC24V	
Operation current	3 mA	
Rated Current	0.59N.m	0.98N.m
Time rating	5 min.(continuous operation)	
Ambient Temperature	0 to 50°C (non-condensing)	

Cleaning

- Whenever necessary, wipe the product with dry, clean, and soft cloth.
- Refrain from directly applying water, thinner or other chemicals to the product. Those materials may cause damages, discoloring, and distortion to the product.

Disposal of Packing Materials

- Do not leave packing material at the installation site.
- Separate combustible cardboard from noncombustible waste.
- Observe the local waster separation regulations when disposing of the materials.