

Supertrac

Solution for diverse range of needs with variety of optional parts. Also features cord draw and motorized operation.



Color Variation

Silver



Aluminum



Reference Quote Ex 3.00m Standard

(Unit: Yen)

Color	Single Wall Attachment	Cord Draw(Ceiling Attachment)
Silver	6,804	10,328
Aluminum	7,474	10,998

Parts List:
Single Wall Attachment: rail 3.00m = 1, Roller= 26 pieces, End Cap =2 pieces, End Stop = 2 pieces, Single Bracket A = 5 pieces (Start with a new line)
Cord Draw (Ceiling Attachment): rail 3.00m =1, Roller=24 pieces, Master Roller= 1 pair, Pulley Set= 1 pair, Ceiling Single Bracket A= 5 pieces, Tension Pulley 250 White= 1 piece (Necessary length of traverse cord needs to be added to the above.)

Part Name	Material	Finish
Rail	Silver	Vinyl chloride resin metal laminate
	Aluminum	Aluminum alloy extrusion material
Roller	Blade	Polyester
	Wheel	Steel
	Oval ring	SUS304
End Cap	Blade	Polyester
	Spring plate	Steel
Bracket	Main body	Aluminum
	Finish plate	Steel

Variety of Optional Components available with Supertrac

Splice

With 3 kinds of Splice

You can install for every circumstance.

Cover Splice



Two rails are securely jointed with Cover Splice.

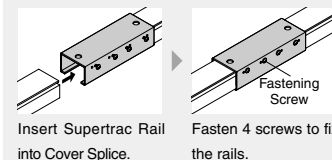

Insert Supertrac Rail into Cover Splice. Fasten 4 screws to fix the rails.

OT Splice

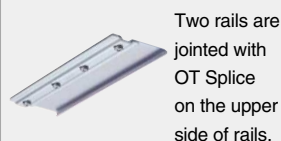

Two rails are jointed with OT Splice on the upper side of rails.

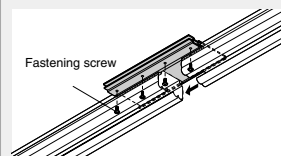

Fastening screw

Splice for Aluminum Rail



Two rails are jointed internally with Joint for Aluminum Rail. *For cord draw and motorized operation, use Cover Splice or OT Splice.

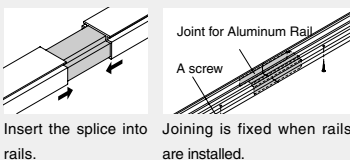

Insert the splice into rails. Joint for Aluminum Rail. A screw. Joining is fixed when rails are installed.

Roller

Functional Swing Rollers for beautiful curtain finish.

Swing Roller with Ring

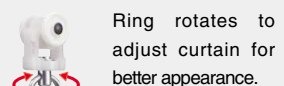

Ring rotates to adjust curtain for better appearance.

Allowable load 3kg

Swing Roller with Hook

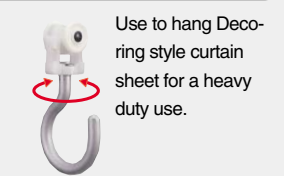

Use to hang Decorating style curtain sheet for a heavy duty use.

Allowable load 3kg

Bracket installation interval and allowable curtain load

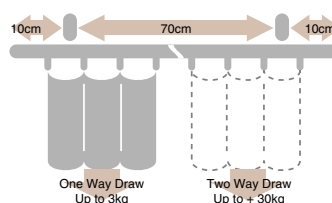

Rail Cross Section (Unit: Yen)

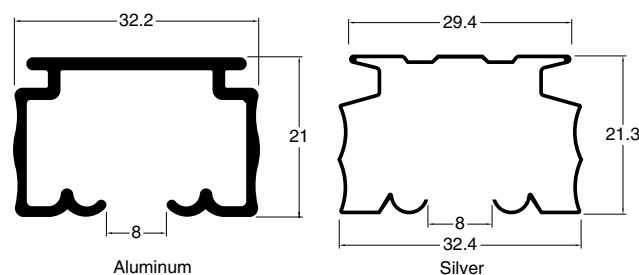

Parts for IV are available.

Roller is designed with automatic lock with weight of an IV bottle and to have high soundproof efficiency.

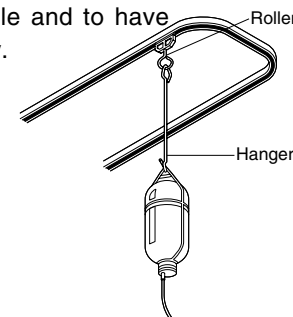

Useful as picture rail.

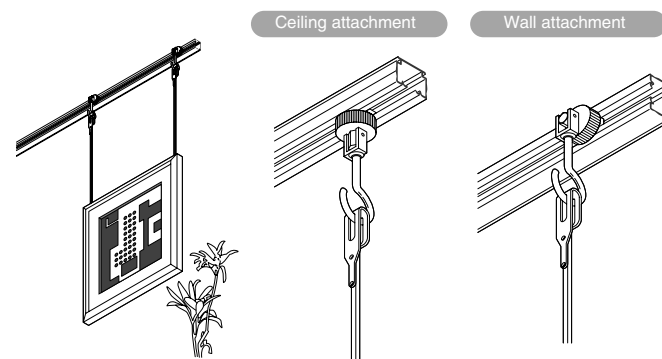

Use Hanger Roller F

Smooth opening and closing with grooves for roller and Traverse Cord.

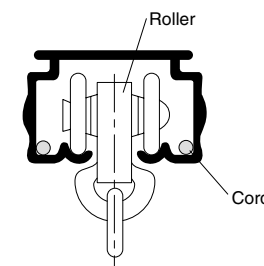

Cord draw parts for Curved, Skylight and Overlap are available.

With variety of components, a standard cord draw as well as unique and specified cord draws can be set without difficulty. Also, three types of Cording Kit are available, depending on your specific needs. *Cording Parts Kit for Curved Rail *Cording Parts Kit for Skylight *Cording Parts Kit for Overlap <Note> Supertrac Rail, Roller, Tension Pulley and installation screws are not included.

For Curved Rail

Cording Parts Kit for Curved Rail

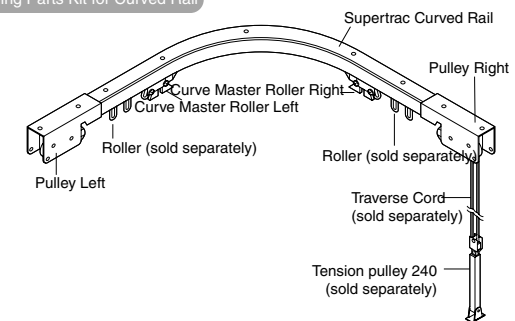

For Skylight

Cording Parts Kit for Skylight

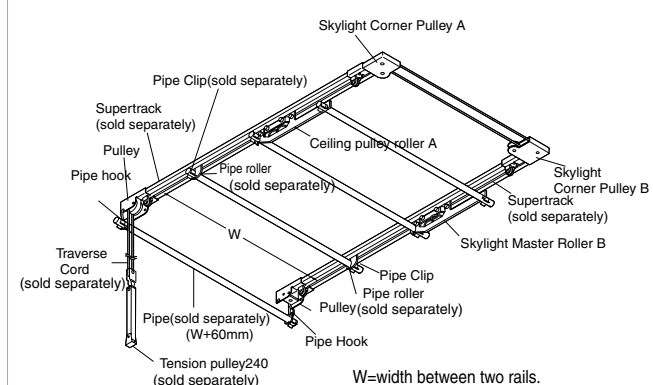

Sewing Method of Curtain for Ceiling

1. French seams to insert pipes should be 20-25mm
2. Intervals between rollers should be equal width over 500mm except for Skylight Master Rollers (240-250mm)
3. Curtain width is same size (Width+60mm) as pipe.

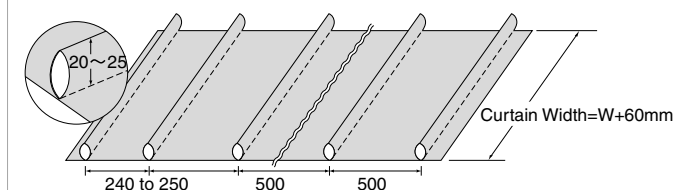

Allows motor operation using curtain motor.

Very convenient for using curtain at high position or location with big interval, and opening or closing heavy curtain.



Skylight curtain with Supertrac and Cording Parts Kit for Skylight

Item No. of Supertrac

Product Name (Size)	Rail		Curve rail (500R)	Custom-made
	3.00m	4.00m	1.00mx1.00m	meter
Color	Item No.	Item No.	Item No.	price
Silver	2,780	3,710	3,140	1,110
Aluminum	3,450	4,610	3,680	1,380

Curve rail 1.00mx1.00m(custom order) is 500mR.
For gradual curve 3,600 Yen is added per meter.

Supertrac Parts Price

Product Name	Item No.	Box Quantity	Box Price
Roller			
Allowable load 3kg	00240011	100 pieces	9,700
OM Roller	00240010		11,000
Swing Roller with Ring	00240059	100 pieces	15,000
Swing Roller with Hook	00240056	20 pieces	11,400
Overlap Master Roller For curved rail over 500mm R	00240006	5 pairs	3,950
Pilot Roller	00240060	1 piece	1,000
Single Bracket A	00240018	20 pieces	4,600
Double Bracket	00240014		10,400
Ceiling Bracket A	00240016	10 pieces	2,400
Overhead Hanger	00240007		850
Wall Bracket	00240013		2,800

Product Name	Item No.	Box Quantity	Box Price
Cap			
End Cap	00240019	20 pieces	1,760
End Stop	00240020		1,760
Pulley	00240005	5 pairs	7,000
Master Roller Right and Left	00240042	1 pair	1,320
Long Master Roller Two pieces are necessary for two-way draw.	00240045	1 piece	830
Cord Draw Parts			
Overlap Installation Kit (1 pair of Overlap Pulley, 2 pieces of Pilot Roller, 2 End Stops, 1 Overlap Bracket, 10 Cord Clips)	00240034	1 set	5,000
Cording Parts Kit for Curved Rail (1 pair of Pulley, 1 pair of Curve Master Roller (Right & Left), Tension Pulley 240).	00240043	1 set	4,100
Cording Parts Kit for Skylight (1 pair of Pulley, 1 pair of Skylight Corner Pulley A & B, Tension Pulley 240, 2 Pipe Hooks)	00240044	1 set	9,900
Skylight Pipe Roller	00240037	1 piece	130

Place an order by the unit of order

Supertrac Parts Price

Product Name	Item No.	Box Quantity	Box Price
Skylight Pipe Clip	00240046	1 piece	90
Tension Pulley 240 (White)	00050005	10 set	13,000
Tension Pulley 450 (silver finish)	00050007	1 set	5,800
Tension Pulley 650 (silver finish)	00050008		6,700
Traverse Cord 3.5mm (White)	00580010	1 (100m)	8,300
Support Pulley A	00500009	1 piece	2,000
Support Pulley B	00500010		
Support Pulley C	00500011		

Installation Dimension(mm)

Ceiling Attachment

Direct attachment (roller used)

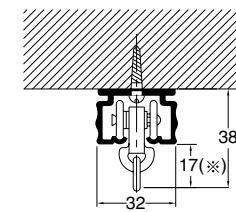

Direct attachment (Swing Roller W/Ring used)

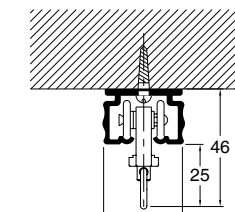

Direct attachment (Swing Roller W/Hook used)

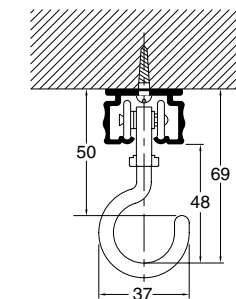

Ceiling single bracket (bracket width=46mm) (roller used)

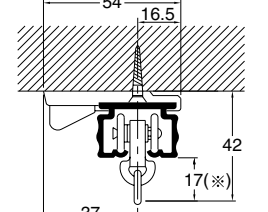

Wall Attachment

Single Bracket A (bracket width=20mm) (roller used)

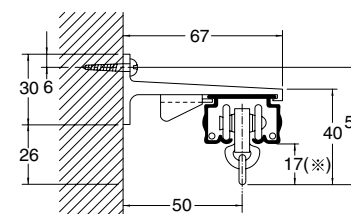

Double Bracket (bracket width=24mm) (roller used)

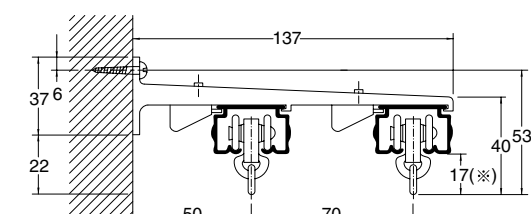

23mm if OM roller is used.

The price does not include consumption tax and installation fee.