

Cord type

Padina Twin type

Maximum fabric weight 5kg
(including the front & back fabric and sewing parts)

Custom-made



Roman Shade operated with cord.



Operated on one side



Operated on both sides

Corresponding style

Plain (Front) + Plain (Back)	Plain	Sharp	Balloon	Bay Window Balloon	Austrian
Yes	No	No	No	No	No

Number of brackets

Unit: Pieces

Product	300to 600	610to 1,200	1,210to 1,800	1,810to 2,400
Cart	2	3	4	5

Color of cord and cord stop



For custom-made shade, cord and cord stop color can be specified from left 4 colors. If not specified, and for Standard Kit, white cord and cord stop are applied.

Product {KIT} Price

Dimension indicated (Height and Width) are in units of 10mm. (Price in Yen)

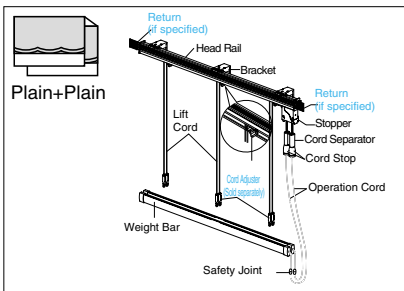

Ready-made

Plain + Plain style(Operated on one side)

Productwidth(AimmA)	900	1,400	1,900	2,400
	Product height(imm)	2swags	3swags	4swags
3,000	11,000	13,000	15,000	17,000

Custom-made

Plain + Plain style(Operated on one side)

Productwidth(AimmA)	300-500	510-900	910-1,400	1,410-1,900	1,910-2,400
	Product height(imm)	1swags	2swags	3swags	4swags
480 - 3,000	12,400	14,800	17,200	19,600	

*Price is same for with or without Return.

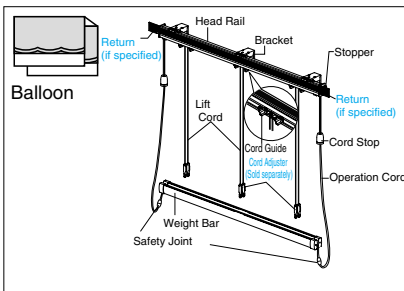

Custom-made

Plain +Plain (Operated on both sides)

Product height(imm)	300-500	510-900	910-1,400	1,410-1,900	1,910-2,400
	Product height(imm)	1swags	2swags	3swags	4swags
480 - 3,000	12,400	14,800	17,200	19,600	

*Price is same for with or without Return.

Drawing and Computing Formula for Folded Shade Dimension

in mm

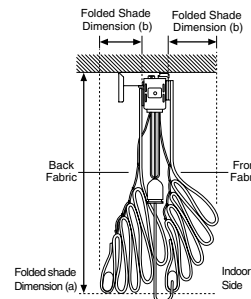

Style	Productheight	Folded Shade Dimension (a)	Folded Shade Dimension (b)
Plain	H	190 + H/40	80

Dimension calculated is for reference only.

*Cord Adjusters are not included in a product. Please purchase them separately.

Bracket

Front attachment Bracket
(common use for Front and Ceiling attachment)

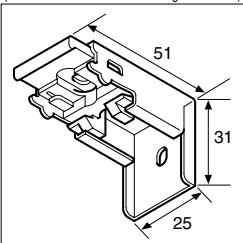

Ceiling attachment bracket

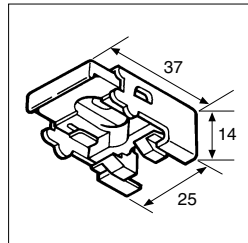

Installation dimensions & Drawing

Front attachment
(use Front attachment bracket)

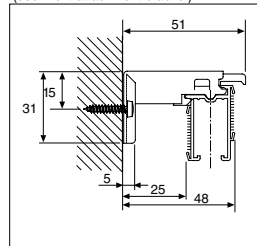

Ceiling attachment
(use Front attachment bracket)

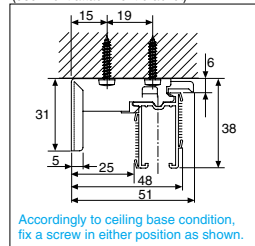

Accordingly to ceiling base condition, fix a screw in either position as shown.

Ceiling attachment
(use the ceiling attachment bracket)

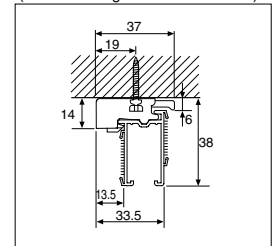

in mm